

NOTICE!!

These documents have been scanned!

Do not place un-scanned documents beneath this notice!

Do not remove this notice from this file!

GPO Jacket No. 560-102
Print Order 61540
Rise Business Services, LLC
Job=AZ15 7/3/2019



Box Number= AZ15141



Claim Begin-End: AMC351224-AMC351232

1 Initial Receipt



AZ15141-3 AMC351149-AMC351598

CLAIM INDEX

DATE PREPARED: June 24, 1999

LEAD AMC NUMBER: AMC 351224
THRU
ENDING AMC NUMBER: AMC 351232

<u>AMC NUMBER</u>	<u>*CLOSURE DECISION</u>	<u>CLAIM NAME</u>	<u>LOCATORS OF RECORD</u>
AMC 351224		DIABLO NO 1	MANHATTAN RESOURCES
AMC 351225		DIABLO NO 2	" "
AMC 351226		DIABLO NO 3	" "
AMC 351227		DIABLO NO 4	" "
AMC 351228		DIABLO NO 5	" "
AMC 351229		DIABLO NO 6	" "
AMC 351230		DIABLO NO 7	" "
AMC 351231		DIABLO NO 8	" "
AMC 351232		DIABLO NO 9	" "

*FOR BLM PURPOSES ONLY

UNITED STATES
DEPARTMENT OF THE INTERIOR
BUREAU OF LAND MANAGEMENT

RECEIPT AND ACCOUNTING ADVICE

NO. 2480022 04

*Rec'd
2/5/99*

RS/AZ 02/03/99
2 3 11 90.00
2 3 12 225.00
2 3 13 900.00

Subject: LOCATION & SERVICE FEE (9)
Applicant: CLAIM MAINTENANCE FEE (9)
MANHATTAN RESOURCES INC
1256 W CHANDLER BLVD
SUITE 29
CHANDLER AZ 85283

Remitter: CK # 3269 (\$607.50)
C.C. (\$607.50)
(602) 897-9645

Assignor:

5/21/99
ENTERED INTO COMPUTER
2-10-99

LEASE MANAGEMENT DATA NEW UPDATE PAYMENT

ORIGINAL SERIAL NO.	ASG.	TYPE	ST.	CTY.	FUND SYMBOL	ACRES/UNITS	RATE
AMC 351224-351232							

AMOUNT	ANV. DATE	EXP. DATE	BILL CYC.	S/C	DISTRICT	NEXT BILL	MISC. DATA	U of M	ACTUAL UNITS

ASSIGNMENT SERIAL NO.	ASG.	TYPE	ST.	CTY.	FUND SYMBOL	ACRES/UNITS	RATE

AMOUNT	ANV. DATE	EXP. DATE	BILL CYC.	S/C	DISTRICT	NEXT BILL	MISC. DATA	U of M	ACTUAL UNITS

APPLY REMITTANCE			
ACTION	FUND SYMBOL	CTY.	AMOUNT
FILING FEE			
RENTAL			
UNEARNED			
REFUND			
TOTAL			
AMOUNT DUE			

Remarks:

BY: _____ DATE: _____

Lease in Escrow?
 KGS? Of Interest?
 Auto Escalates? Operating Rights?
 Auto Renew? Operator
 Bond Filed?

FOR MMS USE ONLY

BILLEE	FOREST REFUGE
NUMBER	
OCS SECTION	
CODE	

UNITED STATES
DEPARTMENT OF THE INTERIOR
BUREAU OF LAND MANAGEMENT

RECEIPT AND ACCOUNTING ADVICE

NO. 2480022 04

*Rec'd
2/15/99*

RS/AZ 02/03/99

Subject: LOCATION & SERVICE FEE (9) 2 3 11 90.00
 Applicant: CLAIM MAINTENANCE FEE (9) 2 3 12 225.00
 2 3 13 900.00

MANHATTAN RESOURCES INC
1256 W CHANDLER BLVD
SUITE 29
CHANDLER AZ 85283

Remitter: CK # 3269 (\$607.50)
C.C. (\$607.50)
(602) 897-9645

5/21/99

Assignor:

2-10-99

LEASE MANAGEMENT DATA NEW UPDATE PAYMENT

ORIGINAL SERIAL NO.	ASG.	TYPE	ST.	CTY.	FUND SYMBOL	ACRES/UNITS	RATE
AMC 351224-351232							

AMOUNT	ANV. DATE	EXP. DATE	BILL CYC.	S/C	DISTRICT	NEXT BILL	MISC. DATA	U of M	ACTUAL UNITS

ASSIGNMENT SERIAL NO.	ASG.	TYPE	ST.	CTY.	FUND SYMBOL	ACRES/UNITS	RATE

AMOUNT	ANV. DATE	EXP. DATE	BILL CYC.	S/C	DISTRICT	NEXT BILL	MISC. DATA	U of M	ACTUAL UNITS

APPLY REMITTANCE

ACTION	FUND SYMBOL	CTY.	AMOUNT
FILING FEE			
RENTAL			
UNEARNED			
REFUND			
TOTAL			
AMOUNT DUE			

Remarks:

BY:

DATE:

Lease in Escrow?
 KGS?
 Auto Escalates?
 Auto Renew?

Of Interest?
 Operating Rights?
 Operator
 Bond Filed?

FOR MMS USE ONLY

BILLEE	FOREST REFUGE
NUMBER	
OCS SECTION	
CODE	

NOTICE!!

These documents have been scanned!

Do not place un-scanned documents beneath this notice!

Do not remove this notice from this file!

GPO Jacket No. 560-102
Print Order 61540
Rise Business Services, LLC
Job=AZ15 7/3/2019



Box Number= AZ15141



Claim Begin-End: AMC351224-AMC351232

2 Correspondence



AZ15141-3

AMC351149-AMC351598

**NO
DOCUMENTS
FOUND**

NO DOCUMENTS FOUND
NO DOCUMENTS FOUND

NOTICE!!

These documents have been scanned!

Do not place un-scanned documents beneath this notice!

Do not remove this notice from this file!

GPO Jacket No. 560-102
Print Order 61540
Rise Business Services, LLC
Job=AZ15 7/3/2019



Box Number= AZ15141



Claim Begin-End: AMC351224-AMC351232

3 Transfers



AZ15141-3

AMC351149-AMC351598

When recorded, mail to:

Name: Jack L. Davis
Address: 1256 W. Chandler Blvd. Suite 29
City: Chandler,
State: Arizona Zip Code: 85225

Space above this line for Recorder's Use

QUIT CLAIM DEED

KNOWN ALL MEN BY THESE PRESENTS:

That, MANHATTAN RESOURCES, INC, A NEVADA CORPORATION, HEREBY for the consideration of Ten (10) Dollars, and other valuable considerations, do hereby release, remise, and forever QUITCLAIM unto:

GOLDEN PRECIOUS METAL, INC, A NEVADA CORPORATION

all right and title and interest in that certain Property situated in SANTA CRUZ County, State of Arizona and described as follows:

Nine (9) Diablo Mining Claims located in Section 5 & 6 Township 21 South, Range 12 East of the Gila & Salt River Base and Meridian, located in Santa Cruz County, Arizona. The

B.L. M. Numbers are: 351224 - 35.1 232

IN WITNESS WHEREOF, I (we) have hereunto set my (our) hand (s) and seal this 23rd day of May 2007.

RECEIVED
B.L.M. AZ STATE OFFICE
2007 MAY 24 A 11:40
PHOENIX, ARIZONA

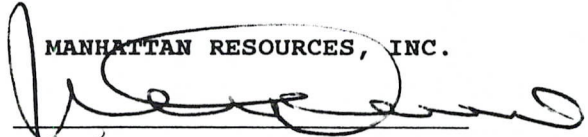
MANHATTAN RESOURCES, INC.

JACK L. DAVIS, PRESIDENT

LOUIS E. McMAHAN, SECRETARY



State of Arizona)
County of Maricopa)

SS **ACKNOWLEDGMENT**

On this 23 day of May, 2007, before me the undersigned Notary Public personally appeared JACK L. DAVIS AND LOUIS E. McMAHAN known to me to be the individual(s) who executed the foregoing instrument and acknowledged the same to be their free act and deed.

My Commission Expires: MARCH 8, 2011

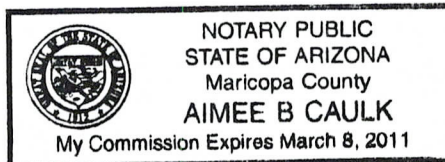
Aimee B Caulk
Notary



ENTERED INTO COMPUTER

7/19/07 AB

United States Department of the Interior

Bureau of Land Management

BUSINESS & SUPPORT SVCS DIV

ONE N CENTRAL AVE SUITE 800

PHOENIX, AZ 85004 -4427

Phone: (602) 417-9200

Receipt

No:

1496590

Transaction #: 1546680	
Date of Transaction: 05/24/2007	
CUSTOMER:	JACK DAVIS 1256 W CHANDLER BLVD SUITE 29 CHANDLER, AZ 85225

LINE #	QTY	DESCRIPTION	REMARKS	UNIT PRICE	TOTAL
1	1.00	LOCATABLE MINERALS / MINING CLAIMS-NOT NEW-UNADJUD, ONE AUTH NO. ONLY / MINING CLAIM MONEY RECEIVED (455) CASES: AMC31512/\$280.00	TRF (28)	- n/a -	280.00
TOTAL:					\$280.00

PAYMENT INFORMATION			
NOTE: Items will appear on credit card statement as "Bureau of Land Management".			
1	AMOUNT:	\$280.00	POSTMARKED: N/A
	TYPE:	CREDIT CARD	RECEIVED: 05/24/2007
	NAME:	DAVIS, JACK 1256 W CHANDLER BLVD SUITE 29 CHANDLER AZ 85225	
	CARD NO:	XXXXXXXXXXXX6261	AUTH CODE: 353742
	NAME ON CARD:	JACK L DAVIS	
	EXPIRES:	07/31/2010	
	SIGNATURE:		

REMARKS

This receipt was generated by the automated BLM Collections and Billing System and is a paper representation of a portion of the official electronic record contained therein.

When recorded, mail to:
Name: Jack L. Davis / Golden Precious Metal Inc.
Address: 1256 W. Chandler Blvd. Suite 29
City: Chandler,
State: Arizona Zip Code: 85225

31512
AMC ~~31512~~
AMC 344010
AMC 351224

Space above this line for Recorder's Use

QUIT CLAIM DEED

KNOWN ALL MEN BY THESE PRESENTS:

That, MANHATTAN RESOURCES, INC, A NEVADA CORPORATION, HEREBY for the consideration of Ten (10) Dollars, and other valuable considerations, do hereby release, remise, and forever QUITCLAIM unto:



GOLDEN PRECIOUS METAL, INC, A NEVADA CORPORATION

all right and title and interest in that certain Property situated in MARICOPA County, State of Arizona and described as follows:

Nineteen (19) Golden Hillside Lode Mining Claims are located in Maricopa County, State of Arizona, Superstition Mining District, Sections, 25, 26, 35, and 36 Township 2N, Range 8E; Salt River Base and Meridian, Bureau of Land Management Serial Numbers: AMC 31512, 31513, 31514, 31515, 31516, 344010, 344011, 344012, 344013, 344014, 344015, 344016, 344017, 344018, 344019, 344020, 344021, 344022, & 344023.

IN WITNESS WHEREOF, I (we) have hereunto set my (our) hand (s) and seal this 23rd day of May 2007.

RECEIVED
B.L.M. AZ STATE OFFICE
2007 MAY 24 A 11:40
PHOENIX, ARIZONA

MANHATTAN RESOURCES, INC.

JACK L. DAVIS, PRESIDENT

LOUIS E. McMAHAN, SECRETARY

State of Arizona)
County of Maricopa)

ACKNOWLEDGMENT

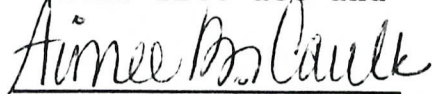
On this 23rd day of May, 2007, before me the undersigned Notary Public personally appeared JACK L. DAVIS AND LOUIS E. McMAHAN known to me to be the individual(s) who executed the foregoing instrument and acknowledged the same to be their free act and deed.

My Commission Expires: MARCH 8, 2011

Notary

ENTERED INTO COMPUTER
7/19/07 ab

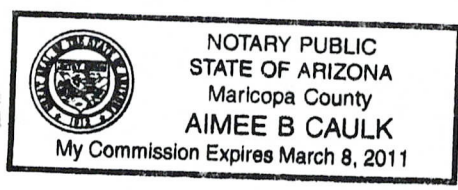

NOTICE!!

These documents have been scanned!

Do not place un-scanned documents beneath this notice!

Do not remove this notice from this file!

GPO Jacket No. 560-102
Print Order 61540
Rise Business Services, LLC
Job=AZ15 7/3/2019



Box Number= AZ15141



Claim Begin-End: AMC351224-AMC351232

4 Annual Filings



AZ15141-3 AMC351149-AMC351598

**DEPARTMENT OF THE INTERIOR
BUREAU OF LAND MANAGEMENT
MINING CLAIMS**

Run Date/Time: 8/21/2019

**MC Maintenance Fees Paid Through the BLM Pay Portal
(by Date Paid)**

Page 51 Of 184

CBS Receipt: 4535573

Printed For Lead File # AMC351224

Agency Tracking ID: 1565976061

Assessment Year: 2020

Number of BLM Serial Nr: 28

Paid On: 8/16/2019

Total Amount Paid: \$4,620.00

Claim Name	BLM Serial No	Lead File No	Amount Paid
GOLDEN HILLSIDE	AMC31512	AMC31512	\$165.00
GOLDEN HILLSIDE NO 2	AMC31513	AMC31512	\$165.00
GOLDEN HILLSIDE NO 3	AMC31514	AMC31512	\$165.00
GOLDEN HILLSIDE NO 4	AMC31515	AMC31512	\$165.00
GOLDEN HILLSIDE NO 5	AMC31516	AMC31512	\$165.00
GOLDEN HILLSIDE NO 6	AMC344010	AMC344010	\$165.00
GOLDEN HILLSIDE NO 7	AMC344011	AMC344010	\$165.00
GOLDEN HILLSIDE NO 8	AMC344012	AMC344010	\$165.00
GOLDEN HILLSIDE NO 9	AMC344013	AMC344010	\$165.00
GOLDEN HILLSIDE NO10	AMC344014	AMC344010	\$165.00
GOLDEN HILLSIDE NO11	AMC344015	AMC344010	\$165.00
GOLDEN HILLSIDE NO12	AMC344016	AMC344010	\$165.00
GOLDEN HILLSIDE 13-A	AMC344017	AMC344010	\$165.00
GOLDEN HILLSIDE NO14	AMC344018	AMC344010	\$165.00
GOLDEN HILLSIDE NO15	AMC344019	AMC344010	\$165.00
GOLDEN HILLSIDE NO16	AMC344020	AMC344010	\$165.00
GOLDEN HILLSIDE NO23	AMC344021	AMC344010	\$165.00
GOLDEN HILLSIDE NO24	AMC344022	AMC344010	\$165.00
GOLDEN HILLSIDE NO25	AMC344023	AMC344010	\$165.00
DIABLO NO 1	AMC351224	AMC351224	\$165.00
DIABLO NO 2	AMC351225	AMC351224	\$165.00
DIABLO NO 3	AMC351226	AMC351224	\$165.00
DIABLO NO 4	AMC351227	AMC351224	\$165.00
DIABLO NO 5	AMC351228	AMC351224	\$165.00

NO WARRANTY IS MADE BY BLM FOR USE OF THE DATA FOR PURPOSES NOT INTENDED BY BLM

DEPARTMENT OF THE INTERIOR
BUREAU OF LAND MANAGEMENT
MINING CLAIMS

Run Date/Time: 8/21/2019

MC Maintenance Fees Paid Through the BLM Pay Portal
(by Date Paid)

Page 52 Of 184

DIABLO NO 6	AMC351229	AMC351224	\$165.00
DIABLO NO 7	AMC351230	AMC351224	\$165.00
DIABLO NO 8	AMC351231	AMC351224	\$165.00
DIABLO NO 9	AMC351232	AMC351224	\$165.00

United States Department of the Interior
Bureau of Land Management
 BUSINESS & SUPPORT SVCS DIV
 ONE N CENTRAL AVE SUITE 800
 PHOENIX, AZ 85004 -4427
 Phone: 602-417-9200

Receipt	
No:	4535573

Transaction #: 4656479	
Date of Transaction: 08/16/2019	
CUSTOMER:	
	GPM ENTERPRISES, LTD NOT APPLICABLE DENVER,CO 80225 US

LINE #	QTY	DESCRIPTION	REMARKS	UNIT PRICE	TOTAL
1	1.00	LOCATABLE MINERALS / MINING CLAIMS- NOT NEW-UNADJUD,ONE AUTH NO. ONLY / MINING CLAIM MONEY RECEIVED CASES: AMC31512/\$4620.00		- n/a -	4620.00
TOTAL:					\$4,620.00

PAYMENT INFORMATION			
1	AMOUNT:	4620.00	POSTMARKED: N/A
	TYPE:	EFT	RECEIVED: 08/16/2019
	NAME:	GPM ENTERPRISES, LTD NOT APPLICABLE DENVER CO 80225 US	

REMARKS

This receipt was generated by the automated BLM Collections and Billing System and is a paper representation of a portion of the official electronic record contained therein.

DEPARTMENT OF THE INTERIOR
BUREAU OF LAND MANAGEMENT
MINING CLAIMS

Run Date/Time: 9/11/2018

MC Maintenance Fees Paid Through the BLM Pay Portal
(by Date Paid)

Page 156 Of 723

CBS Receipt: 4243242

Printed For Lead File # AMC351224

Agency Tracking ID: 1535035001

Assessment Year: 2019

Paid On: 8/23/2018

Number of BLM Serial Nr: 28

Total Amount Paid: \$4,340.00

Claim Name	BLM Serial No	Lead File No	Amount Paid
GOLDEN HILLSIDE	AMC31512	AMC31512	\$155.00
GOLDEN HILLSIDE NO 2	AMC31513	AMC31512	\$155.00
GOLDEN HILLSIDE NO 3	AMC31514	AMC31512	\$155.00
GOLDEN HILLSIDE NO 4	AMC31515	AMC31512	\$155.00
GOLDEN HILLSIDE NO 5	AMC31516	AMC31512	\$155.00
GOLDEN HILLSIDE NO 6	AMC344010	AMC344010	\$155.00
GOLDEN HILLSIDE NO 7	AMC344011	AMC344010	\$155.00
GOLDEN HILLSIDE NO 8	AMC344012	AMC344010	\$155.00
GOLDEN HILLSIDE NO 9	AMC344013	AMC344010	\$155.00
GOLDEN HILLSIDE NO10	AMC344014	AMC344010	\$155.00
GOLDEN HILLSIDE NO11	AMC344015	AMC344010	\$155.00
GOLDEN HILLSIDE NO12	AMC344016	AMC344010	\$155.00
GOLDEN HILLSIDE 13-A	AMC344017	AMC344010	\$155.00
GOLDEN HILLSIDE NO14	AMC344018	AMC344010	\$155.00
GOLDEN HILLSIDE NO15	AMC344019	AMC344010	\$155.00
GOLDEN HILLSIDE NO16	AMC344020	AMC344010	\$155.00
GOLDEN HILLSIDE NO23	AMC344021	AMC344010	\$155.00
GOLDEN HILLSIDE NO24	AMC344022	AMC344010	\$155.00
GOLDEN HILLSIDE NO25	AMC344023	AMC344010	\$155.00
DIABLO NO 1	AMC351224	AMC351224	\$155.00
DIABLO NO 2	AMC351225	AMC351224	\$155.00
DIABLO NO 3	AMC351226	AMC351224	\$155.00
DIABLO NO 4	AMC351227	AMC351224	\$155.00
DIABLO NO 5	AMC351228	AMC351224	\$155.00

NO WARRANTY IS MADE BY BLM FOR USE OF THE DATA FOR PURPOSES NOT INTENDED BY BLM

DEPARTMENT OF THE INTERIOR
BUREAU OF LAND MANAGEMENT
MINING CLAIMS

Run Date/Time: 9/11/2018

MC Maintenance Fees Paid Through the BLM Pay Portal
(by Date Paid)

Page 157 Of 723

DIABLO NO 6	AMC351229	AMC351224	\$155.00
DIABLO NO 7	AMC351230	AMC351224	\$155.00
DIABLO NO 8	AMC351231	AMC351224	\$155.00
DIABLO NO 9	AMC351232	AMC351224	\$155.00

United States Department of the Interior
Bureau of Land Management
 BUSINESS & SUPPORT SVCS DIV
 ONE N CENTRAL AVE SUITE 800
 PHOENIX, AZ 85004 -4427
 Phone: 602-417-9200

Receipt

No: 4243242

Transaction #: 4358676	
Date of Transaction: 08/23/2018	
CUSTOMER:	
WILMA JONES 9335 E WEBB RD MOUNT VERNON,IL 62864 US	

LINE #	QTY	DESCRIPTION	REMARKS	UNIT PRICE	TOTAL
1	1.00	LOCATABLE MINERALS / MINING CLAIMS- NOT NEW-UNADJUD,ONE AUTH NO. ONLY / MINING CLAIM MONEY RECEIVED CASES: AMC31512/\$4340.00		- n/a -	4340.00
TOTAL:					\$4,340.00

PAYMENT INFORMATION			
NOTE: Items will appear on credit card statement as "BLM O Mining Claim".			
1	AMOUNT:	4340.00	POSTMARKED: N/A
	TYPE:	CREDIT CARD	RECEIVED: 08/23/2018
	NAME:	WILMA JONES 9335 E WEBB RD MOUNT VERNON IL 62864 US	
	CARD NO:	XXXXXXXXXXXX4718	AUTH CODE: 04136C
	NAME ON CARD:	WILMA JONES	
	SIGNATURE:		

REMARKS

This receipt was generated by the automated BLM Collections and Billing System and is a paper representation of a portion of the official electronic record contained therein.

**DEPARTMENT OF THE INTERIOR
BUREAU OF LAND MANAGEMENT
MINING CLAIMS**

MC Maintenance Fees Paid Through the BLM Pay Portal

CBS Receipt: 3923200

Printed For Lead File # AMC351224

Agency Tracking ID: 1502044834

Assessment Year: 2018

Number of BLM Serial Nr: 28

Paid On: 08/06/2017

Total Amount Paid: \$4,340.00

Claim Name	BLM Serial No	Lead File No	Amount Paid
GOLDEN HILLSIDE	AMC31512	AMC31512	\$155.00
GOLDEN HILLSIDE NO 2	AMC31513	AMC31512	\$155.00
GOLDEN HILLSIDE NO 3	AMC31514	AMC31512	\$155.00
GOLDEN HILLSIDE NO 4	AMC31515	AMC31512	\$155.00
GOLDEN HILLSIDE NO 5	AMC31516	AMC31512	\$155.00
GOLDEN HILLSIDE NO 6	AMC344010	AMC344010	\$155.00
GOLDEN HILLSIDE NO 7	AMC344011	AMC344010	\$155.00
GOLDEN HILLSIDE NO 8	AMC344012	AMC344010	\$155.00
GOLDEN HILLSIDE NO 9	AMC344013	AMC344010	\$155.00
GOLDEN HILLSIDE NO10	AMC344014	AMC344010	\$155.00
GOLDEN HILLSIDE NO11	AMC344015	AMC344010	\$155.00
GOLDEN HILLSIDE NO12	AMC344016	AMC344010	\$155.00
GOLDEN HILLSIDE 13-A	AMC344017	AMC344010	\$155.00
GOLDEN HILLSIDE NO14	AMC344018	AMC344010	\$155.00
GOLDEN HILLSIDE NO15	AMC344019	AMC344010	\$155.00
GOLDEN HILLSIDE NO16	AMC344020	AMC344010	\$155.00
GOLDEN HILLSIDE NO23	AMC344021	AMC344010	\$155.00
GOLDEN HILLSIDE NO24	AMC344022	AMC344010	\$155.00
GOLDEN HILLSIDE NO25	AMC344023	AMC344010	\$155.00
DIABLO NO 1	AMC351224	AMC351224	\$155.00
DIABLO NO 2	AMC351225	AMC351224	\$155.00
DIABLO NO 3	AMC351226	AMC351224	\$155.00
DIABLO NO 4	AMC351227	AMC351224	\$155.00
DIABLO NO 5	AMC351228	AMC351224	\$155.00
DIABLO NO 6	AMC351229	AMC351224	\$155.00
DIABLO NO 7	AMC351230	AMC351224	\$155.00
DIABLO NO 8	AMC351231	AMC351224	\$155.00
DIABLO NO 9	AMC351232	AMC351224	\$155.00

**United States Department of the Interior
Bureau of Land Management
BUSINESS & SUPPORT SVCS DIV
ONE N CENTRAL AVE SUITE 800
PHOENIX, AZ 85004 -4427
Phone: 602-417-9200**

Receipt

No: 3923200

Transaction #: 4032713	
Date of Transaction: 08/06/2017	
CUSTOMER:	
WILMA (MCMAHAN) JONES 9335 E WEBB RD MOUNT VERNON,IL 62864 US	

LINE #	QTY	DESCRIPTION	REMARKS	UNIT PRICE	TOTAL
1	1.00	LOCATABLE MINERALS / MINING CLAIMS- NOT NEW-UNADJUD,ONE AUTH NO. ONLY / MINING CLAIM MONEY RECEIVED CASES: AMC31516/\$4340.00		- n/a -	4340.00
TOTAL:					\$4,340.00

PAYMENT INFORMATION			
NOTE: Items will appear on credit card statement as "BLM O Mining Claim".			
1	AMOUNT:	4340.00	POSTMARKED: N/A
	TYPE:	CREDIT CARD	RECEIVED: 08/06/2017
	NAME:	WILMA (MCMAHAN) JONES 9335 E WEBB RD MOUNT VERNON IL 62864 US	
	CARD NO:	XXXXXXXXXXXX5859	AUTH CODE: T5588Z
	NAME ON CARD:	WILMA (MCMAHAN) JONES	
	EXPIRES:	04/2019	
	SIGNATURE:		

REMARKS

This receipt was generated by the automated BLM Collections and Billing System and is a paper representation of a portion of the official electronic record contained therein.

**DEPARTMENT OF THE INTERIOR
BUREAU OF LAND MANAGEMENT
MINING CLAIMS**

MC Maintenance Fees Paid Through the BLM Pay Portal

CBS Receipt: 3646077Printed For Lead File # **AMC351224**

Agency Tracking ID: 1472499795

Number of BLM Serial Nr: 28

Assessment Year: 2017

Paid On: 08/29/2016

Total Amount Paid: \$4,340.00

Claim Name	BLM Serial No	Lead File No	Amount Paid
GOLDEN HILLSIDE	AMC31512	AMC31512	\$155.00
GOLDEN HILLSIDE NO 2	AMC31513	AMC31512	\$155.00
GOLDEN HILLSIDE NO 3	AMC31514	AMC31512	\$155.00
GOLDEN HILLSIDE NO 4	AMC31515	AMC31512	\$155.00
GOLDEN HILLSIDE NO 5	AMC31516	AMC31512	\$155.00
GOLDEN HILLSIDE NO 6	AMC344010	AMC344010	\$155.00
GOLDEN HILLSIDE NO 7	AMC344011	AMC344010	\$155.00
GOLDEN HILLSIDE NO 8	AMC344012	AMC344010	\$155.00
GOLDEN HILLSIDE NO 9	AMC344013	AMC344010	\$155.00
GOLDEN HILLSIDE NO10	AMC344014	AMC344010	\$155.00
GOLDEN HILLSIDE NO11	AMC344015	AMC344010	\$155.00
GOLDEN HILLSIDE NO12	AMC344016	AMC344010	\$155.00
GOLDEN HILLSIDE 13-A	AMC344017	AMC344010	\$155.00
GOLDEN HILLSIDE NO14	AMC344018	AMC344010	\$155.00
GOLDEN HILLSIDE NO15	AMC344019	AMC344010	\$155.00
GOLDEN HILLSIDE NO16	AMC344020	AMC344010	\$155.00
GOLDEN HILLSIDE NO23	AMC344021	AMC344010	\$155.00
GOLDEN HILLSIDE NO24	AMC344022	AMC344010	\$155.00
GOLDEN HILLSIDE NO25	AMC344023	AMC344010	\$155.00
DIABLO NO 1	AMC351224	AMC351224	\$155.00
DIABLO NO 2	AMC351225	AMC351224	\$155.00
DIABLO NO 3	AMC351226	AMC351224	\$155.00
DIABLO NO 4	AMC351227	AMC351224	\$155.00
DIABLO NO 5	AMC351228	AMC351224	\$155.00
DIABLO NO 6	AMC351229	AMC351224	\$155.00
DIABLO NO 7	AMC351230	AMC351224	\$155.00
DIABLO NO 8	AMC351231	AMC351224	\$155.00
DIABLO NO 9	AMC351232	AMC351224	\$155.00

United States Department of the Interior
Bureau of Land Management
 BUSINESS & SUPPORT SVCS DIV
 ONE N CENTRAL AVE SUITE 800
 PHOENIX, AZ 85004 -4427
 Phone: (602) 417-9200

Receipt

No: 3646077

Transaction #: 3750058	
Date of Transaction: 08/29/2016	
CUSTOMER:	
	WILMA JONES 9335 E. WEBB RD MT. VERNON,IL 62864 US

LINE #	QTY	DESCRIPTION	REMARKS	UNIT PRICE	TOTAL
1	1.00	LOCATABLE MINERALS / MINING CLAIMS- NOT NEW-UNADJUD,ONE AUTH NO. ONLY / MINING CLAIM MONEY RECEIVED CASES: AMC31516/\$4340.00		- n/a -	4340.00
TOTAL:					\$4,340.00

PAYMENT INFORMATION			
NOTE: Items will appear on credit card statement as "BLM O Mining Claim".			
1	AMOUNT:	4340.00	POSTMARKED: N/A
	TYPE:	CREDIT CARD	RECEIVED: 08/29/2016
	NAME:	WILMA JONES 9335 E. WEBB RD MT. VERNON IL 62864 US	
	CARD NO:	XXXXXXXXXXXX5859	AUTH CODE: T2965Z
	NAME ON CARD:	WILMA JONES	
	EXPIRES:	04/2019	
	SIGNATURE:		

REMARKS

This receipt was generated by the automated BLM Collections and Billing System and is a paper representation of a portion of the official electronic record contained therein.

Run Date: 08/17/15

Run Time: 02:46 PM

**DEPARTMENT OF THE INTERIOR
BUREAU OF LAND MANAGEMENT
MINING CLAIMS**

MC Maintenance Fees Paid Through the BLM Pay Portal

CBS Receipt: 3363624

Printed For Lead File # AMC351224

Agency Tracking ID: 1439223620

Assessment Year: 2016

Number of BLM Serial Nr: 28

Paid On: 08/10/2015

Total Amount Paid: \$4,340.00

Claim Name	BLM Serial No	Lead File No	Amount Paid
GOLDEN HILLSIDE	AMC31512	AMC31512	\$155.00
GOLDEN HILLSIDE NO 2	AMC31513	AMC31512	\$155.00
GOLDEN HILLSIDE NO 3	AMC31514	AMC31512	\$155.00
GOLDEN HILLSIDE NO 4	AMC31515	AMC31512	\$155.00
GOLDEN HILLSIDE NO 5	AMC31516	AMC31512	\$155.00
GOLDEN HILLSIDE NO 6	AMC344010	AMC344010	\$155.00
GOLDEN HILLSIDE NO 7	AMC344011	AMC344010	\$155.00
GOLDEN HILLSIDE NO 8	AMC344012	AMC344010	\$155.00
GOLDEN HILLSIDE NO 9	AMC344013	AMC344010	\$155.00
GOLDEN HILLSIDE NO10	AMC344014	AMC344010	\$155.00
GOLDEN HILLSIDE NO11	AMC344015	AMC344010	\$155.00
GOLDEN HILLSIDE NO12	AMC344016	AMC344010	\$155.00
GOLDEN HILLSIDE 13-A	AMC344017	AMC344010	\$155.00
GOLDEN HILLSIDE NO14	AMC344018	AMC344010	\$155.00
GOLDEN HILLSIDE NO15	AMC344019	AMC344010	\$155.00
GOLDEN HILLSIDE NO16	AMC344020	AMC344010	\$155.00
GOLDEN HILLSIDE NO23	AMC344021	AMC344010	\$155.00
GOLDEN HILLSIDE NO24	AMC344022	AMC344010	\$155.00
GOLDEN HILLSIDE NO25	AMC344023	AMC344010	\$155.00
DIABLO NO 1	AMC351224	AMC351224	\$155.00
DIABLO NO 2	AMC351225	AMC351224	\$155.00
DIABLO NO 3	AMC351226	AMC351224	\$155.00
DIABLO NO 4	AMC351227	AMC351224	\$155.00
DIABLO NO 5	AMC351228	AMC351224	\$155.00
DIABLO NO 6	AMC351229	AMC351224	\$155.00
DIABLO NO 7	AMC351230	AMC351224	\$155.00
DIABLO NO 8	AMC351231	AMC351224	\$155.00
DIABLO NO 9	AMC351232	AMC351224	\$155.00

NO WARRANTY IS MADE BY BLM FOR USE OF THE DATA FOR PURPOSES NOT INTENDED BY BLM

United States Department of the Interior
Bureau of Land Management
 BUSINESS & SUPPORT SVCS DIV
 ONE N CENTRAL AVE SUITE 800
 PHOENIX, AZ 85004 -4427
 Phone: (602) 417-9200

Receipt

No: 3363624

Transaction #: 3461659	
Date of Transaction: 08/10/2015	
CUSTOMER:	
WILMA J MCMAHAN 17587 N CASEY PIKE LANE MT. VERNON,IL 62864 US	

LINE #	QTY	DESCRIPTION	REMARKS	UNIT PRICE	TOTAL
1	1.00	LOCATABLE MINERALS / MINING CLAIMS- NOT NEW-UNADJUD,ONE AUTH NO. ONLY / MINING CLAIM MONEY RECEIVED CASES: AMC31512/\$4340.00		- n/a -	4340.00
TOTAL:					\$4,340.00

PAYMENT INFORMATION				
NOTE: Items will appear on credit card statement as "BLM O Mining Claim".				
1	AMOUNT:	4340.00	POSTMARKED:	N/A
	TYPE:	CREDIT CARD	RECEIVED:	08/10/2015
	NAME:	WILMA J MCMAHAN 17587 N CASEY PIKE LANE MT. VERNON IL 62864 US		
	CARD NO:	XXXXXXXXXXXX5363	AUTH CODE:	00714C
	NAME ON CARD:	WILMA J MCMAHAN		
	EXPIRES:	07/2017		
	SIGNATURE:			

REMARKS

This receipt was generated by the automated BLM Collections and Billing System and is a paper representation of a portion of the official electronic record contained therein.

Amc 31512
 Amc 344010
 Amc 351224

MAINTENANCE FEE PAYMENT

Claimant Name: Golden Precious Metal Inc.
 Address: 1256 W. Chandler Blvd Ste 29
 City: Chandler State: AZ Zip: 85224-5226
 Telephone: 480-963-3645

E-mail address: _____
 Signature: [Handwritten Signature]

Check here if this is a change of address.

RECEIVED
 BLM AZ STATE OFFICE
 PHOENIX, ARIZONA
 2013 AUG 29 P 12:46
 BLM
 Date
 Stamp

LINE NO.	AMC NUMBER	CLAIM/SITE NAME	COUNTY RECORDER DATA (If available)	TWP	RNG	SEC
1						
2						
3		SEE Attachment				
4						
5						
6						
7						
8						
9						
10						

List additional claims on Form MCF114.

Bureau of Land Management
 Arizona State Office
 www.blm.gov/az/

No. of Claims: 28 x \$140 = 3920
 Check No: 2166 Init. SC
 Receipt No.: 2868937
 For BLM Use Only

Form: MCF112
 Revised July 2009

This form is available from the Arizona Department of Mines and Mineral Resources and may be reproduced.

ENTERED
 SEP 06 2013
 BY: [Handwritten Initials]

DEPARTMENT OF THE INTERIOR
BUREAU OF LAND MANAGEMENT
MINING CLAIMS

Customer Information - WITH Serial No. and Claim Name

ACTIVE CLAIMS

Run Date: 08/16/2012 04:13 PM

Page 1 of 1

Admin State: AZ

Geo State: AZ

GOLDEN PRECIOUS METAL INC

1256 W CHANDLER BLVD STE 29
CHANDLER, AZ 85224-5226

CUSTOMER ID: 2255747

<u>Serial No.</u>	<u>Claim Name/Number</u>	<u>Lead Serial No.</u>	<u>Disposition</u>
AMC31512	GOLDEN HILLSIDE	AMC31512	ACTIVE
AMC31513	GOLDEN HILLSIDE NO 2	AMC31512	ACTIVE
AMC31514	GOLDEN HILLSIDE NO 3	AMC31512	ACTIVE
AMC31515	GOLDEN HILLSIDE NO 4	AMC31512	ACTIVE
AMC31516	GOLDEN HILLSIDE NO 5	AMC31512	ACTIVE
AMC344010	GOLDEN HILLSIDE NO 6	AMC344010	ACTIVE
AMC344011	GOLDEN HILLSIDE NO 7	AMC344010	ACTIVE
AMC344012	GOLDEN HILLSIDE NO 8	AMC344010	ACTIVE
AMC344013	GOLDEN HILLSIDE NO 9	AMC344010	ACTIVE
AMC344014	GOLDEN HILLSIDE NO10	AMC344010	ACTIVE
AMC344015	GOLDEN HILLSIDE NO11	AMC344010	ACTIVE
AMC344016	GOLDEN HILLSIDE NO12	AMC344010	ACTIVE
AMC344017	GOLDEN HILLSIDE 13-A	AMC344010	ACTIVE
AMC344018	GOLDEN HILLSIDE NO14	AMC344010	ACTIVE
AMC344019	GOLDEN HILLSIDE NO15	AMC344010	ACTIVE
AMC344020	GOLDEN HILLSIDE NO16	AMC344010	ACTIVE
AMC344021	GOLDEN HILLSIDE NO23	AMC344010	ACTIVE
AMC344022	GOLDEN HILLSIDE NO24	AMC344010	ACTIVE
AMC344023	GOLDEN HILLSIDE NO25	AMC344010	ACTIVE
AMC351224	DIABLO NO 1	AMC351224	ACTIVE
AMC351225	DIABLO NO 2	AMC351224	ACTIVE
AMC351226	DIABLO NO 3	AMC351224	ACTIVE
AMC351227	DIABLO NO 4	AMC351224	ACTIVE
AMC351228	DIABLO NO 5	AMC351224	ACTIVE
AMC351229	DIABLO NO 6	AMC351224	ACTIVE
AMC351230	DIABLO NO 7	AMC351224	ACTIVE
AMC351231	DIABLO NO 8	AMC351224	ACTIVE
AMC351232	DIABLO NO 9	AMC351224	ACTIVE

Number of ACTIVE cases: 28

50

RECEIVED
BLM STATE OFFICE
PHOENIX, ARIZONA
2012 AUG 29 P 12:49

NO WARRANTY IS MADE BY BLM
FOR USE OF THE DATA FOR
PURPOSES NOT INTENDED BY BLM

United States Department of the Interior
Bureau of Land Management
 LANDS/RECREATION & PLANNING
 ONE N CENTRAL AVE
 PHOENIX, AZ 85004 -2203
 Phone: 602-417-9200

Receipt

No: 2868937

Transaction #: 2954901	
Date of Transaction: 08/29/2013	
CUSTOMER:	
GOLDEN PRECIOUS METAL INC 1256 W CHANDLER BLVD STE 29 CHANDLER, AZ 85224-5226 US	

LINE #	QTY	DESCRIPTION	REMARKS	UNIT PRICE	TOTAL
1	1.00	LOCATABLE MINERALS / MINING CLAIMS- NOT NEW-UNADJUD, ONE AUTH NO. ONLY / MINING CLAIM MONEY RECEIVED CASES: AMC31512/\$3920.00	MAINT (28) 2014	- n/a -	3920.00
TOTAL:					\$3,920.00

PAYMENT INFORMATION			
1	AMOUNT:	3920.00	POSTMARKED: N/A
	TYPE:	CHECK	RECEIVED: 08/29/2013
	CHECK NO:	2166	
	NAME:	GOLDEN PRECIOUS METAL INC 1256 W CHANDLER BLVD STE 29 CHANDLER AZ 85224-5226 US	

REMARKS

This receipt was generated by the automated BLM Collections and Billing System and is a paper representation of a portion of the official electronic record contained therein.

AMC 31512

344010

351224

MAINTENANCE FEE PAYMENT

Claimant Name: Golden Precious Metal Inc.

Address: 1256 W. Chandler Blvd Ste 29

City: Chandler State: AZ Zip: 85224-5226

- Telephone: 480.963.3645

- E-mail address: DT.PACE@DTPACE.NET

- Signature: [Signature]

Check here if this is a change of address.

RECEIVED
BLM AZ STATE OFFICE
2012 AUG 22 A 11:28
PHOENIX, ARIZONA

BLM
Date
Stamp

LINE NO.	AMC NUMBER	CLAIM/SITE NAME	COUNTY RECORDER DATA (If available)	TWP	RNG	SEC
1						
2		SEE ATTACHMENT				
3						
4						
5						
6						
7						
8						
9						
10						

List additional claims on Form MCF114.

Bureau of Land Management
Arizona State Office
www.blm.gov/az/

No. of Claims: 28 x \$140 = 3920
 Check No: 2032 Init. SC
 Receipt No.: 2637156
 For BLM Use Only

Form: MCF112
Revised July 2009

This form is available from the Arizona Department of Mines and Mineral Resources and may be reproduced.

ENTERED INTO COMPUTER

9/5/12 AT

DEPARTMENT OF THE INTERIOR
BUREAU OF LAND MANAGEMENT
MINING CLAIMS
Customer Information - WITH Serial No. and Claim Name

ACTIVE CLAIMS

Run Date: 08/16/2012 04:13 PM

Page 1 of 1

Admin State: AZ
Geo State: AZ

GOLDEN PRECIOUS METAL INC
1256 W CHANDLER BLVD STE 29
CHANDLER, AZ 85224-5226

CUSTOMER ID: 2255747

<u>Serial No.</u>	<u>Claim Name/Number</u>	<u>Lead Serial No.</u>	<u>Disposition</u>
AMC31512	GOLDEN HILLSIDE	AMC31512	ACTIVE
AMC31513	GOLDEN HILLSIDE NO 2	AMC31512	ACTIVE
AMC31514	GOLDEN HILLSIDE NO 3	AMC31512	ACTIVE
AMC31515	GOLDEN HILLSIDE NO 4	AMC31512	ACTIVE
AMC31516	GOLDEN HILLSIDE NO 5	AMC31512	ACTIVE
AMC344010	GOLDEN HILLSIDE NO 6	AMC344010	ACTIVE
AMC344011	GOLDEN HILLSIDE NO 7	AMC344010	ACTIVE
AMC344012	GOLDEN HILLSIDE NO 8	AMC344010	ACTIVE
AMC344013	GOLDEN HILLSIDE NO 9	AMC344010	ACTIVE
AMC344014	GOLDEN HILLSIDE NO10	AMC344010	ACTIVE
AMC344015	GOLDEN HILLSIDE NO11	AMC344010	ACTIVE
AMC344016	GOLDEN HILLSIDE NO12	AMC344010	ACTIVE
AMC344017	GOLDEN HILLSIDE 13-A	AMC344010	ACTIVE
AMC344018	GOLDEN HILLSIDE NO14	AMC344010	ACTIVE
AMC344019	GOLDEN HILLSIDE NO15	AMC344010	ACTIVE
AMC344020	GOLDEN HILLSIDE NO16	AMC344010	ACTIVE
AMC344021	GOLDEN HILLSIDE NO23	AMC344010	ACTIVE
AMC344022	GOLDEN HILLSIDE NO24	AMC344010	ACTIVE
AMC344023	GOLDEN HILLSIDE NO25	AMC344010	ACTIVE
AMC351224	DIABLO NO 1	AMC351224	ACTIVE
AMC351225	DIABLO NO 2	AMC351224	ACTIVE
AMC351226	DIABLO NO 3	AMC351224	ACTIVE
AMC351227	DIABLO NO 4	AMC351224	ACTIVE
AMC351228	DIABLO NO 5	AMC351224	ACTIVE
AMC351229	DIABLO NO 6	AMC351224	ACTIVE
AMC351230	DIABLO NO 7	AMC351224	ACTIVE
AMC351231	DIABLO NO 8	AMC351224	ACTIVE
AMC351232	DIABLO NO 9	AMC351224	ACTIVE

Number of ACTIVE cases: 28

SC

NO. OF CLAIMS 28
AMOUNT 3920
RECEIPT NO. 2637156
INIT. SC

** BLM-ASO**

NO WARRANTY IS MADE BY BLM
FOR USE OF THE DATA FOR
PURPOSES NOT INTENDED BY BLM

United States Department of the Interior
 Bureau of Land Management
 LANDS/RECREATION & PLANNING
 ONE N CENTRAL AVE
 PHOENIX, AZ 85004 -2203
 Phone: 602-417-9200

Receipt

No:

2637156

Transaction #: 2717757		ENTERED INTO COMPUTER
Date of Transaction: 08/22/2012		
CUSTOMER:		
GOLDEN PRECIOUS METAL INC 1256 W CHANDLER BLVD STE 29 CHANDLER, AZ 85224-5226 US		

LINE #	QTY	DESCRIPTION	REMARKS	UNIT PRICE	TOTAL
1	1.00	LOCATABLE MINERALS / MINING CLAIMS-NOT NEW-UNADJUD, ONE AUTH NO. ONLY / MINING CLAIM MONEY RECEIVED CASES: AMC31512/\$3920.00	MAINT (28) 2013	- n/a -	3920.00
TOTAL:					\$3,920.00

PAYMENT INFORMATION					
1	AMOUNT:	3920.00	POSTMARKED:	N/A	
	TYPE:	CHECK	RECEIVED:	08/22/2012	
	CHECK NO:	2032			
	NAME:	GOLDEN PRECIOUS METAL INC 1256 W CHANDLER BLVD STE 29 CHANDLER AZ 85224-5226 US			

REMARKS

This receipt was generated by the automated BLM Collections and Billing System and is a paper representation of a portion of the official electronic record contained therein.

Lead file #5 (B)
 AMC 31512
 344010
 351224

Am c 31512
 Am c 344010
 Am c 357224

NO. OF CLAIMS 28
 AMOUNT 3920
 RECEIPT NO. 24/A/86
 INIT. SA
 ** BLM-ASO **

DEPARTMENT OF THE INTERIOR
 BUREAU OF LAND MANAGEMENT
 MINING CLAIMS
 MC Customer Information - WITH Legal Description
 ACTIVE CLAIMS

*Copy from
 claims - 3920
 and due 8/20/11*

Run Date: 03/31/2010 09:59 AM

GOLDEN PRECIOUS METAL INC
 1256 W CHANDLER BLVD #29
 CHANDLER, AZ 85225

INT-REL: CLAIMANT

CUSTOMER ID: 2255747

TO: 4803459559

6024179556

MAR-31-2010, 09:37 FROM: ELM

Serial No	Claim Name/Number	County	P	Claim Type	Last A Xx	Mc Loc Dt	Mr	Twn	Rng	Sec	Subdivision
AMC31512	GOLDEN HILLSIDE	MARICOPA	A	LODE CLAIM	2010	08/01/1966	14	0020N	0080E	036	NE NW
AMC31513	GOLDEN HILLSIDE NO 2	MARICOPA	A	LODE CLAIM	2010	08/19/1974	14	0020N	0080E	036	NE NW
AMC31514	GOLDEN HILLSIDE NO 3	MARICOPA	A	LODE CLAIM	2010	01/13/1975	14	0020N	0080E	025	SW
AMC31515	GOLDEN HILLSIDE NO 4	MARICOPA	A	LODE CLAIM	2010	01/13/1975	14	0020N	0080E	036	NW
AMC31515	GOLDEN HILLSIDE NO 4	MARICOPA	A	LODE CLAIM	2010	01/13/1975	14	0020N	0080E	025	SW SE
AMC31516	GOLDEN HILLSIDE NO 5	MARICOPA	A	LODE CLAIM	2010	01/13/1975	14	0020N	0080E	036	NE NW
AMC31516	GOLDEN HILLSIDE NO 5	MARICOPA	A	LODE CLAIM	2010	02/17/1975	14	0020N	0080E	025	SW SE
AMC344010	GOLDEN HILLSIDE NO 6	MARICOPA	A	LODE CLAIM	2010	10/05/1996	14	0020N	0080E	036	NE NW
AMC344011	GOLDEN HILLSIDE NO 7	MARICOPA	A	LODE CLAIM	2010	10/05/1996	14	0020N	0080E	025	SW
AMC344012	GOLDEN HILLSIDE NO 8	MARICOPA	A	LODE CLAIM	2010	10/05/1996	14	0020N	0080E	025	SW
AMC344013	GOLDEN HILLSIDE NO 9	MARICOPA	A	LODE CLAIM	2010	10/05/1996	14	0020N	0080E	025	SW
AMC344014	GOLDEN HILLSIDE NO 10	MARICOPA	A	LODE CLAIM	2010	10/05/1996	14	0020N	0080E	026	SE
AMC344014	GOLDEN HILLSIDE NO 10	MARICOPA	A	LODE CLAIM	2010	10/05/1996	14	0020N	0080E	025	SW
AMC344015	GOLDEN HILLSIDE NO 11	MARICOPA	A	LODE CLAIM	2010	10/05/1996	14	0020N	0080E	036	NW
AMC344016	GOLDEN HILLSIDE NO 12	MARICOPA	A	LODE CLAIM	2010	10/05/1996	14	0020N	0080E	025	NW SW
AMC344017	GOLDEN HILLSIDE NO 13	MARICOPA	A	LODE CLAIM	2010	10/05/1996	14	0020N	0080E	026	NE SE
AMC344017	GOLDEN HILLSIDE NO 13-A	MARICOPA	A	LODE CLAIM	2010	10/05/1996	14	0020N	0080E	025	NW SW
AMC344018	GOLDEN HILLSIDE NO 14	MARICOPA	A	LODE CLAIM	2010	10/05/1996	14	0020N	0080E	026	NE
AMC344018	GOLDEN HILLSIDE NO 14	MARICOPA	A	LODE CLAIM	2010	10/05/1996	14	0020N	0080E	025	NW SW
AMC344019	GOLDEN HILLSIDE NO 15	MARICOPA	A	LODE CLAIM	2010	10/05/1996	14	0020N	0080E	025	NW SW
AMC344020	GOLDEN HILLSIDE NO 16	MARICOPA	A	LODE CLAIM	2010	10/05/1996	14	0020N	0080E	036	NW
AMC344021	GOLDEN HILLSIDE NO 23	MARICOPA	A	LODE CLAIM	2010	10/05/1996	14	0020N	0080E	035	NE
AMC344021	GOLDEN HILLSIDE NO 23	MARICOPA	A	LODE CLAIM	2010	10/05/1996	14	0020N	0080E	036	NW
AMC344022	GOLDEN HILLSIDE NO 24	MARICOPA	A	LODE CLAIM	2010	10/05/1996	14	0020N	0080E	036	NW
AMC344022	GOLDEN HILLSIDE NO 24	MARICOPA	A	LODE CLAIM	2010	10/05/1996	14	0020N	0080E	025	SW
AMC344023	GOLDEN HILLSIDE NO 25	MARICOPA	A	LODE CLAIM	2010	10/05/1996	14	0020N	0080E	026	SE
AMC344023	GOLDEN HILLSIDE NO 25	MARICOPA	A	LODE CLAIM	2010	10/05/1996	14	0020N	0080E	025	SW
AMC344023	GOLDEN HILLSIDE NO 25	MARICOPA	A	LODE CLAIM	2010	10/05/1996	14	0020N	0080E	026	SE
AMC351224	DIABLO NO 1	SANTA CRUZ	A	LODE CLAIM	2010	01/26/1999	14	0210S	0120E	005	NW
AMC351225	DIABLO NO 2	SANTA CRUZ	A	LODE CLAIM	2010	01/26/1999	14	0210S	0120E	006	NE
AMC351226	DIABLO NO 3	SANTA CRUZ	A	LODE CLAIM	2010	01/26/1999	14	0210S	0120E	005	NW SW
AMC351227	DIABLO NO 4	SANTA CRUZ	A	LODE CLAIM	2010	01/26/1999	14	0210S	0120E	006	NE SE
AMC351228	DIABLO NO 5	SANTA CRUZ	A	LODE CLAIM	2010	01/26/1999	14	0210S	0120E	005	NW
AMC351228	DIABLO NO 5	SANTA CRUZ	A	LODE CLAIM	2010	01/26/1999	14	0210S	0120E	006	NE

PHOENIX, ARIZONA

2011 AUG 22 A 11: 21

PHOENIX, ARIZONA

2010 AUG 12 A 11: 26

RECEIVED
 BLM AZ STATE OFFICE

RECEIVED
 BLM AZ STATE OFFICE

NO. OF CLAIMS 28
 AMOUNT 3920.
 RECEIPT NO. 2189489
 INIT. SA.

NO WARRANTY IS MADE BY BLM FOR USE OF THE DATA
 FOR PURPOSES NOT INTENDED BY BLM

24/10

DEPARTMENT OF THE INTERIOR
 BUREAU OF LAND MANAGEMENT
 MINING CLAIMS
 MC Customer Information - WITH Legal Description
 ACTIVE CLAIMS

Run Date: 03/31/2010 09:59 AM

Page 2 of 2

P. 3/3

TO: 4803459259

6024179556

PHX-31-2010 05:37 FROM: BLM

Serial No	Claim Name/Number	County	D	Claim Type	Last		Nr	Twn	Rng	Sec	Subdivision
					Yr	Mo Loc Dt					
AMC351229	DIABLO NO 6	SANTA CRUZ	A	LODE CLAIM	2010	01/26/1999	14	0210S	0120E	005	NW
AMC351230	DIABLO NO 7	SANTA CRUZ	A	LODE CLAIM	2010	01/26/1999	14	0210S	0120E	006	NE
AMC351231	DIABLO NO 8	SANTA CRUZ	A	LODE CLAIM	2010	01/26/1999	14	0200S	0120E	032	SW
AMC351232	DIABLO NO 9	SANTA CRUZ	A	LODE CLAIM	2010	01/26/1999	14	0210S	0120E	005	NW

ENTERED INTO COMPUTER

SEP 02 2011

RECEIVED
 BLM AZ STATE OFFICE
 PHOENIX, ARIZONA
 2011 AUG 22 A 11: 21

RECEIVED
 BLM AZ STATE OFFICE
 PHOENIX, ARIZONA
 2010 AUG 12 A 11: 26

4/30

United States Department of the Interior
Bureau of Land Management
LANDS/RECREATION & PLANNING
ONE N CENTRAL AVE
PHOENIX, AZ 85004 -2203
Phone: 602-417-9200

Receipt

No: 2411186

Transaction #: 2486531	
Date of Transaction: 08/22/2011	
CUSTOMER:	
GOLDEN PRECIOUS METAL INC 1256 W CHANDLER BLVD STE 29 CHANDLER, AZ 85224-5226 US	SEP 02 2011 <i>m</i>

LINE #	QTY	DESCRIPTION	REMARKS	UNIT PRICE	TOTAL
1	1.00	LOCATABLE MINERALS / MINING CLAIMS-NOT NEW-UNADJUD, ONE AUTH NO. ONLY / MINING CLAIM MONEY RECEIVED CASES: AMC31512/\$3920.00	MAINT (28) 2012	- n/a -	3920.00
TOTAL:					\$3,920.00

PAYMENT INFORMATION			
1	AMOUNT:	3920.00	POSTMARKED: N/A
	TYPE:	CHECK	RECEIVED: 08/22/2011
	CHECK NO:	011672	
	NAME:	GOLDEN PRECIOUS METAL INC 1256 W CHANDLER BLVD STE 29 CHANDLER AZ 85224-5226 US	

REMARKS

This receipt was generated by the automated BLM Collections and Billing System and is a paper representation of a portion of the official electronic record contained therein.

AMC 31512
 AMC 344010
 AMC 351224

DEPARTMENT OF THE INTERIOR
 BUREAU OF LAND MANAGEMENT
 MINING CLAIMS
 MC Customer Information - WITH Legal Description
 ACTIVE CLAIMS

Run Date: 03/31/2010 09:59 AM

GOLDEN PRECIOUS METAL INC
 1256 W CHANDLER BLVD #29 ✓
 CHANDLER, AZ 85225

INT-REL: CLAIMANT

CUSTOMER ID: 2255747

P.2/3
 03459259
 6024179556
 MAR-31-2010 09:37 FROM:BLM

Serial No	Claim Name/Number	County	D	Claim Type	Last		Mr	Twp	Rng	Sec	Subdivision
					Yr	Ac Loc Dt					
AMC315120	GOLDEN HILLSIDE	MARICOPA	A	LODE CLAIM	2010	08/01/1966	14	0020N	0080E	036	NE NW
AMC31513	GOLDEN HILLSIDE NO 2	MARICOPA	A	LODE CLAIM	2010	08/19/1974	14	0020N	0080E	036	NE NW
AMC31514	GOLDEN HILLSIDE NO 3	MARICOPA	A	LODE CLAIM	2010	01/13/1975	14	0020N	0080E	025	SW
AMC31515	GOLDEN HILLSIDE NO 4	MARICOPA	A	LODE CLAIM	2010	01/13/1975	14	0020N	0080E	036	NW
AMC31515	GOLDEN HILLSIDE NO 4	MARICOPA	A	LODE CLAIM	2010	01/13/1975	14	0020N	0080E	025	SW SE
AMC31516	GOLDEN HILLSIDE NO 5	MARICOPA	A	LODE CLAIM	2010	01/13/1975	14	0020N	0080E	036	NE NW
AMC31516	GOLDEN HILLSIDE NO 5	MARICOPA	A	LODE CLAIM	2010	02/17/1975	14	0020N	0080E	025	SW SE
AMC344010	GOLDEN HILLSIDE NO 6	MARICOPA	A	LODE CLAIM	2010	02/17/1975	14	0020N	0080E	036	NE NW
AMC344011	GOLDEN HILLSIDE NO 7	MARICOPA	A	LODE CLAIM	2010	10/05/1996	14	0020N	0080E	025	SW
AMC344012	GOLDEN HILLSIDE NO 8	MARICOPA	A	LODE CLAIM	2010	10/05/1996	14	0020N	0080E	025	SW
AMC344013	GOLDEN HILLSIDE NO 9	MARICOPA	A	LODE CLAIM	2010	10/05/1996	14	0020N	0080E	025	SW
AMC344013	GOLDEN HILLSIDE NO 9	MARICOPA	A	LODE CLAIM	2010	10/05/1996	14	0020N	0080E	025	SW
AMC344014	GOLDEN HILLSIDE NO10	MARICOPA	A	LODE CLAIM	2010	10/05/1996	14	0020N	0080E	026	SE
AMC344014	GOLDEN HILLSIDE NO10	MARICOPA	A	LODE CLAIM	2010	10/05/1996	14	0020N	0080E	025	SW
AMC344015	GOLDEN HILLSIDE NO11	MARICOPA	A	LODE CLAIM	2010	10/05/1996	14	0020N	0080E	036	NW
AMC344016	GOLDEN HILLSIDE NO12	MARICOPA	A	LODE CLAIM	2010	10/05/1996	14	0020N	0080E	036	NW
AMC344016	GOLDEN HILLSIDE NO12	MARICOPA	A	LODE CLAIM	2010	10/05/1996	14	0020N	0080E	025	NW SW
AMC344017	GOLDEN HILLSIDE 13-A	MARICOPA	A	LODE CLAIM	2010	10/05/1996	14	0020N	0080E	026	NE SE
AMC344017	GOLDEN HILLSIDE 13-A	MARICOPA	A	LODE CLAIM	2010	10/05/1996	14	0020N	0080E	025	NW SW
AMC344018	GOLDEN HILLSIDE NO14	MARICOPA	A	LODE CLAIM	2010	10/05/1996	14	0020N	0080E	026	NE
AMC344019	GOLDEN HILLSIDE NO15	MARICOPA	A	LODE CLAIM	2010	10/05/1996	14	0020N	0080E	025	NW SW
AMC344020	GOLDEN HILLSIDE NO16	MARICOPA	A	LODE CLAIM	2010	10/05/1996	14	0020N	0080E	025	NW SW
AMC344021	GOLDEN HILLSIDE NO23	MARICOPA	A	LODE CLAIM	2010	10/05/1996	14	0020N	0080E	036	NW
AMC344021	GOLDEN HILLSIDE NO23	MARICOPA	A	LODE CLAIM	2010	10/05/1996	14	0020N	0080E	035	NE
AMC344022	GOLDEN HILLSIDE NO24	MARICOPA	A	LODE CLAIM	2010	10/05/1996	14	0020N	0080E	036	NW
AMC344022	GOLDEN HILLSIDE NO24	MARICOPA	A	LODE CLAIM	2010	10/05/1996	14	0020N	0080E	025	SW
AMC344023	GOLDEN HILLSIDE NO25	MARICOPA	A	LODE CLAIM	2010	10/05/1996	14	0020N	0080E	026	SE
AMC344023	GOLDEN HILLSIDE NO25	MARICOPA	A	LODE CLAIM	2010	10/05/1996	14	0020N	0080E	025	SW
AMC351224	DIABLO NO 1	MARICOPA	A	LODE CLAIM	2010	10/05/1996	14	0020N	0080E	026	SE
AMC351224	DIABLO NO 1	SANTA CRUZ	A	LODE CLAIM	2010	01/26/1999	14	0210S	0120E	005	NW
AMC351225	DIABLO NO 2	SANTA CRUZ	A	LODE CLAIM	2010	01/26/1999	14	0210S	0120E	006	NE
AMC351225	DIABLO NO 2	SANTA CRUZ	A	LODE CLAIM	2010	01/26/1999	14	0210S	0120E	005	NW SW
AMC351226	DIABLO NO 3	SANTA CRUZ	A	LODE CLAIM	2010	01/26/1999	14	0210S	0120E	006	NE SE
AMC351227	DIABLO NO 4	SANTA CRUZ	A	LODE CLAIM	2010	01/26/1999	14	0210S	0120E	005	NW
AMC351228	DIABLO NO 5	SANTA CRUZ	A	LODE CLAIM	2010	01/26/1999	14	0210S	0120E	005	NW
AMC351228	DIABLO NO 5	SANTA CRUZ	A	LODE CLAIM	2010	01/26/1999	14	0210S	0120E	006	NE

RECEIVED
 PHM AZ STATE OFFICE
 2010 AUG 12 A 11: 26
 PHOENIX, ARIZONA

NO. OF CLAIMS 28
 AMOUNT 3920.
 RECEIPT NO. 2189487
 INIT. SC

NO WARRANTY IS MADE BY BLM FOR USE OF THE DATA FOR PURPOSES NOT INTENDED BY BLM

** BLM-ASO**

24/SC

DEPARTMENT OF THE INTERIOR
 BUREAU OF LAND MANAGEMENT
 MINING CLAIMS
 MC Customer Information - WITH Legal Description
 ACTIVE CLAIMS

Run Date: 03/31/2010 09:59 AM

Page 2 of 2

P. 3/3

4803459259

6024179556

Serial No	Claim Name/Number	County	D	Claim Type	Last		Twp	Rng	Sec	Subdivision
					Yr	Mc Loc Dt				
AMC351229	DIABLO NO 6	SANTA CRUZ	A	LODE CLAIM	2010	01/26/1999	14	0210S	0120E	005 NW
AMC351230	DIABLO NO 7	SANTA CRUZ	A	LODE CLAIM	2010	01/26/1999	14	0210S	0120E	006 NE
AMC351231	DIABLO NO 8	SANTA CRUZ	A	LODE CLAIM	2010	01/26/1999	14	0200S	0120E	032 SW
AMC351232	DIABLO NO 9	SANTA CRUZ	A	LODE CLAIM	2010	01/26/1999	14	0210S	0120E	005 NW
		SANTA CRUZ	A	LODE CLAIM	2010	01/26/1999	14	0200S	0120E	032 SE
		SANTA CRUZ	A	LODE CLAIM	2010	01/26/1999	14	0210S	0120E	005 NE NW
		SANTA CRUZ	A	LODE CLAIM	2010	01/26/1999	14	0210S	0120E	005 NE NW

ENTERED INTO COMPUTER

AUG 20 2010

4/sc

MAR-31-2010 09:37 FROM: BL

RECEIVED
 BLM AZ STATE OFFICE
 2010 AUG 12 A 11: 26
 PHOENIX, ARIZONA

NO WARRANTY IS MADE BY BLM FOR USE OF THE DATA
 FOR PURPOSES NOT INTENDED BY BLM

United States Department of the Interior
Bureau of Land Management
 LANDS/RECREATION & PLANNING
 ONE N CENTRAL AVE
 PHOENIX, AZ 85004 -2203
 Phone:

Receipt

No: 2189489

ENTERED INTO COMPUTER

Transaction #: 2259206	
Date of Transaction: 08/12/2010	
CUSTOMER:	GOLDEN PRECIOUS METAL INC 1256 W CHANDLER BLVD STE 29 ✓ CHANDLER, AZ 85224-5226 US
	AUG 20 2010

LINE #	QTY	DESCRIPTION	REMARKS	UNIT PRICE	TOTAL
1	1.00	LOCATABLE MINERALS / MINING CLAIMS-NOT NEW-UNADJUD, ONE AUTH NO. ONLY / MINING CLAIM MONEY RECEIVED CASES: AMC31512/\$3920.00	MAINT (28) 2011	- n/a -	3920.00 ✓
TOTAL:					\$3,920.00

PAYMENT INFORMATION			
1	AMOUNT:	3920.00	POSTMARKED: N/A
	TYPE:	CHECK	RECEIVED: 08/12/2010
	CHECK NO:	1832	
	NAME:	GOLDEN PRECIOUS METAL INC 1256 W CHANDLER BLVD STE 29 CHANDLER AZ 85224-5226 US	

REMARKS	

This receipt was generated by the automated BLM Collections and Billing System and is a paper representation of a portion of the official electronic record contained therein.

28 Claims Active

DEPARTMENT OF THE INTERIOR
BUREAU OF LAND MANAGEMENT
MINING CLAIMS

AMC 31512
AMC 344010
AMC 351224

MC Customer Information - WITH Legal Description
ACTIVE CLAIMS

Run Date: 07/19/2006 01:38 PM

Page 1

MANHATTAN RESOURCES INC
1256 W CHANDLER BLVD #29
CHANDLER, AZ 85224

INT-REL: CLAIMANT

CUSTOMER ID: 20987

Serial No	Claim Name/Number	County	D	Claim Type	Last A Yr	Mc	Loc	Dt	Mr	Twn	Rng	Sec	Subdivis
AMC31512	GOLDEN HILLSIDE	MARICOPA	A	LODE CLAIM	2006	08/01/1966	14	0020N	0080E	036	NE	NW	
AMC31513	GOLDEN HILLSIDE NO 2	MARICOPA	A	LODE CLAIM	2006	08/19/1974	14	0020N	0080E	036	NE	NW	
AMC31514	GOLDEN HILLSIDE NO 3	MARICOPA	A	LODE CLAIM	2006	01/13/1975	14	0020N	0080E	025	SW		
AMC31515	GOLDEN HILLSIDE NO 4	MARICOPA	A	LODE CLAIM	2006	01/13/1975	14	0020N	0080E	036	NW		
AMC31516	GOLDEN HILLSIDE NO 5	MARICOPA	A	LODE CLAIM	2006	01/13/1975	14	0020N	0080E	025	SW	SE	
AMC344010	GOLDEN HILLSIDE NO 6	MARICOPA	A	LODE CLAIM	2006	01/13/1975	14	0020N	0080E	036	NE	NW	
AMC344011	GOLDEN HILLSIDE NO 7	MARICOPA	A	LODE CLAIM	2006	02/17/1975	14	0020N	0080E	025	SW	SE	
AMC344012	GOLDEN HILLSIDE NO 8	MARICOPA	A	LODE CLAIM	2006	02/17/1975	14	0020N	0080E	036	NE	NW	
AMC344013	GOLDEN HILLSIDE NO 9	MARICOPA	A	LODE CLAIM	2006	10/05/1996	14	0020N	0080E	025	SW		
AMC344014	GOLDEN HILLSIDE NO10	MARICOPA	A	LODE CLAIM	2006	10/05/1996	14	0020N	0080E	025	SW		
AMC344015	GOLDEN HILLSIDE NO11	MARICOPA	A	LODE CLAIM	2006	10/05/1996	14	0020N	0080E	036	NW		
AMC344016	GOLDEN HILLSIDE NO12	MARICOPA	A	LODE CLAIM	2006	10/05/1996	14	0020N	0080E	025	NW	SW	
AMC344017	GOLDEN HILLSIDE 13-A	MARICOPA	A	LODE CLAIM	2006	10/05/1996	14	0020N	0080E	026	NE	SE	
AMC344018	GOLDEN HILLSIDE NO14	MARICOPA	A	LODE CLAIM	2006	10/05/1996	14	0020N	0080E	025	NW	SW	
AMC344019	GOLDEN HILLSIDE NO15	MARICOPA	A	LODE CLAIM	2006	10/05/1996	14	0020N	0080E	025	NW	SW	
AMC344020	GOLDEN HILLSIDE NO16	MARICOPA	A	LODE CLAIM	2006	10/05/1996	14	0020N	0080E	036	NW		
AMC344021	GOLDEN HILLSIDE NO23	MARICOPA	A	LODE CLAIM	2006	10/05/1996	14	0020N	0080E	035	NE		
AMC344022	GOLDEN HILLSIDE NO24	MARICOPA	A	LODE CLAIM	2006	10/05/1996	14	0020N	0080E	036	NW		
AMC344023	GOLDEN HILLSIDE NO25	MARICOPA	A	LODE CLAIM	2006	10/05/1996	14	0020N	0080E	025	SW		
AMC351224	DIABLO NO 1	SANTA CRUZ	A	LODE CLAIM	2006	01/26/1999	14	0210S	0120E	005	NW		
AMC351225	DIABLO NO 2	SANTA CRUZ	A	LODE CLAIM	2006	01/26/1999	14	0210S	0120E	006	NE		
AMC351226	DIABLO NO 3	SANTA CRUZ	A	LODE CLAIM	2006	01/26/1999	14	0210S	0120E	005	NW	SE	
AMC351227	DIABLO NO 4	SANTA CRUZ	A	LODE CLAIM	2006	01/26/1999	14	0210S	0120E	005	NW		
AMC351228	DIABLO NO 5	SANTA CRUZ	A	LODE CLAIM	2006	01/26/1999	14	0210S	0120E	006	NE	SE	
AMC351229	DIABLO NO 6	SANTA CRUZ	A	LODE CLAIM	2006	01/26/1999	14	0210S	0120E	005	NW		
AMC351230	DIABLO NO 7	SANTA CRUZ	A	LODE CLAIM	2006	01/26/1999	14	0210S	0120E	006	NE		

ENTERED INTO COMPUTER

NO WARRANTY IS MADE BY BLM FOR USE OF THE DATA FOR PURPOSES NOT INTENDED BY BLM

28/50

DEPARTMENT OF THE INTERIOR
BUREAU OF LAND MANAGEMENT

MINING CLAIMS

MC Customer Information - WITH Legal Description

ACTIVE CLAIMS

Run Date: 07/19/2006 01:38 PM

Page 2

Serial No	Claim Name/Number	County	D A	Claim Type	Last	Mc	Loc	Dt	Mr	Twn	Rng	Sec	Subdivis
					A Yr								
		SANTA CRUZ	A	LODE CLAIM	2006	01/26/1999	14	0210S	0120E	005	NW		
AMC351231	DIABLO NO 8	SANTA CRUZ	A	LODE CLAIM	2006	01/26/1999	14	0200S	0120E	032	SE		
		SANTA CRUZ	A	LODE CLAIM	2006	01/26/1999	14	0210S	0120E	005	NE NW		
AMC351232	DIABLO NO 9	SANTA CRUZ	A	LODE CLAIM	2006	01/26/1999	14	0210S	0120E	005	NE NW		

NEW ADDRESS
JACK L. DAVIS

P.O. BOX 1719

CHANDLER, AZ 85244

OLD ADDRESS

TERRY CHITTON
15th ST

MESA, AZ

PHOENIX, ARIZONA

2009 AUG 26 A 10:48

RECEIVED
BLM AZ STATE OFFICE



not listed as owner of claims; name not in LR2000

Try to call Jack Davis
explain we need in
writing a change of
address for Golden
Precious Metal Inc signed
by authorized officer.
If we want it in his name
that will require a transfer
Do after Davis, PO's
& Maint fee's entered.

No listing 15 Long

United States Department of the Interior
Bureau of Land Management
 BUSINESS & SUPPORT SVCS DIV
 ONE N CENTRAL AVE SUITE 800
 PHOENIX, AZ 85004 -4427
 Phone: (602) 417-9200

Receipt

No: 1987580

Transaction #: 2051756	
Date of Transaction: 08/26/2009	
CUSTOMER:	GOLDEN PRECIOUS METAL INC 1256 W CHANDLER BLVD STE 29 CHANDLER, AZ 85224-5226 US

LINE #	QTY	DESCRIPTION	REMARKS	UNIT PRICE	TOTAL
1	1.00	LOCATABLE MINERALS / MINING CLAIMS-NOT NEW-UNADJUD, ONE AUTH NO. ONLY / MINING CLAIM MONEY RECEIVED CASES: AMC31512/\$3920.00	MAINT (28) 2010	- n/a -	3920.00
TOTAL:					\$3,920.00

PAYMENT INFORMATION			
NOTE: Items will appear on credit card statement as "Bureau of Land Mgmt CO".			
1	AMOUNT:	1000.00	POSTMARKED: N/A
	TYPE:	CREDIT CARD	RECEIVED: 08/26/2009
	NAME:	DAVIS, JACK PO BOX 1719 CHANDLER AZ 85244	
	CARD NO:	XXXXXXXXXXXX6261	AUTH CODE: 78377B
	NAME ON CARD:	JACK L DAVIS	
	EXPIRES:	12/2010	
	SIGNATURE:		
2	AMOUNT:	960.00	POSTMARKED: N/A
	TYPE:	CHECK	RECEIVED: 08/26/2009
	CHECK NO:	1722	
NAME:	GOLDEN FIDUCIARY GROUP,		
3	AMOUNT:	1960.00	POSTMARKED: N/A
	TYPE:	CHECK	RECEIVED: 08/26/2009
	CHECK NO:	8967	
	NAME:	MCMAHAN, WILMA	

REMARKS

AMC 31512
 AMC 344010
 AMC 351224

MAINTENANCE FEE PAYMENT

Claimant Name: JACK L. DAVIS
 Address: 1256 W. CHANDLER BLVD #29
 City: CHANDLER State: AZ Zip: 85225
 Telephone: 480.963.3645
 E-mail address: DTIPLACE@QWEST.NET
 Signature: [Signature]

RECEIVED
 B.L.M. AZ STATE OFFICE
 2008 AUG 15 A 10:41
 PHOENIX, ARIZONA
 BLM
 Date
 Stamp

Check here if this is a change of address.

LINE NO.	AMC NUMBER	CLAIM/SITE NAME	COUNTY RECORDER DATA (If available)	TWP	RNG	SEC
1	31512	GOLDEN HILLSIDE				
2	31513	GOLDEN HILLSIDE No2				
3	31514	" " No3				
4	31515	" " No4				
5	31516	" " No5				
6	344010	" " No6				
7	344011	" " No7				
8	344012	" " No8				
9	344013	" " No9				
10	344014	" " No10				

List additional claims on Form MCF114.

Bureau of Land Management
 Arizona State Office
www.az.blm.gov

No. of Claims: 28 x \$125 = 3500.
 Check No: 11106 Init. SC
 Receipt No.: 1762292
 For BLM Use Only

RE 9/5/08

Form: MCF112
 Revised July 2005

SUPPLEMENTAL ATTACHMENT

May be used with the following forms for listing additional mining claims:

Check One.

- Affidavit of Performance of Annual Work
- Maintenance Fee Payment
- Notice of Intent to Hold Mining Claims
- Notice of Non-Liability for Labor and Materials Furnished

RECEIVED
B.L.M. AZ STATE OFFICE
2008 AUG 15 A 10:41
PHOENIX, ARIZONA
BLM
Date
Stamp

LINE NO.	AMC NUMBER	CLAIM/SITE NAME	COUNTY RECORDER DATA (If available)	TWP	RNG	SEC
11	344015	Golden Hill Side No 11				
12	344016	" " No 12				
13	344017	Golden Hill Side 13A				
14	344018	Golden Hill Side No 14				
15	344019	" " No 15				
16	344020	" " No 16				
17	344021	" " No 23				
18	344022	" " No 24				
19	344023	" " No 25				
20	351224	DIABLO No 1				
21	351225	No 2				
22	351226	No 3				
23	351227	No 4				
24	351228	No 5				
25	351229	No 6				
26	351230	No 7				
27	351231	No 8				
28	351232	No 9				

Form MCF114
Revised June 2005

United States Department of the Interior
Bureau of Land Management
 BUSINESS & SUPPORT SVCS DIV
 ONE N CENTRAL AVE SUITE 800
 PHOENIX, AZ 85004 -4427
 Phone: (602) 417-9200

Receipt

No:

1762292

Transaction #: 1819844	
Date of Transaction: 08/15/2008	
CUSTOMER:	JACK DAVIS 1256 W CHANDLER BLVD SUITE 29 CHANDLER, AZ 85225

LINE #	QTY	DESCRIPTION	REMARKS	UNIT PRICE	TOTAL
1	1.00	LOCATABLE MINERALS / MINING CLAIMS-NOT NEW-UNADJUD, ONE AUTH NO. ONLY / MINING CLAIM MONEY RECEIVED (455) CASES: AMC31512/\$3500.00	MAINT 2009 (28)	- n/a -	3500.00
TOTAL:					\$3,500.00

PAYMENT INFORMATION					
1	AMOUNT:	\$3,500.00	POSTMARKED:	N/A	
	TYPE:	CHECK	RECEIVED:	08/15/2008	
	CHECK NO:	11106			
	NAME:	DAVIS, JACK 1256 W CHANDLER BLVD SUITE 29 CHANDLER AZ 85225			

REMARKS

This receipt was generated by the automated BLM Collections and Billing System and is a paper representation of a portion of the official electronic record contained therein.

Amc 31512
 Amc 344010
 Amc 351224

MAINTENANCE FEE PAYMENT

Claimant Name: Golden Precious Metal
 Address: 1256 W. CHANDLER BLVD 29
 City: CHANDLER State: AZ Zip: 85225
 Telephone: 480-963-3645
 E-mail address: DT.PINCE@QWEST.NET
 Signature: [Handwritten Signature]

Check here if this is a change of address.

RECEIVED
 B.L.M. AZ STATE OFFICE
 2007 AUG 27 A 10: 59
 PHOENIX, ARIZONA
 BLM
 Date
 Stamp

LINE NO.	AMC NUMBER	CLAIM/SITE NAME	COUNTY RECORDER DATA (If available)	TWP	RNG	SEC
1						
2						
3						
4						
5						
6						
7						
8						
9						
10						

SEE ATTACHED
ONE PAGE

List additional claims on Form MCF114.

Bureau of Land Management
 Arizona State Office
www.az.blm.gov

No. of Claims: 28 x \$125 = 3,500
 Check No: 8663 Init. YMC
1545
 Receipt No.: #1553359
 For BLM Use Only

Form: MCF112
 Revised July 2005

This form is available from the Arizona Department of Mines and Mineral Resources and may be reproduced.

VERIFIED
 OCT 10 2007 PB

ENTERED INTO COMPUTER
 9/19/07 aB

DEPARTMENT OF THE INTERIOR
BUREAU OF LAND MANAGEMENT

MINING CLAIMS
MC Customer Information - With OUT Legal Description
ACTIVE CLAIMS

Run Date: 08/27/2007 10:46 AM

Page 1 of 1

GOLDEN PRECIOUS METAL INC
1256 W CHANDLER BLVD #29
CHANDLER, AZ 85225

INT-REL: CLAIMANT

CUSTOMER ID: 2255747

<u>Serial No</u>	<u>Claim Name/Number</u>	<u>County</u>	<u>Disposition</u>	<u>Int Rel</u>
AMC31512	GOLDEN HILLSIDE	MARICOPA	ACTIVE	CLAIMANT
AMC31513	GOLDEN HILLSIDE NO 2	MARICOPA	ACTIVE	CLAIMANT
AMC31514	GOLDEN HILLSIDE NO 3	MARICOPA	ACTIVE	CLAIMANT
AMC31515	GOLDEN HILLSIDE NO 4	MARICOPA	ACTIVE	CLAIMANT
AMC31516	GOLDEN HILLSIDE NO 5	MARICOPA	ACTIVE	CLAIMANT
AMC344010	GOLDEN HILLSIDE NO 6	MARICOPA	ACTIVE	CLAIMANT
AMC344011	GOLDEN HILLSIDE NO 7	MARICOPA	ACTIVE	CLAIMANT
AMC344012	GOLDEN HILLSIDE NO 8	MARICOPA	ACTIVE	CLAIMANT
AMC344013	GOLDEN HILLSIDE NO 9	MARICOPA	ACTIVE	CLAIMANT
AMC344014	GOLDEN HILLSIDE NO10	MARICOPA	ACTIVE	CLAIMANT
AMC344015	GOLDEN HILLSIDE NO11	MARICOPA	ACTIVE	CLAIMANT
AMC344016	GOLDEN HILLSIDE NO12	MARICOPA	ACTIVE	CLAIMANT
AMC344017	GOLDEN HILLSIDE 13-A	MARICOPA	ACTIVE	CLAIMANT
AMC344018	GOLDEN HILLSIDE NO14	MARICOPA	ACTIVE	CLAIMANT
AMC344019	GOLDEN HILLSIDE NO15	MARICOPA	ACTIVE	CLAIMANT
AMC344020	GOLDEN HILLSIDE NO16	MARICOPA	ACTIVE	CLAIMANT
AMC344021	GOLDEN HILLSIDE NO23	MARICOPA	ACTIVE	CLAIMANT
AMC344022	GOLDEN HILLSIDE NO24	MARICOPA	ACTIVE	CLAIMANT
AMC344023	GOLDEN HILLSIDE NO25	MARICOPA	ACTIVE	CLAIMANT
AMC351224	DIABLO NO 1	SANTA CRUZ	ACTIVE	CLAIMANT
AMC351225	DIABLO NO 2	SANTA CRUZ	ACTIVE	CLAIMANT
AMC351226	DIABLO NO 3	SANTA CRUZ	ACTIVE	CLAIMANT
AMC351227	DIABLO NO 4	SANTA CRUZ	ACTIVE	CLAIMANT
AMC351228	DIABLO NO 5	SANTA CRUZ	ACTIVE	CLAIMANT
AMC351229	DIABLO NO 6	SANTA CRUZ	ACTIVE	CLAIMANT
AMC351230	DIABLO NO 7	SANTA CRUZ	ACTIVE	CLAIMANT
AMC351231	DIABLO NO 8	SANTA CRUZ	ACTIVE	CLAIMANT
AMC351232	DIABLO NO 9	SANTA CRUZ	ACTIVE	CLAIMANT

PHOENIX, ARIZONA

2007 AUG 27 10:59

RECEIVED
BLM, AZ STATE OFFICE

1553359

United States Department of the Interior
Bureau of Land Management
 BUSINESS & SUPPORT SVCS DIV
 ONE N CENTRAL AVE SUITE 800
 PHOENIX, AZ 85004 -4427
 Phone: (602) 417-9200

Receipt

No: 1553359

Transaction #: 1604917	
Date of Transaction: 08/27/2007	
CUSTOMER:	GOLDEN PRECIOUS METAL INC 1256 W CHANDLER BLVD STE 29 CHANDLER,AZ 85225

LINE #	QTY	DESCRIPTION	REMARKS	UNIT PRICE	TOTAL
1	1.00	LOCATABLE MINERALS / MINING CLAIMS- NOT NEW-UNADJUD,ONE AUTH NO. ONLY / MINING CLAIM MONEY RECEIVED (455) CASES: AMC31512/\$3500.00	MAINT 2008/28	- n/a -	3500.00
TOTAL:					\$3,500.00

PAYMENT INFORMATION					
1	AMOUNT:	\$1,750.00	POSTMARKED:	N/A	
	TYPE:	CHECK	RECEIVED:	08/27/2007	
	CHECK NO:	1545			
	NAME:	GOLDEN PRECIOUS METAL INC 1256 W CHANDLER BLVD STE 29 CHANDLER AZ 85225			
2	AMOUNT:	\$1,750.00	POSTMARKED:	N/A	
	TYPE:	CHECK	RECEIVED:	08/27/2007	
	CHECK NO:	8663			
	NAME:	GOLDEN PRECIOUS METAL INC 1256 W CHANDLER BLVD STE 29 CHANDLER AZ 85225			

REMARKS

This receipt was generated by the automated BLM Collections and Billing System and is a paper representation of a portion of the official electronic record contained therein.

AMC 351224
 AMC 344010
 AMC 31512

MAINTENANCE FEE PAYMENT

Claimant Name: MANHATTEN RESOURCES, INC.

Address: 110 S. Mesa Drive, Suite 1

City: Mesa State: AZ Zip: 85210

Telephone: 480-969-0500

E-mail address: _____

Signature: 

Check here if this is a change of address.

BLM Date Stamp	PHOENIX, ARIZONA	2006 AUG 30 A 9:47	RECEIVED B.L.M. AZ STATE OFFICE
----------------------	------------------	--------------------	------------------------------------

LINE NO.	AMC NUMBER	CLAIM/SITE NAME	COUNTY RECORDER DATA (If available)	TWP	RNG	SEC
1		See Attached				
2						
3						
4						
5						
6						
7						
8						
9						
10						

List additional claims on Form MCF114.

Bureau of Land Management
Arizona State Office
www.az.blm.gov

No. of Claims: _____ x \$125 = _____
Check No: _____ Init. _____
Receipt No.: _____
For BLM Use Only

Form: MCF112
 Revised July 2005

This form is available from the **Arizona Department of Mines and Mineral Resources** and may be reproduced.

ENTERED IN COMPUTER
 R2 9/19/06

MANHATTEN RESOURCES, INC.
110 SOUTH MESA DRIVE
SUITE 1
MESA, ARIZONA 85210
(480) 969-0500

RECEIVED
B.L.M. AZ STATE OFFICE
2006 AUG 30 A 9:47
PHOENIX, ARIZONA

August 24, 2006

Bureau of Land Management
Arizona State Office
222 North Central Avenue
Phoenix, AZ 85004

RE: Maintenance Fee Payment

Gentlemen:

Please accept our check in the amount of Three Thousand Five Hundred Dollars (\$3,500.00) for the twenty-eight (28) claims known as the Golden Hillside Claims and Diablo Mining Claims, for the maintenance payment for the year beginning September 1, 2005 to August 31, 2006. The name of the claims, AMC numbers and counties are as follows:

GOLDEN HILLSIDE: The following Lode Claims are located in the Superstition Mining District, Sections 25, 26, 35 and 36, in Township 2N, Range 8E, in Maricopa County, Arizona.

<u>BLM SERIAL NUMBERS</u>	<u>NAMES OF CLAIMS/SITES</u>	<u>CLAIMANT(S) NAME</u>
AMC 31512	Golden Hillside	Manhattan Resources, Inc.
AMC 31513	Golden Hillside #2	Manhattan Resources, Inc.
AMC 31514	Golden Hillside #3	Manhattan Resources, Inc.
AMC 31515	Golden Hillside #4	Manhattan Resources, Inc.
AMC 31516	Golden Hillside #5	Manhattan Resources, Inc.
AMC 344010	Golden Hillside #6	Manhattan Resources, Inc.
AMC 344011	Golden Hillside #7	Manhattan Resources, Inc.
AMC 344012	Golden Hillside #8	Manhattan Resources, Inc.
AMC 344013	Golden Hillside #9	Manhattan Resources, Inc.
AMC 344014	Golden Hillside #10	Manhattan Resources, Inc.
AMC 344015	Golden Hillside #11	Manhattan Resources, Inc.
AMC 344016	Golden Hillside #12	Manhattan Resources, Inc.
AMC 344017	Golden Hillside #13-A	Manhattan Resources, Inc.
AMC 344018	Golden Hillside #14	Manhattan Resources, Inc.
AMC 344019	Golden Hillside #15	Manhattan Resources, Inc.
AMC 344020	Golden Hillside #16	Manhattan Resources, Inc.
AMC 344021	Golden Hillside #23	Manhattan Resources, Inc.
AMC 344022	Golden Hillside #24	Manhattan Resources, Inc.
AMC 344023	Golden Hillside #25	Manhattan Resources, Inc.

19
TMC

August 24, 2006
Bureau of Land Management
Arizona State Office
Page 2

DIABLO MINING CLAIMS: The following Lode Claims are located in the Tumacacori Mining District, Sections 5, 6 and 32, in Township 21-S, Range 12-E, of the Gila and Salt River Base, 2nd Meridian, Santa Cruz County, Arizona.

<u>BLM SERIAL NUMBERS</u>	<u>NAMES OF CLAIMS/SITES</u>	<u>CLAIMANT(S) NAME</u>
AMC 351224	Diablo #1	Manhattan Resources, Inc.
AMC 351225	Diablo #2	Manhattan Resources, Inc.
AMC 351226	Diablo #3	Manhattan Resources, Inc.
AMC 351227	Diablo #4	Manhattan Resources, Inc.
AMC 351228	Diablo #5	Manhattan Resources, Inc.
AMC 351229	Diablo #6	Manhattan Resources, Inc.
AMC 351230	Diablo #7	Manhattan Resources, Inc.
AMC 351231	Diablo #8	Manhattan Resources, Inc.
AMC 351232	Diablo #9	Manhattan Resources, Inc.

Claimant's name, Manhattan Resources, Inc., 110 S. Mesa Drive, Suite 1, Mesa, Arizona 85210, telephone number 480-969-0500 and facsimile number 480-969-7056.

Sincerely,

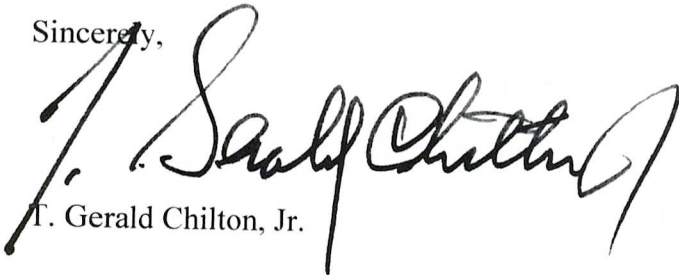

T. Gerald Chilton, Jr.

TGC/mm

Enclosure

RECEIVED
BLM. AZ STATE OFFICE
2006 AUG 30 A 9:47
PHOENIX, ARIZONA

9
TMC

United States Department of the Interior
Bureau of Land Management
 BUSINESS & SUPPORT SVCS DIV
 ONE N CENTRAL AVE
 PHOENIX, AZ 85004 -2203
 Phone: (602) 417-9200

Receipt

No: 1353828

Transaction #: 1399214	
Date of Transaction: 09/07/2006	
CUSTOMER:	MANHATTEN RESOURCES 110 S MESA DR STE 1 MESA, AZ 85210

LINE #	QTY	DESCRIPTION	REMARKS	UNIT PRICE	TOTAL
1	1.00	LOCATABLE MINERALS / MINING CLAIMS-NOT NEW-UNADJUD, ONE AUTH NO. ONLY / MINING CLAIM MONEY RECEIVED (455) CASES: AMC31512/\$3500.00	MAINT 2007/28	- n/a -	3500.00
TOTAL:					\$3,500.00

PAYMENT INFORMATION					
1	AMOUNT:	\$1,800.00	POSTMARKED:	08/28/2006	
	TYPE:	CHECK	RECEIVED:	08/30/2006	
	CHECK NO:	701297346			
	NAME:	MCMAHAN, LOUIS 110 S MESA DR STE 1 MESA AZ 85210			
2	AMOUNT:	\$1,700.00	POSTMARKED:	08/28/2006	
	TYPE:	CHECK	RECEIVED:	09/07/2006	
	CHECK NO:	0679718847			
	NAME:	CHILTON JR., T. GERALD 110 S MESA DR STE 1 MESA AZ 85210			

REMARKS

This receipt was generated by the automated BLM Collections and Billing System and is a paper representation of a portion of the official electronic record contained therein.

3 28 500
7
3500

**United States Department of the Interior
Bureau of Land Management**

BUSINESS & SUPPORT SVCS DIV
222 N CENTRAL AVE
PHOENIX, AZ 85004 -2203
Phone: (602) 417-9200

Receipt	
No:	1141385

Transaction #: 1180616	AMC 31512 AMC 344010 AMC 351224
Date of Transaction: 08/30/2005	
CUSTOMER: MANHATTEN RESOURCES 110 S. MESA DR MESA, AZ 85210	

LINE #	QTY	DESCRIPTION	REMARKS	UNIT PRICE	TOTAL
1	1.00	LOCATABLE MINERALS / MINING CLAIMS-NOT NEW-UNADJUD, ONE AUTH NO. ONLY / MINING CLAIM MONEY RECEIVED (455) CASES: AMC31512/\$3500.00	MAINT 2006 - 28	- n/a -	3500.00
TOTAL:					\$3,500.00

PAYMENT INFORMATION			
1	AMOUNT:	\$3,500.00	POSTMARKED: N/A
	TYPE:	CHECK	RECEIVED: 08/30/2005
	CHECK NO:	1273	
	NAME:	MANHATTEN RESOURCES 110 S. MESA DR STE 1 MESA AZ 85210	

REMARKS

This receipt was generated by the automated BLM Collections and Billing System and is a paper representation of a portion of the official electronic record contained therein.

ENTERED BY [unclear]
RE 9/12/05

MAINTENANCE FEE PAYMENT

Claimant Name: MANHATTEN RESOURCES, INC.

Address: 110 S. Mesa Drive, Suite 1

City: Mesa State: AZ Zip: 85210

Telephone: 480-969-0500

E-mail address: _____

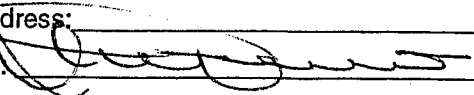
Signature: 

Check here if this is a change of address.

RECEIVED
B.L.M. AZ STATE OFFICE
2005 AUG 30 P 12: 4
PHOENIX, ARIZONA

BLM
Date
Stamp

LINE NO.	AMC NUMBER	CLAIM/SITE NAME	COUNTY RECORDER DATA (If available)	TWP	RNG	SEC
1		See Attached				
2						
3						
4						
5						
6						
7						
8						
9						
10						

List additional claims on Form MCF114.

Bureau of Land Management
Arizona State Office
www.az.blm.gov

No. of Claims: 28 x \$125 = 3,500⁰⁰
 Check No: _____ Init. (770)
 Receipt No.: _____
For BLM Use Only

Form: MCF112
Revised July 2005

This form is available from the **Arizona Department of Mines and Mineral Resources** and may be reproduced.

MANHATTEN RESOURCES, INC.
110 SOUTH MESA DRIVE
SUITE 1
MESA, ARIZONA 85210
(480) 969-0500

August 24, 2005

Bureau of Land Management
Arizona State Office
222 North Central Avenue
Phoenix, AZ 85004

RE: Maintenance Fee Payment

RECEIVED
B.L.M. AZ STATE OFFICE
2005 AUG 30 P 12:41
PHOENIX, ARIZONA

Gentlemen:

Please accept our check in the amount of Three Thousand Five Hundred Dollars (\$3,500.00) for the twenty-eight (28) claims known as the Golden Hillside Claims and Diablo Mining Claims, for the maintenance payment for the year beginning September 1, 2004 to August 31, 2005. The name of the claims, AMC numbers and counties are as follows:

GOLDEN HILLSIDE: The following Lode Claims are located in the Superstition Mining District, Sections 25, 26, 35 and 36, in Township 2N, Range 8E, in Maricopa County, Arizona.

<u>BLM SERIAL NUMBERS</u>	<u>NAMES OF CLAIMS/SITES</u>	<u>CLAIMANT(S) NAME</u>
AMC 31512	Golden Hillside	Manhattan Resources, Inc.
AMC 31513	Golden Hillside #2	Manhattan Resources, Inc.
AMC 31514	Golden Hillside #3	Manhattan Resources, Inc.
AMC 31515	Golden Hillside #4	Manhattan Resources, Inc.
AMC 31516	Golden Hillside #5	Manhattan Resources, Inc.
AMC 344010	Golden Hillside #6	Manhattan Resources, Inc.
AMC 344011	Golden Hillside #7	Manhattan Resources, Inc.
AMC 344012	Golden Hillside #8	Manhattan Resources, Inc.
AMC 344013	Golden Hillside #9	Manhattan Resources, Inc.
AMC 344014	Golden Hillside #10	Manhattan Resources, Inc.
AMC 344015	Golden Hillside #11	Manhattan Resources, Inc.
AMC 344016	Golden Hillside #12	Manhattan Resources, Inc.
AMC 344017	Golden Hillside #13-A	Manhattan Resources, Inc.
AMC 344018	Golden Hillside #14	Manhattan Resources, Inc.
AMC 344019	Golden Hillside #15	Manhattan Resources, Inc.
AMC 344020	Golden Hillside #16	Manhattan Resources, Inc.
AMC 344021	Golden Hillside #23	Manhattan Resources, Inc.
AMC 344022	Golden Hillside #24	Manhattan Resources, Inc.
AMC 344023	Golden Hillside #25	Manhattan Resources, Inc.

RE 9/12/05

19

August 24, 2005
Bureau of Land Management
Arizona State Office
Page 2

DIABLO MINING CLAIMS: The following Lode Claims are located in the Tumacacori Mining District, Sections 5, 6 and 32, in Township 21-S, Range 12-E, of the Gila and Salt River Base, 2nd Meridian, Santa Cruz County, Arizona.

<u>BLM SERIAL NUMBERS</u>	<u>NAMES OF CLAIMS/SITES</u>	<u>CLAIMANT(S) NAME</u>
AMC 351224	Diablo #1	Manhattan Resources, Inc.
AMC 351225	Diablo #2	Manhattan Resources, Inc.
AMC 351226	Diablo #3	Manhattan Resources, Inc.
AMC 351227	Diablo #4	Manhattan Resources, Inc.
AMC 351228	Diablo #5	Manhattan Resources, Inc.
AMC 351229	Diablo #6	Manhattan Resources, Inc.
AMC 351230	Diablo #7	Manhattan Resources, Inc.
AMC 351231	Diablo #8	Manhattan Resources, Inc.
AMC 351232	Diablo #9	Manhattan Resources, Inc.

9 TR

Claimant's name, Manhattan Resources, Inc., 110 S. Mesa Drive, Suite 1, Mesa, Arizona 85210, telephone number 480-969-0500 and facsimile number 480-969-7056.

Sincerely,

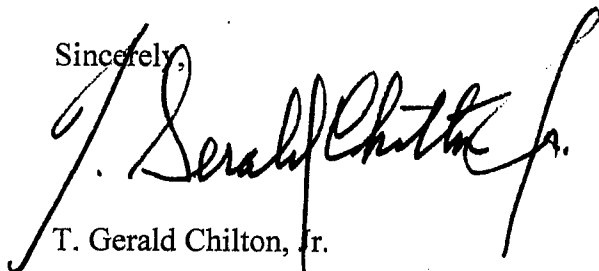

T. Gerald Chilton, Jr.

TGC/mm

Enclosure

RECEIVED
B.L.M. AZ STATE OFFICE
2005 AUG 30 P 12:41
PHOENIX, ARIZONA

RE 9/12/05

AMC 31512
 AMC 344010
 AMC 351224

MAINTENANCE FEE PAYMENT

BUREAU OF LAND MANAGEMENT
 222 N CENTRAL AVENUE
 PHOENIX, AZ 85004
 602-417-9200
 www.az.blm.gov

RECEIVED
 B.L.M. AZ STATE OFFICE
 2004 AUG 31 P 1:19
 PHOENIX, ARIZONA
 BLM Date Stamp

Mining Claim Maintenance Fee Payment of \$125 per claim/site is due on or before September 1, 20⁰⁴, in lieu of assessment work for the upcoming assessment year beginning September 1 of the year noted above.

AMC NUMBER	CLAIM/SITE NAME	COUNTY RECORDER DATA	SEC	TWP	RNG
	See Attached				

ENTERED IN COMPUTER

List additional claims on the reverse side of this form.
 Check here if this is a change of address.

CLAIMANT NAME: MANHATTEN RESOURCES, INC.
 ADDRESS: 110 S. Mesa Drive, Suite 1
 CITY: Mesa STATE: AZ ZIP: 85210
 PHONE: _____
 SIGNATURE: _____

9/17/04 *MLH*

No of Claims: <u>28</u>	x \$125 = <u>\$3500.00</u>
Check No: _____	Init: <u>TSS</u>
Receipt No: _____	
FOR BLM USE ONLY	

Claimant or agent must sign to record with the County.

MANHATTEN RESOURCES, INC —
110 SOUTH MESA DRIVE
SUITE 1
MESA, ARIZONA 85210
(480) 969-0500

August 30, 2004

Bureau of Land Management
Arizona State Office
222 North Central Avenue
Phoenix, AZ 85004

RECEIVED
BLM. AZ STATE OFFICE
2004 AUG 31 P 1:19
PHOENIX, ARIZONA

RE: Maintenance Fee Payment

Gentlemen:

Please accept our check in the amount of Three Thousand Five Hundred Dollars (\$3,500.00) for the twenty-eight (28) claims known as the Golden Hillside Claims and Diablo Mining Claims, for the maintenance payment for the year beginning September 1, 2003 to August 31, 2004. The name of the claims, AMC numbers and counties are as follows:

GOLDEN HILLSIDE: The following Lode Claims are located in the Superstition Mining District, Sections 25, 26, 35 and 36, in Township 2N, Range 8E, in Maricopa County, Arizona.

<u>BLM SERIAL NUMBERS</u>	<u>NAMES OF CLAIMS/SITES</u>	<u>CLAIMANT(S) NAME</u>
AMC 31512	Golden Hillside	Manhattan Resources, Inc.
AMC 31513	Golden Hillside #2	Manhattan Resources, Inc.
AMC 31514	Golden Hillside #3	Manhattan Resources, Inc.
AMC 31515	Golden Hillside #4	Manhattan Resources, Inc.
AMC 31516	Golden Hillside #5	Manhattan Resources, Inc.
AMC 344010	Golden Hillside #6	Manhattan Resources, Inc.
AMC 344011	Golden Hillside #7	Manhattan Resources, Inc.
AMC 344012	Golden Hillside #8	Manhattan Resources, Inc.
AMC 344013	Golden Hillside #9	Manhattan Resources, Inc.
AMC 344014	Golden Hillside #10	Manhattan Resources, Inc.
AMC 344015	Golden Hillside #11	Manhattan Resources, Inc.
AMC 344016	Golden Hillside #12	Manhattan Resources, Inc.
AMC 344017	Golden Hillside #13-A	Manhattan Resources, Inc.
AMC 344018	Golden Hillside #14	Manhattan Resources, Inc.
AMC 344019	Golden Hillside #15	Manhattan Resources, Inc.
AMC 344020	Golden Hillside #16	Manhattan Resources, Inc.
AMC 344021	Golden Hillside #23	Manhattan Resources, Inc.
AMC 344022	Golden Hillside #24	Manhattan Resources, Inc.
AMC 344023	Golden Hillside #25	Manhattan Resources, Inc.

28x 125 3500
T23
19

DIABLO MINING CLAIMS: The following Lode Claims are located in the Tumacacori Mining District, Sections 5, 6 and 32, in Township 21-S, Range 12-E, of the Gila and Salt River Base, 2nd Meridian, Santa Cruz County, Arizona.

<u>BLM SERIAL NUMBERS</u>	<u>NAMES OF CLAIMS/SITES</u>	<u>CLAIMANT(S) NAME</u>
AMC 351224	Diablo #1	Manhattan Resources, Inc.
AMC 351225	Diablo #2	Manhattan Resources, Inc.
AMC 351226	Diablo #3	Manhattan Resources, Inc.
AMC 351227	Diablo #4	Manhattan Resources, Inc.
AMC 351228	Diablo #5	Manhattan Resources, Inc.
AMC 351229	Diablo #6	Manhattan Resources, Inc.
AMC 351230	Diablo #7	Manhattan Resources, Inc.
AMC 351231	Diablo #8	Manhattan Resources, Inc.
AMC 351232	Diablo #9	Manhattan Resources, Inc.

Claimant's name, Manhattan Resources, Inc., 110 S. Mesa Drive, Suite 1, Mesa, Arizona 85210, telephone number 480-969-0500 and facsimile number 480-969-7056.

Sincerely,

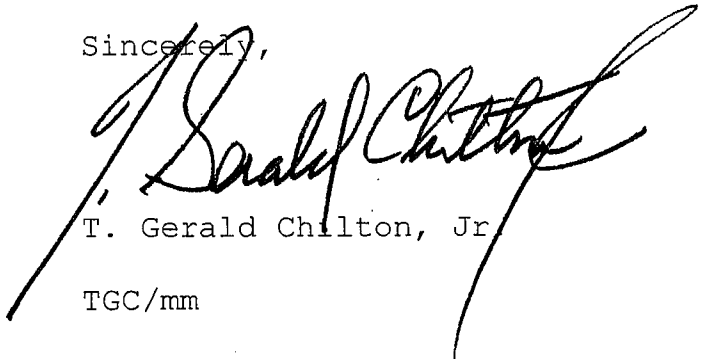

T. Gerald Chilton, Jr

TGC/mm

RECEIVED
B.L.M. AZ STATE OFFICE
2004 AUG 31 P 1:19
PHOENIX, ARIZONA

5
9

United States Department of the Interior
Bureau of Land Management
 BUSINESS & SUPPORT SVCS DIV
 222 N CENTRAL AVE
 PHOENIX, AZ 85004 -2203
 Phone: (602) 417-9200

Receipt	
No:	942704

Transaction #: 977099
Date of Transaction: 08/31/2004
CUSTOMER: MANHATTEN RESOURCES 110 S. MESA DR MESA, AZ 85210

LINE #	QTY	DESCRIPTION	REMARKS	UNIT PRICE	TOTAL
1	1.00	LOCATABLE MINERALS / MINING CLAIMS-NOT NEW-UNADJUD, ONE AUTH NO. ONLY / MINING CLAIM MONEY RECEIVED (455) CASES: AMC31512/\$3500.00	MAIN 2005 (28)	- n/a -	3500.00
TOTAL:					\$3,500.00

PAYMENT INFORMATION			
1	AMOUNT:	\$3,500.00	POSTMARKED: N/A
	TYPE:	CHECK	RECEIVED: 08/31/2004
	CHECK NO:	1117	
	NAME:	GOLDEN FIDUCIARY GROUP P.O. BOX 1719 CHANDLER AZ 85244	

REMARKS

This receipt was generated by the automated BLM Collections and Billing System and is a paper representation of a portion of the official electronic record contained therein.

MANHATTEN RESOURCES, INC.
110 SOUTH MESA DRIVE
SUITE 1
MESA, ARIZONA 85210
(480) 969-0500

August 27, 2003

Bureau of Land Management
Arizona State Office
222 North Central Avenue
Phoenix, AZ 85004

AMC 31512

AMC 351224

AMC 344010

RE: Maintenance Fee Payment

Gentlemen:

Please accept our check in the amount of Two Thousand Eight Hundred Dollars (\$2,800.00) for the twenty-eight (28) claims known as the Golden Hillside Claims and Diablo Mining Claims, for the maintenance payment for the year beginning September 1, 2002 to August 31, 2003. The name of the claims, AMC numbers and counties are as follows:

GOLDEN HILLSIDE: The following Lode Claims are located in the Superstition Mining District, Sections 25, 26, 35 and 36, in Township 2N, Range 8E, in Maricopa County, Arizona.

<u>BLM SERIAL NUMBERS</u>	<u>NAMES OF CLAIMS/SITES</u>	<u>CLAIMANT(S) NAME</u>
AMC 31512	Golden Hillside	Manhattan Resources, Inc.
AMC 31513	Golden Hillside #2	Manhattan Resources, Inc.
AMC 31514	Golden Hillside #3	Manhattan Resources, Inc.
AMC 31515	Golden Hillside #4	Manhattan Resources, Inc.
AMC 31516	Golden Hillside #5	Manhattan Resources, Inc.
AMC 344010	Golden Hillside #6	Manhattan Resources, Inc.
AMC 344011	Golden Hillside #7	Manhattan Resources, Inc.
AMC 344012	Golden Hillside #8	Manhattan Resources, Inc.
AMC 344013	Golden Hillside #9	Manhattan Resources, Inc.
AMC 344014	Golden Hillside #10	Manhattan Resources, Inc.
AMC 344015	Golden Hillside #11	Manhattan Resources, Inc.
AMC 344016	Golden Hillside #12	Manhattan Resources, Inc.
AMC 344017	Golden Hillside #13-A	Manhattan Resources, Inc.
AMC 344018	Golden Hillside #14	Manhattan Resources, Inc.
AMC 344019	Golden Hillside #15	Manhattan Resources, Inc.
AMC 344020	Golden Hillside #16	Manhattan Resources, Inc.
AMC 344021	Golden Hillside #23	Manhattan Resources, Inc.
AMC 344022	Golden Hillside #24	Manhattan Resources, Inc.
AMC 344023	Golden Hillside #25	Manhattan Resources, Inc.

RECEIVED
BUREAU OF
LAND MANAGEMENT

ENTERED IN COMPUTER

DIABLO MINING CLAIMS: The following Lode Claims are located in the Tumacacori Mining District, Sections 5, 6 and 32, in Township 21-S, Range 12-E, of the Gila and Salt River Base, 2nd Meridian, Santa Cruz County, Arizona.

<u>BLM SERIAL NUMBERS</u>	<u>NAMES OF CLAIMS/SITES</u>	<u>CLAIMANT(S) NAME</u>
AMC 351224	Diablo #1	Manhattan Resources, Inc.
AMC 351225	Diablo #2	Manhattan Resources, Inc.
AMC 351226	Diablo #3	Manhattan Resources, Inc.
AMC 351227	Diablo #4	Manhattan Resources, Inc.
AMC 351228	Diablo #5	Manhattan Resources, Inc.
AMC 351229	Diablo #6	Manhattan Resources, Inc.
AMC 351230	Diablo #7	Manhattan Resources, Inc.
AMC 351231	Diablo #8	Manhattan Resources, Inc.
AMC 351232	Diablo #9	Manhattan Resources, Inc.

Claimant's name, Manhattan Resources, Inc., 110 S. Mesa Drive, Suite 1, Mesa, Arizona 85210, telephone number 480-969-0500 and facsimile number 480-969-7056.

Sincerely,

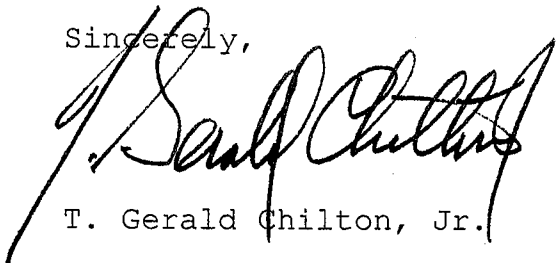

T. Gerald Chilton, Jr.

TGC/mm

ARIZONA
STATE OFFICE
PHOENIX, ARIZONA

2003 SEP -9 A 10:21

BUREAU OF
LAND MANAGEMENT
RECEIVED

ENTERED IN COMPUTER

MANHATTEN RESOURCES, INC.
110 SOUTH MESA DRIVE
SUITE 1
MESA, ARIZONA 85210
(480) 969-0500

August 27, 2003

Bureau of Land Management
Arizona State Office
222 North Central Avenue
Phoenix, AZ 85004

RE: Maintenance Fee Payment

Gentlemen:

Please accept our check in the amount of Two Thousand Eight Hundred Dollars (\$2,800.00) for the twenty-eight (28) claims known as the Golden Hillside Claims and Diablo Mining Claims, for the maintenance payment for the year beginning September 1, 2002 to August 31, 2003. The name of the claims, AMC numbers and counties are as follows:

GOLDEN HILLSIDE: The following Lode Claims are located in the Superstition Mining District, Sections 25, 26, 35 and 36, in Township 2N, Range 8E, in Maricopa County, Arizona.

<u>BLM SERIAL NUMBERS</u>	<u>NAMES OF CLAIMS/SITES</u>	<u>CLAIMANT(S) NAME</u>
AMC 31512	Golden Hillside	Manhattan Resources, Inc.
AMC 31513	Golden Hillside #2	Manhattan Resources, Inc.
AMC 31514	Golden Hillside #3	Manhattan Resources, Inc.
AMC 31515	Golden Hillside #4	Manhattan Resources, Inc.
AMC 31516	Golden Hillside #5	Manhattan Resources, Inc.
AMC 344010	Golden Hillside #6	Manhattan Resources, Inc.
AMC 344011	Golden Hillside #7	Manhattan Resources, Inc.
AMC 344012	Golden Hillside #8	Manhattan Resources, Inc.
AMC 344013	Golden Hillside #9	Manhattan Resources, Inc.
AMC 344014	Golden Hillside #10	Manhattan Resources, Inc.
AMC 344015	Golden Hillside #11	Manhattan Resources, Inc.
AMC 344016	Golden Hillside #12	Manhattan Resources, Inc.
AMC 344017	Golden Hillside #13-A	Manhattan Resources, Inc.
AMC 344018	Golden Hillside #14	Manhattan Resources, Inc.
AMC 344019	Golden Hillside #15	Manhattan Resources, Inc.
AMC 344020	Golden Hillside #16	Manhattan Resources, Inc.
AMC 344021	Golden Hillside #23	Manhattan Resources, Inc.
AMC 344022	Golden Hillside #24	Manhattan Resources, Inc.
AMC 344023	Golden Hillside #25	Manhattan Resources, Inc.

ENTERED IN COMPUTER
BUREAU OF LAND MANAGEMENT

DIABLO MINING CLAIMS: The following Lode Claims are located in the Tumacacori Mining District, Sections 5, 6 and 32, in Township 21-S, Range 12-E, of the Gila and Salt River Base, 2nd Meridian, Santa Cruz County, Arizona.

<u>BLM SERIAL NUMBERS</u>	<u>NAMES OF CLAIMS/SITES</u>	<u>CLAIMANT(S) NAME</u>
AMC 351224	Diablo #1	Manhattan Resources, Inc.
AMC 351225	Diablo #2	Manhattan Resources, Inc.
AMC 351226	Diablo #3	Manhattan Resources, Inc.
AMC 351227	Diablo #4	Manhattan Resources, Inc.
AMC 351228	Diablo #5	Manhattan Resources, Inc.
AMC 351229	Diablo #6	Manhattan Resources, Inc.
AMC 351230	Diablo #7	Manhattan Resources, Inc.
AMC 351231	Diablo #8	Manhattan Resources, Inc.
AMC 351232	Diablo #9	Manhattan Resources, Inc.

Claimant's name, Manhattan Resources, Inc., 110 S. Mesa Drive, Suite 1, Mesa, Arizona 85210, telephone number 480-969-0500 and facsimile number 480-969-7056.

Sincerely,

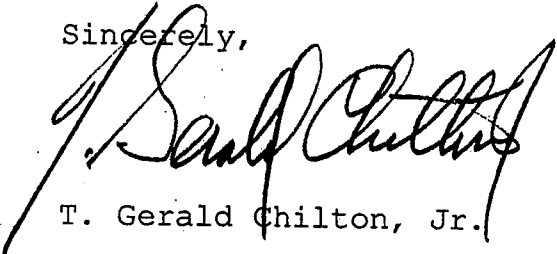

T. Gerald Chilton, Jr.

TGC/mm

ARIZONA
STATE OFFICE
PHOENIX, ARIZONA

2003 SEP -9 A 10:21

RECEIVED
BUREAU OF
LAND MANAGEMENT

ENTERED IN COMPU

MAINTENANCE FEE PAYMENT

September 1, 2002 to Aug. 31, 2003

Mining Claim Maintenance Fee Payment of \$100 per claim or site is due on or before September 1, 20__, in lieu of assessment work for the upcoming assessment year beginning September 1 of the year noted above.

BUREAU OF LAND MANAGEMENT
ARIZONA STATE OFFICE
222 NORTH CENTRAL AVENUE
PHOENIX, AZ 85004
602-417-9200
www.az.blm.gov

FOR BLM USE ONLY	
NO. OF CLAIMS: _____	X \$100 = \$ _____
RECEIPT NO: _____	CHECK NO: _____
INIT: _____	

BLM SERIAL NUMBERS	NAME OF CLAIMS/SITES	COUNTY/Maricopa BOOK/DOCKET & PAGE OR FEE NUMBER
1. AMC	See Attached	
2. AMC		
3. AMC		
4. AMC		
5. AMC		
6. AMC		
7. AMC		
8. AMC		
9. AMC		
10. AMC		

List additional claims on the reverse side of this form.

CHECK HERE IF THIS IS A CHANGE OF ADDRESS

CLAIMANT'S NAME: MANHATTEN RESOURCES, INC.

ADDRESS: 110 S. Mesa Drive, Suite 1, Mesa
CITY: Mesa STATE: AZ ZIP: 85210
PHONE: 480-969-0500

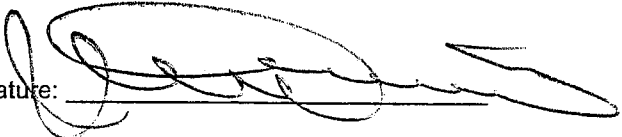
Signature: 

To record with the County, one claimant or an agent must sign.

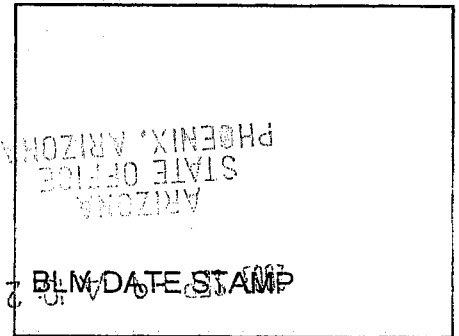

- 11. AMC _____
- 12. AMC _____
- 13. AMC _____
- 14. AMC _____
- 15. AMC _____
- 16. AMC _____
- 17. AMC _____
- 18. AMC _____
- 19. AMC _____
- 20. AMC _____

43 CFR 3833.0-5(e) (August 30, 1994) requires that the names of all of the owners and their current addresses shall be identified on all instruments required to be recorded or filed by the regulation, 43 CFR Subpart 3833.

NAME: _____ ADDRESS: _____
 CITY: _____ STATE: _____ ZIP: _____ IS THIS A NEW ADDRESS ..

NAME: _____ ADDRESS: _____
 CITY: _____ STATE: _____ ZIP: _____ IS THIS A NEW ADDRESS ..

NAME: _____ ADDRESS: _____
 CITY: _____ STATE: _____ ZIP: _____ IS THIS A NEW ADDRESS ..

NAME: _____ ADDRESS: _____
 CITY: _____ STATE: _____ ZIP: _____ IS THIS A NEW ADDRESS ..

January 30, 2003

FOR BLM USE ONLY	
DATE ENTERED INTO COMPUTER:	_____
INITIALS:	_____ VERIFIED: _____

MAINTENANCE FEE PAYMENT

Sept. 1, 2002 to Aug. 31, 2003

Mining Claim Maintenance Fee Payment of \$100 per claim or site is due on or before September 1, 20___, in lieu of assessment work for the upcoming assessment year beginning September 1 of the year noted above.

BUREAU OF LAND MANAGEMENT
ARIZONA STATE OFFICE
222 NORTH CENTRAL AVENUE
PHOENIX, AZ 85004
602-417-9200
www.az.blm.gov

FOR BLM USE ONLY	
NO. OF CLAIMS: _____	X \$100 = \$ _____
RECEIPT NO: _____	CHECK NO: _____
INIT: _____	

BLM SERIAL
NUMBERS

NAME OF CLAIMS/SITES

COUNTY /Santa Cruz
BOOK/DOCKET & PAGE OR
FEE NUMBER

- | | | | |
|---------|------------------------------|----------------------------|-------|
| 1. AMC | <u>320074 through 320082</u> | <u>Diablo #1-Diablo #9</u> | _____ |
| 2. AMC | <u>351224 - 351232</u> | | _____ |
| 3. AMC | _____ | | _____ |
| 4. AMC | _____ | | _____ |
| 5. AMC | _____ | | _____ |
| 6. AMC | _____ | | _____ |
| 7. AMC | _____ | | _____ |
| 8. AMC | _____ | | _____ |
| 9. AMC | _____ | | _____ |
| 10. AMC | _____ | | _____ |

List additional claims on the reverse side of this form.

CHECK HERE IF THIS IS A CHANGE OF ADDRESS

CLAIMANT'S NAME: MANHATTEN RESOURCES, INC.

ADDRESS: 110 S. Mesa Drive, Suite 1

CITY: Mesa, STATE: AZ ZIP: 85210

PHONE: 480-969-0500

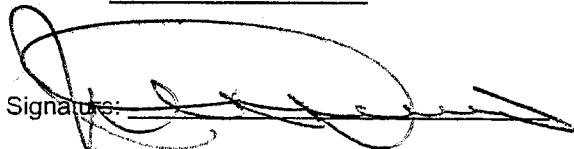
Signature: 

To record with the County, one claimant or an agent must sign.

PHOENIX, ARIZONA
STATE OFFICE
ARIZONA
RECEIVED
BUREAU OF
LAND MANAGEMENT
BLM DATE STAMP
A 10 21

- 11. AMC _____
- 12. AMC _____
- 13. AMC _____
- 14. AMC _____
- 15. AMC _____
- 16. AMC _____
- 17. AMC _____
- 18. AMC _____
- 19. AMC _____
- 20. AMC _____

43 CFR 3833.0-5(e) (August 30, 1994) requires that the names of all of the owners and their current addresses shall be identified on all instruments required to be recorded or filed by the regulation, 43 CFR Subpart 3833.

NAME: _____ ADDRESS: _____
 CITY: _____ STATE: _____ ZIP: _____ IS THIS A NEW ADDRESS ..

NAME: _____ ADDRESS: _____
 CITY: _____ STATE: _____ ZIP: _____ IS THIS A NEW ADDRESS ..

NAME: _____ ADDRESS: _____
 CITY: _____ STATE: _____ ZIP: _____ IS THIS A NEW ADDRESS ..

NAME: _____ ADDRESS: _____
 CITY: _____ STATE: _____ ZIP: _____ IS THIS A NEW ADDRESS ..

January 30, 2003

<p>FOR BLM USE ONLY</p> <p>DATE ENTERED INTO COMPUTER: _____</p> <p>INITIALS: _____ VERIFIED: _____</p>
--

United States Department of the Interior
Bureau of Land Management
 BUSINESS & SUPPORT SVCS DIV
 222 N CENTRAL AVE
 PHOENIX, AZ 85004 -2203
 Phone: (602) 417-9200

Receipt	
No:	745251

Transaction #: 774869	
Date of Transaction: 09/03/2003	
CUSTOMER:	GOLDEN FIDUCIARY GROUP P O BOX 1719 CHANDLER, AZ 85244-1719

LINE #	QTY	DESCRIPTION	REMARKS	UNIT PRICE	TOTAL
1	1.00	LOCATABLE MINERALS / MINING CLAIMS-NOT NEW-UNADJUD, ONE AUTH NO. ONLY / MINING CLAIM MONEY RECEIVED (455) CASES: AMC351224/\$2800.00	MAIN 2004 (28)	- n/a -	2800.00
TOTAL:					\$2,800.00

PAYMENT INFORMATION			
1	AMOUNT:	\$2,800.00	POSTMARKED: 09/02/2003
	TYPE:	CHECK	RECEIVED: 09/03/2003
	CHECK NO:	580	
	NAME:	GOLDEN FIDUCIARY GROUP P O BOX 1719 CHANDLER AZ 85244 1719	

REMARKS

This receipt was generated by the automated BLM Collections and Billing System and is a paper representation of a portion of the official electronic record contained therein.

MAINTENANCE FEE PAYMENT

Mining Claim Maintenance Fee Payment of \$100 per claim or site is due on or before September 1, 2007, in lieu of assessment work for the upcoming assessment year beginning September 1 of the year noted above.

BUREAU OF LAND MANAGEMENT
ARIZONA STATE OFFICE
222 NORTH CENTRAL AVENUE
PHOENIX, AZ 85004
602-417-9200
www.az.blm.gov

FOR BLM USE ONLY	
NO. OF CLAIMS: <u>19</u>	X \$100 = \$ <u>1,900.⁰⁰</u>
RECEIPT NO.: <u>552308</u>	CHECK NO.: <u>499</u>
INIT: <u>JMC</u>	

BLM SERIAL
NUMBERS

NAME OF CLAIMS/SITES

- 1. AMC See Attached
- 2. AMC _____
- 3. AMC _____
- 4. AMC _____
- 5. AMC _____
- 6. AMC _____
- 7. AMC _____
- 8. AMC _____
- 9. AMC _____
- 10. AMC _____

List additional claims on the reverse side of this form.

CHECK HERE IF THIS IS A CHANGE OF ADDRESS

CLAIMANT'S NAME: MANHATTEN RESOURCES, INC.
ADDRESS: 110 S. Mesa Drive, Suite 1
CITY: Mesa STATE: AZ ZIP: 85210
PHONE: 480-969-0500

Signature: [Handwritten Signature]
To record with the County, one claimant or an agent must sign.

PHOENIX, ARIZONA
RECEIVED BLM, AZ STATE OFFICE SEP 11 2007

10/12/07
VERIFIED

GOLDEN HILLSIDE: The following Lode Claims are located in the Superstition Mining District, Sections 25, 26, 35 and 36, in Township 2N, Range 8E, in Maricopa County, Arizona.

<u>BLM SERIAL NUMBERS</u>	<u>NAMES OF CLAIMS/SITES</u>	<u>CLAIMANT(S) NAME</u>
AMC 31512	Golden Hillside	Manhattan Resources, Inc.
AMC 31513	Golden Hillside #2	Manhattan Resources, Inc.
AMC 31514	Golden Hillside #3	Manhattan Resources, Inc.
AMC 31515	Golden Hillside #4	Manhattan Resources, Inc.
AMC 31516	Golden Hillside #5	Manhattan Resources, Inc.
AMC 344010	Golden Hillside #6	Manhattan Resources, Inc.
AMC 344011	Golden Hillside #7	Manhattan Resources, Inc.
AMC 344012	Golden Hillside #8	Manhattan Resources, Inc.
AMC 344013	Golden Hillside #9	Manhattan Resources, Inc.
AMC 344014	Golden Hillside #10	Manhattan Resources, Inc.
AMC 344015	Golden Hillside #11	Manhattan Resources, Inc.
AMC 344016	Golden Hillside #12	Manhattan Resources, Inc.
AMC 344017	Golden Hillside #13-A	Manhattan Resources, Inc.
AMC 344018	Golden Hillside #14	Manhattan Resources, Inc.
AMC 344019	Golden Hillside #15	Manhattan Resources, Inc.
AMC 344020	Golden Hillside #16	Manhattan Resources, Inc.
AMC 344021	Golden Hillside #23	Manhattan Resources, Inc.
AMC 344022	Golden Hillside #24	Manhattan Resources, Inc.
AMC 344023	Golden Hillside #25	Manhattan Resources, Inc.

PHOENIX, ARIZONA
 2002 AUG 29 P 3 12
 RECEIVED
 B.L.M. AZ STATE OFFICE

MAINTENANCE FEE PAYMENT

Mining Claim Maintenance Fee Payment of \$100 per claim or site is due on or before September 1, 2002 in lieu of assessment work for the upcoming assessment year beginning September 1 of the year noted above.

BUREAU OF LAND MANAGEMENT
ARIZONA STATE OFFICE
222 NORTH CENTRAL AVENUE
PHOENIX, AZ 85004
602-417-9200
www.az.blm.gov

FOR BLM USE ONLY	
NO. OF CLAIMS: <u>9</u>	X \$100 = \$ <u>900.00</u>
RECEIPT NO.: <u>552208</u>	CHECK NO.: <u>1199</u>
INIT: <u>mic</u>	

BLM SERIAL
NUMBERS

NAME OF CLAIMS/SITES

- 1. AMC See Attached
- 2. AMC _____
- 3. AMC _____
- 4. AMC _____
- 5. AMC _____
- 6. AMC _____
- 7. AMC _____
- 8. AMC _____
- 9. AMC _____
- 10. AMC _____

List additional claims on the reverse side of this form.

CHECK HERE IF THIS IS A CHANGE OF ADDRESS

CLAIMANT'S NAME: MANHATTEN RESOURCES, INC.
ADDRESS: 110 S. Mesa Drive, Suite 1
CITY: Mesa STATE: AZ ZIP: 85210
PHONE: 480-969-0500

Signature: J. Gerald Chittorf
To record with the County, one claimant or an agent must sign.

PHOENIX, ARIZONA
RECEIVED BLM, AZ STATE OFFICE 2002 AUG 28 11 17 AM

RECEIVED
BLM, AZ STATE OFFICE

DIABLO MINING CLAIMS: The following Lode Claims are located in the Tumacacori Mining District, Sections 5, 6 and 32, in Township 21-S, Range 12-E, of the Gila and Salt River Base, 2nd Meridian, Santa Cruz County, Arizona.

<u>BLM SERIAL NUMBERS</u>	<u>NAMES OF CLAIMS/SITES</u>	<u>CLAIMANT(S) NAME</u>
AMC 351224	Diablo #1	Manhattan Resources, Inc.
AMC 351225	Diablo #2	Manhattan Resources, Inc.
AMC 351226	Diablo #3	Manhattan Resources, Inc.
AMC 351227	Diablo #4	Manhattan Resources, Inc.
AMC 351228	Diablo #5	Manhattan Resources, Inc.
AMC 351229	Diablo #6	Manhattan Resources, Inc.
AMC 351230	Diablo #7	Manhattan Resources, Inc.
AMC 351231	Diablo #8	Manhattan Resources, Inc.
AMC 351232	Diablo #9	Manhattan Resources, Inc.

RECEIVED
B.L.M. AZ STATE OFFICE
2002 AUG 29 P 3:11
PHOENIX, ARIZONA

United States Department of the Interior
Bureau of Land Management
 BUSINESS & SUPPORT SVCS DIV
 222 N CENTRAL AVE
 PHOENIX, AZ 85004 -2203
 Phone: (602) 417-9200

Receipt	
No:	552208

Transaction #: 576927
Date of Transaction: 08/29/2002
CUSTOMER: MANHATTEN RESOURCES INC 110 S MESA DR STE 1 MESA, AZ 85210

LINE #	QTY	DESCRIPTION	REMARKS	UNIT PRICE	TOTAL
1	1.00	LOCATABLE MINERALS / MINING CLAIMS-NOT NEW-UNADJUD, ONE AUTH NO. ONLY / MINING CLAIM MONEY RECEIVED (455) CASES: AMC31512/\$2800.00	MAINT 2003 (28)	- n/a -	2800.00
TOTAL:					\$2,800.00

PAYMENT INFORMATION			
1	AMOUNT:	\$2,800.00	POSTMARKED: N/A
	TYPE:	CHECK	RECEIVED: 08/29/2002
	CHECK NO:	499	
	NAME:	GOLDEN FIDUCIARY GRP BOX 1719 CHANDLER AZ 85244	

REMARKS

This receipt was generated by the automated BLM Collections and Billing System and is a paper representation of a portion of the official electronic record contained therein.

MANHATTEN RESOURCES, INC.
 110 SOUTH MESA DRIVE
 SUITE 1
 MESA, ARIZONA 85210
 (480) 969-0500

August 29, 2000

Bureau of Land Management
 Arizona State Office
 222 North Central Avenue
 Phoenix, AZ 85004

RECEIVED
 BLM ARIZONA STATE OFFICE
 2000 AUG 31 A 11:06
 PHOENIX, ARIZONA

RE: Maintenance Fee Payment

Gentlemen:

Please accept our check in the amount of Two Thousand Eight Hundred Dollars (\$2,800.00) for the twenty-eight (28) claims known as the Golden Hillside Claims and Diablo Mining Claims, for the maintenance payment for the year beginning September 1, 2000 to August 31, 2001. The name of the claims, AMC numbers and counties are as follows:

GOLDEN HILLSIDE: The following Lode Claims are located in the Superstition Mining District, Sections 25, 26, 35 and 36, in Township 2N, Range 8E, in Maricopa County, Arizona.

<u>BLM SERIAL NUMBERS</u>	<u>NAMES OF CLAIMS/SITES</u>	<u>CLAIMANT(S) NAME</u>
AMC 31512	Golden Hillside	Manhattan Resources, Inc.
AMC 34413 <i>31513</i>	Golden Hillside #2	Manhattan Resources, Inc.
AMC 34414 <i>31514</i>	Golden Hillside #3	Manhattan Resources, Inc.
AMC 34415 <i>31515</i>	Golden Hillside #4	Manhattan Resources, Inc.
AMC 34416 <i>31514</i>	Golden Hillside #5	Manhattan Resources, Inc.
AMC 344010	Golden Hillside #6	Manhattan Resources, Inc.
AMC 344011	Golden Hillside #7	Manhattan Resources, Inc.
AMC 344012	Golden Hillside #8	Manhattan Resources, Inc.
AMC 344013	Golden Hillside #9	Manhattan Resources, Inc.
AMC 344014	Golden Hillside #10	Manhattan Resources, Inc.
AMC 344015	Golden Hillside #11	Manhattan Resources, Inc.
AMC 344016	Golden Hillside #12	Manhattan Resources, Inc.
AMC 344017	Golden Hillside #13-A	Manhattan Resources, Inc.
AMC 344018	Golden Hillside #14	Manhattan Resources, Inc.
AMC 344019	Golden Hillside #15	Manhattan Resources, Inc.
AMC 344020	Golden Hillside #16	Manhattan Resources, Inc.
AMC 344021	Golden Hillside #23	Manhattan Resources, Inc.
AMC 344022	Golden Hillside #24	Manhattan Resources, Inc.
AMC 344023	Golden Hillside #25	Manhattan Resources, Inc.

J. P. 10/19/00
 ENTERED IN COMPUTER
 10-19-00

DIABLO MINING CLAIMS: The following Lode Claims are located in the Tumacacori Mining District, Sections 5, 6 and 32, in Township 21-S, Range 12-E, of the Gila and Salt River Base, 2nd Meridian, Santa Cruz County, Arizona.

<u>BLM SERIAL NUMBERS</u>	<u>NAMES OF CLAIMS/SITES</u>	<u>CLAIMANT(S) NAME</u>
AMC 320074 351224	Diablo #1	Manhattan Resources, Inc.
AMC 320075 351225	Diablo #2	Manhattan Resources, Inc.
AMC 320076 351226	Diablo #3	Manhattan Resources, Inc.
AMC 320077 351227	Diablo #4	Manhattan Resources, Inc.
AMC 320078 351228	Diablo #5	Manhattan Resources, Inc.
AMC 320079 351229	Diablo #6	Manhattan Resources, Inc.
AMC 320080 351230	Diablo #7	Manhattan Resources, Inc.
AMC 320081 351231	Diablo #8	Manhattan Resources, Inc.
AMC 320082 351232	Diablo #9	Manhattan Resources, Inc.

Claimant's name, Manhattan Resources, Inc., 110 S. Mesa Drive, Suite 1, Mesa, Arizona 85210, telephone number 480-969-0500 and facsimile number 480-969-7056.

Sincerely,

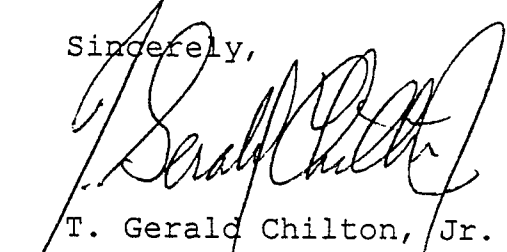

T. Gerald Chilton, Jr.

TGC/mm

PHOENIX, ARIZONA

2000 AUG 31 11:06

RECEIVED
BLM AND STATE OFFICE

10/19/00
ENTERED IN COMPUTER
10/19/00

MAINTENANCE FEE PAYMENT Sept. 01, 2000 to Aug. 31, 2001

\$100.00 MAINTENANCE FEE PAYMENT DUE ON OR BEFORE AUGUST 31, 19__
 IN LIEU OF ASSESSMENT WORK FOR THE UPCOMING ASSESSMENT
 YEAR BEGINNING SEPTEMBER 1 OF THE YEAR NOTED ABOVE.

BUREAU OF LAND MANAGEMENT
 ARIZONA STATE OFFICE
 222 NORTH CENTRAL AVENUE
 PHOENIX, AZ 85004-2003

COUNT: 28 \$ 2800. INT: KE
 FOR OFFICIAL USE ONLY

THE CLAIMS ARE SITUATED IN Santa Cruz COUNTY, ARIZONA.

BLM SERIAL NUMBERS 351224 NAMES OF CLAIMS OR SITES
 A MC 320074 THRU A MC 320082 Diablo #1-Diablo #9
 COUNTY BOOK/DOCKET _____, PAGE(S) OR FEE NO(S) _____
 A MC _____ THRU A MC _____
 COUNTY BOOK/DOCKET _____, PAGE(S) OR FEE NO(S) _____

(OR) IF NOT CONSECUTIVE NUMBERS LIST SEPARATELY BELOW:

BLM SERIAL NUMBERS	NAME OF CLAIMS/SITES	COUNTY BOOK/DOCKET & PAGE OR FEE NUMBER
A MC <u>SEE ATTACHED</u>		
A MC _____		
A MC _____		
A MC _____		
A MC _____		
A MC _____		
A MC _____		
A MC _____		
A MC _____		
A MC _____		
A MC _____		
A MC _____		
A MC _____		
A MC _____		
A MC _____		

CLAIMANT'S NAME: MANHATTEN RESOURCES, INC.
 ADDRESS: 110 S. Mesa Dr., #1 CITY: Mesa STATE: ARIZONA

CHECK HERE IF THIS IS A CHANGE OF ADDRESS
 PHONE: 480 969-0500 ZIP: 85210

SIGNATURE: [Signature]
 TO RECORD WITH THE COUNTY, ONE CLAIMANT OR THE AGENT MUST SIGN

LIST ALL ADDITIONAL OWNERS ON REVERSE SIDE OF THIS FORM
 FOR OFFICIAL USE ONLY
 ENTERED INTO COMPUTER: [Signature] [Signature] 10/19/00
 DATE INITIALS VERIFIED

2000 AUG 31 11:09 AM
 RECEIVED
 B.L.M. AZ STATE OFFICE

43 CFR 3833.0-5(c) (August 30, 1994) REQUIRES THAT THE NAMES OF ALL OF THE OWNERS AND THEIR CURRENT ADDRESSES SHALL BE IDENTIFIED ON ALL INSTRUMENTS REQUIRED TO BE RECORDED OR FILED BY THE REGULATIONS, 43 CFR SUBPART 3833.

CLAIMANT'S NAME: _____
ADDRESS: _____ CITY: _____ STATE: _____
 CHECK HERE IF THIS PHONE: () _____ ZIP: _____ IS
CHANGE OF ADDRESS

CLAIMANT'S NAME: _____
ADDRESS: _____ CITY: _____ STATE: _____
 CHECK HERE IF THIS PHONE: () _____ ZIP: _____ IS
CHANGE OF ADDRESS

CLAIMANT'S NAME: _____
ADDRESS: _____ CITY: _____ STATE: _____
 CHECK HERE IF THIS PHONE: () _____ ZIP: _____ IS
CHANGE OF ADDRESS

CLAIMANT'S NAME: _____
ADDRESS: _____ CITY: _____ STATE: _____
 CHECK HERE IF THIS PHONE: () _____ ZIP: _____ IS
CHANGE OF ADDRESS

CLAIMANT'S NAME: _____
ADDRESS: _____ CITY: _____ STATE: _____
 CHECK HERE IF THIS PHONE: () _____ ZIP: _____ IS
CHANGE OF ADDRESS

CLAIMANT'S NAME: _____
ADDRESS: _____ CITY: _____ STATE: _____
 CHECK HERE IF THIS PHONE: () _____ ZIP: _____ IS
CHANGE OF ADDRESS

CLAIMANT'S NAME: _____
ADDRESS: _____ CITY: _____ STATE: _____
 CHECK HERE IF THIS PHONE: () _____ ZIP: _____ IS
CHANGE OF ADDRESS

CLAIMANT'S NAME: _____
ADDRESS: _____ CITY: _____ STATE: _____
 CHECK HERE IF THIS PHONE: () _____ ZIP: _____ IS
CHANGE OF ADDRESS

2000 AUG 31 A 11: 06

RECEIVED
B.L. MISTRI
STATE OFFICE
PHOENIX, ARIZONA

United States Department of the Interior
Bureau of Land Management
 BUSINESS & SUPPORT SVCS DIV
 222 N CENTRAL AVE
 PHOENIX, AZ 85004 -2203
 Phone: (602) 417-9200

Receipt	
No:	181057

Transaction #: 194354
Date of Transaction: 08/31/2000

LINE #	QTY	COMMODITY / SUBJECT / ACTION / PRODUCT	REMARKS	UNIT PRICE	TOTAL
1	1	LOCATABLE MINERALS / MINING CLAIMS-ACCOUNTS/UNADJUDICATED / MINING CLAIM MONEY RECEIVED (455)	MAINT 2001 (28)	- n/a -	\$2,800.00
TOTAL:					\$2,800.00

PAYMENT INFORMATION			
1	AMOUNT:	\$2,800.00	POSTMARKED: N/A
	TYPE:	CHECK	RECEIVED: 08/31/2000
	CHECK NO:	309	
	NAME:	MANHATTAN RESOURECS, INC. 110 S. MESA DR. #1 MESA AZ 85210	

REMARKS

CASE SERIAL NUMBER INFORMATION		
TRNS #	LINE #	CASES
194354	1	AMC31512

This receipt was generated by the automated BLM Collections and Billings System and is a paper representation of a portion of the official electronic record contained therein.

MANHATTAN RESOURCES, INC.
 1256 W. Chandler Blvd. Suite #29
 Chandler, Arizona 85224
 August 27, 1999

31512
 344010
 320074
 50

TO: BUREAU OF LAND MANAGEMENT
 ARIZONA STATE OFFICE
 222 N. Central Avenue
 Phoenix, Arizona 85004

Gentlemen:

28 Claims = \$2,800.00

RE: MAINTENANCE FEE PAYMENT: Please accept our checks in the amount of Two Thousand-Eight-Hundred Dollars (\$2,800.00) for the twenty (28) Claims known as the Golden Hillside Claims and Diablo Mining Claims, for the maintenance payment for the year beginning September 1, 1999 to August 31, 2000 ~~1999~~, and the name of the Claims, AMC Numbers and Counties are as follows:

THE CLAIMS ARE SITUATED IN MARICOPA COUNTY, ARIZONA.

BLM SERIAL NUMBERS NAMES OF CLAIMS/SITES CLAIMANT/S NAME

AMC 31512	<i>AMC</i> 31513 31514 31515 31516	GOLDEN HILLSIDE	MANHATTAN RESOURCES, INC.
AMC 34413		GOLDEN HILLSIDE #2	MANHATTAN RESOURCES, INC.
AMC 34414		GOLDEN HILLSIDE #3	MANHATTAN RESOURCES, INC.
AMC 34415		GOLDEN HILLSIDE #4	MANHATTAN RESOURCES, INC.
AMC 34416		GOLDEN HILLSIDE #5	MANHATTAN RESOURCES, INC.
AMC 344010		GOLDEN HILLSIDE #6	MANHATTAN RESOURCES, INC.
AMC 344011		GOLDEN HILLSIDE #7	MANHATTAN RESOURCES, INC.
AMC 344012		GOLDEN HILLSIDE #8	MANHATTAN RESOURCES, INC.
AMC 344013		GOLDEN HILLSIDE #9	MANHATTAN RESOURCES, INC.
AMC 344014		GOLDEN HILLSIDE #10	MANHATTAN RESOURCES, INC.
AMC 344015		GOLDEN HILLSIDE #11	MANHATTAN RESOURCES, INC.
AMC 344016		GOLDEN HILLSIDE #12	MANHATTAN RESOURCES, INC.
AMC 344017		GOLDEN HILLSIDE #13-A	MANHATTAN RESOURCES, INC.
AMC 344018		GOLDEN HILLSIDE #14	MANHATTAN RESOURCES, INC.
AMC 344019		GOLDEN HILLSIDE #15	MANHATTAN RESOURCES, INC.
AMC 344020		GOLDEN HILLSIDE #16	MANHATTAN RESOURCES, INC.
AMC 344021		GOLDEN HILLSIDE #23	MANHATTAN RESOURCES, INC.
AMC 344022		GOLDEN HILLSIDE #24	MANHATTAN RESOURCES, INC.
AMC 344023		GOLDEN HILLSIDE #25	MANHATTAN RESOURCES, INC.

The above mentioned Lode Claims are located in the Superstition Mining District, Sections: 25,26,35 and 36, in Township 2N, Range 8E., in Maricopa County, Arizona.

DIABLO MINING CLAIMS: THE CLAIMS ARE SITUATED IN MARICOPA COUNTY, ARIZONA

BLM SERIAL NUMBERS NAMES OF CLAIMS/SITES CLAIMANT/S NAME

<i>AMC</i> 351224	AMC 320074	DIABLO #1	MANHATTAN RESOURCES, INC.
351225	AMC 320075	DIABLO #2	MANHATTAN RESOURCES, INC.
351226	AMC 320076	DIABLO #3	MANHATTAN RESOURCES, INC.
351227	AMC 320077	DIABLO #4	MANHATTAN RESOURCES, INC.
351228	AMC 320078	DIABLO #5	MANHATTAN RESOURCES, INC.
351229	AMC 320079	DIABLO #6	MANHATTAN RESOURCES, INC.
351230	AMC 320080	DIABLO #7	MANHATTAN RESOURCES, INC.
351231	AMC 320081	DIABLO #8	MANHATTAN RESOURCES, INC.
351232	AMC 320082	DIABLO #9	MANHATTAN RESOURCES, INC.

RECEIVED
 B.L.M. AZ STATE OFFICE
 1999 AUG 31 A 11:11
 PHOENIX, ARIZONA

The above mentioned Lode Claims are located in the TUMACACORI MINING DISTRICT, Sections: 5,6 and 32, in Township 21-S, Range 12-E, of the Gila & Salt River Base, 2nd Meridian, Santa Cruz County, Arizona. CLAIMANT'S NAME: MANHATTAN RESOURCES, INC., ADDRESS: 1256 W. Chandler Blvd. Suite #29, CITY: Chandler, STATE: Arizona ZIP: 85224; PHONE NO's: 602 897-9645 or 602 963-3645

Sincerely,

MANHATTAN RESOURCES, INC.

Jack L. Davis,
 President

ENTERED IN COMPUTER

10/20/99 *sc*

CLAIM INDEX

<u>SERIAL NUMBER</u>	<u>CLAIM NAME</u>	<u>CLAIMANT'S NAME</u>
AMC 31512	GOLDEN HILLSIDE	MANHATTAN RESOURCES, INC.
AMC 34413	GOLDEN HILLSIDE #2	MANHATTAN RESOURCES, INC.
AMC 34414	GOLDEN HILLSIDE #3	MANHATTAN RESOURCES, INC.
AMC 34415	GOLDEN HILLSIDE #4	MANHATTAN RESOURCES, INC.
AMC 34416	GOLDEN HILLSIDE #5	MANHATTAN RESOURCES, INC.
AMC 344010	GOLDEN HILLSIDE #6	MANHATTAN RESOURCES, INC.
AMC 344011	GOLDEN HILLSIDE #7	MANHATTAN RESOURCES, INC.
AMC 344012	GOLDEN HILLSIDE #8	MANHATTAN RESOURCES, INC.
AMC 344013	GOLDEN HILLSIDE #9	MANHATTAN RESOURCES, INC.
AMC 344014	GOLDEN HILLSIDE #10	MANHATTAN RESOURCES, INC.
AMC 344015	GOLDEN HILLSIDE #11	MANHATTAN RESOURCES, INC.
AMC 344016	GOLDEN HILLSIDE #12	MANHATTAN RESOURCES, INC.
AMC 344017	GOLDEN HILLSIDE #13-A	MANHATTAN RESOURCES, INC.
AMC 344018	GOLDEN HILLSIDE #14	MANHATTAN RESOURCES, INC.
AMC 344019	GOLDEN HILLSIDE #15	MANHATTAN RESOURCES, INC.
AMC 344020	GOLDEN HILLSIDE #16	MANHATTAN RESOURCES, INC.
AMC 344021	GOLDEN HILLSIDE #23	MANHATTAN RESOURCES, INC.
AMC 344022	GOLDEN HILLSIDE #24	MANHATTAN RESOURCES, INC.
AMC 344023	GOLDEN HILLSIDE #25	MANHATTAN RESOURCES, INC.

<u>SERIAL NUMBER</u>	<u>CLAIM NAME</u>	<u>CLAIMANT'S NAME</u>
AMC 320074	DIABLO #1	MANHATTAN RESOURCES, INC.
AMC 320075	DIABLO #2	MANHATTAN RESOURCES, INC.
AMC 320076	DIABLO #3	MANHATTAN RESOURCES, INC.
AMC 320077	DIABLO #4	MANHATTAN RESOURCES, INC.
AMC 320078	DIABLO #5	MANHATTAN RESOURCES, INC.
AMC 320079	DIABLO #6	MANHATTAN RESOURCES, INC.
AMC 320080	DIABLO #7	MANHATTAN RESOURCES, INC.
AMC 320081	DIABLO #8	MANHATTAN RESOURCES, INC.
AMC 320082	DIABLO #9	MANHATTAN RESOURCES, INC.

RECEIVED
B.L.M. AZ STATE OFFICE
1999 AUG 31 A 11:11
PHOENIX, ARIZONA

MANHATTAN RESOURCES, INC.
1256 W. Chandler Blvd. Suite #29
Chandler, Arizona 85224

UNITED STATES
DEPARTMENT OF THE INTERIOR
BUREAU OF LAND MANAGEMENT

RECEIPT AND ACCOUNTING ADVICE

No. 2348120 04

TC/AZ

08/31/99

Subject: CLAIM MAINTENANCE FEE 2000 - 20 2 51 13 2,400.00 ✓

Applicant:

MANHATTAN RESOURCES INC
1256 W CHANDLER BLVD STE 29
CHANDLER AZ 85224

Remitter: TRANSAMERT LEASING & INVESTMENTS - 1001
\$1,400.00/618 244-3318
GOLDEN FIDUCIARY GRP - 205
\$1,400.00

Assignor:

LEASE MANAGEMENT DATA NEW UPDATE PAYMENT

ORIGINAL SERIAL NO.	ASG.	TYPE	ST.	CTY.	FUND SYMBOL	ACRES/UNITS	RATE
ANC 31512, ET AL							

AMOUNT	ANV. DATE	EXP. DATE	BILL CYC.	S/C	DISTRICT	NEXT BILL	MISC. DATA	U of M	ACTUAL UNITS

ASSIGNMENT SERIAL NO.	ASG.	TYPE	ST.	CTY.	FUND SYMBOL	ACRES/UNITS	RATE

AMOUNT	ANV. DATE	EXP. DATE	BILL CYC.	S/C	DISTRICT	NEXT BILL	MISC. DATA	U of M	ACTUAL UNITS

APPLY REMITTANCE

ACTION	FUND SYMBOL	CTY.	AMOUNT
FILING FEE			
RENTAL			
UNEARNED			
REFUND			
TOTAL			
AMOUNT DUE			

Remarks:

BY:

DATE:

- Lease in Escrow?
- KGS? Of Interest?
- Auto Escalates? Operating Rights?
- Auto Renew? Operator
- Bond Filed?

FOR MMS USE ONLY

BILLEE	FOREST REFUGE
NUMBER	
OCS SECTION	
CODE	

UNITED STATES DEPARTMENT OF THE INTERIOR
BUREAU OF LAND MANAGEMENT
ARIZONA STATE OFFICE

IN REPLY REFER TO:

AMC 31512

320074

351224

Memorandum

To: Case File

From: *Mary Hyde*

Subject: Documentation of Telephone Conversation

Name of Person Contacted: *Jack Davis*

Telephone Number of Person Contacted: ~~##~~ *Office Visit*

Date of Contact: *10/19/00*

Summary: *Jack came into the office today re. maintenance fee payment. Old serial numbers had been used on the payment form. Correct serial numbers have been identified.*
Mary

NOTICE!!

These documents have been scanned!

Do not place un-scanned documents beneath this notice!

Do not remove this notice from this file!

GPO Jacket No. 560-102
Print Order 61540
Rise Business Services, LLC
Job=AZ15 7/3/2019



Box Number= AZ15141



Claim Begin-End: AMC351224-AMC351232

5 Miscellaneous



AZ15141-3 AMC351149-AMC351598

**NO
DOCUMENTS
FOUND**

NO DOCUMENTS FOUND
NO DOCUMENTS FOUND

NOTICE!!

These documents have been scanned!

Do not place un-scanned documents beneath this notice!

Do not remove this notice from this file!

GPO Jacket No. 560-102
Print Order 61540
Rise Business Services, LLC
Job=AZ15 7/3/2019



Box Number= AZ15141



Claim Begin-End: AMC351224-AMC351232

6 Location Notices-Amendments and Supporting Documents



AZ15141-3 AMC351149-AMC351598

|

United States Department of the Interior
BUREAU OF LAND MANAGEMENT
ARIZONA STATE OFFICE
222 North Central Avenue
Phoenix, Arizona 85004-2203

June 24, 1999

In Reply Refer To:
3800 (952.3)

CLAIMANT(S): Manhattan Resources Inc.
 1256 W. Chandler Blvd., Ste 29
 Chandler, Arizona 85224

The enclosed claim index is provided to identify the owner's name, address, and AMC number assigned to the claim(s). If the name and/or address is incorrect, please advise.

You are hereby advised that you have acquired no mineral or surface rights on those portions of the Diablo No. 7 and 8 mining claims in T. 20 S., R. 12 E., Gila and Salt River Meridian, Arizona.

If you have any questions, please call Mining Claims Adjudication at (602) 417-9518.

Enclosure

MINING CLAIM STATUS REPORT

<i>Initial below</i>	
Status checked:	<u>CC</u>
MTP checked:	<u>CC</u>
GEO checked:	<u>CC</u>
Preadjudication:	_____
Final adjudication:	<u>DM 6/21/99</u>

LEAD SERIAL NO. AMC 351224 THROUGH AMC 351232

<u>9</u> LODGE	\$25 x <u>9</u>	= \$ <u>225</u>	(Location fee)	
PLACER	\$10 x <u>9</u>	= \$ <u>90</u>	(Service fee--curable defect)	<u>607</u>
MILL SITE	\$100 x <u>9</u>	= \$ <u>900</u>	(Claim Maintenance fee)	<u>225</u>
TUNNEL SITE		\$ _____	TOTAL FEES	<u>382</u>
ASSOCIATION		\$ _____	Overage <input checked="" type="checkbox"/> Shortage <input checked="" type="checkbox"/>	<u>90</u>
PLACER		\$ <u>3.34</u>	Copy Fees	<u>292</u>
		\$ <u>1218.34</u>	TOTAL RECEIVED	

Over-the-counter: Mail: Timely Filed: YES NO

LEGAL DESCRIPTION: T 215 R 12E S 5,6
 T 205 R 12E S 32
 T _____ R _____ S _____
 T _____ R _____ S _____

COMMENTS: rec'd check for partial filing. Balance on credit and - cred

ADJUDICATION

GENERAL JURISDICTION: BLM or NATIONAL FOREST T21SR12E is in Coronado
 Name _____

SPLIT ESTATE LAND: SX PX SRHE OTHER _____
 Specify _____

WILDERNESS AREA (WA): _____
 Specify _____

CLAIMS SUBJECT TO PL 359: YES NO

PROPER NOTICE FILED IF LOCATING ON SRHE: YES NO

STATUS: PARTIALLY VOID VOID

PRIVATE MINERALS WITHDRAWN OTHER

EXPLANATION: paid for 9 mining claims - there are only 8 location notices here and 1 extra map of location - see Dominic's note - received and entered

COMMENTS: No rights obtained to the portion of claim #7 and 8 that overlay granite land in T1205 R12E S32.

When recorded, mail to:

Name: Jack L. Davis

Address: 1256 W/ Chandler Blvd., Suite 29
Chandler, Az. 85224

City/State/Zip Code: _____



INSTRUMENT #9901052
OFFICIAL RECORDS OF
SANTA CRUZ COUNTY
SUZANNE BAINZ
COUNTY RECORDER
REQUEST OF :

DAVIS, JACK L.
DATE: 02/02/99 TIME: 9.30
FEE: 8.00
DOCK 785 PAGE 48 PAGES: 2

Space above this line for Recorder's use

NOTICE OF MINING CLAIM

DOCK 785 PAGE 48

1. TYPE OF NOTICE: Location Amendment Relocation
2. TYPE OF CLAIM: Placer Lode Millsite Tunnel site
3. The name and address of the Locator is
Name: Manhattan Resources, Inc.
Address: 1256 W. Chandler Blvd., Suite 29
City/State/Zip Code: Chandler, Az. 85283 (85224 - from Zip Code)
4. The name of the claim is Diablo No. 1
5. The date of the location is January 26, 1999
6. The claim is 1500 feet long and 600 feet wide. The distance from the location monument to each end of the claim is 1490 feet in a N. E. direction and 10 feet in a S. W. direction.
7. The general course of the claim is from the S. W. to the N. E.
8. The location of the claim is in Section 5 & 6, Township 21 S, Range 12 E,
Gila & Salt River Base and Meridian,
Tumacacori Mining District, Santa Cruz County,
State of Arizona.
9. If amending or relocating, the previous claim name was _____ recorded in Docket(Book) _____ page(s) _____ Mining District, _____ County, State of _____.
10. The location of the claim with reference to a natural object or permanent monument is (See Map of Approximate location & alignment of the Diablo 1 - 9 Claim Group.)

Dated: February 2, 1999

Jack L. Davis, Resident

1256 W. Chandler Blvd., Suite 29

Chandler, Az. 85224

RECEIVED
BLM AZ STATE OFFICE
1999 FEB 2
JENNIFER RIZZO

RECEIVED
BLM AZ STATE OFFICE
© 1994 ALPHA PUBLICATIONS OF AMERICA, INC.
All Rights Reserved

T. 20 S.

SEC. 31

SEC. 32

DOCK 785 PAGE 49

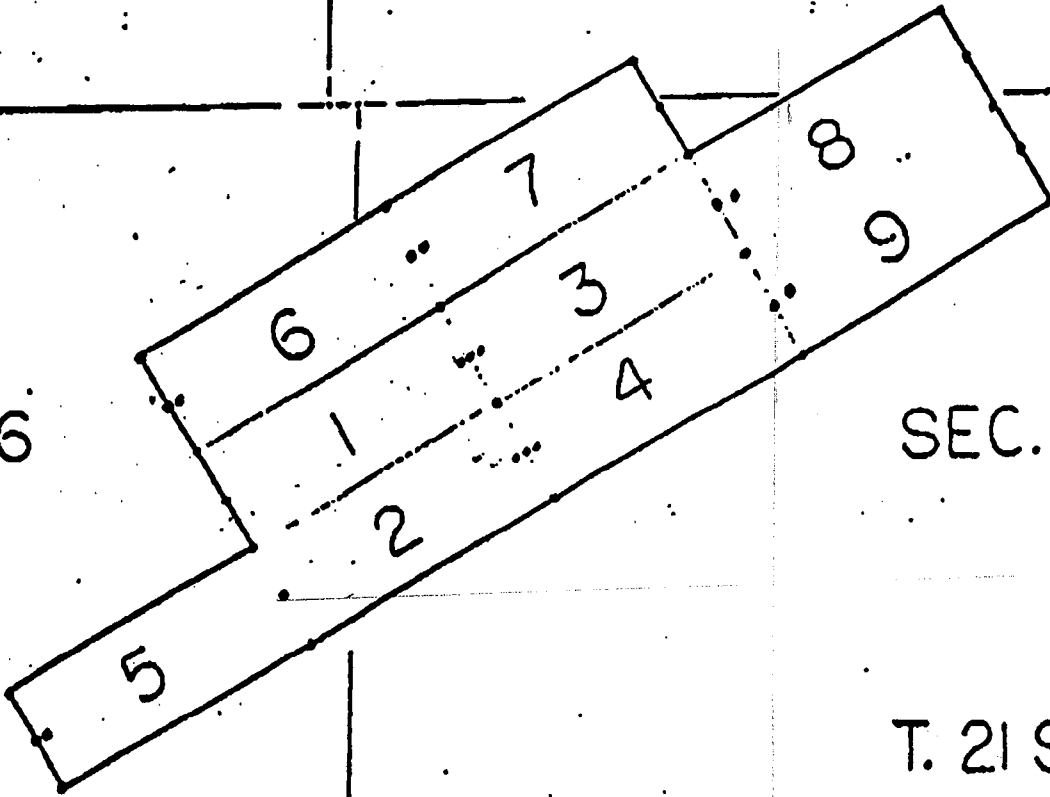

SEC. 6

SEC. 5

T. 21 S.

R. 12 E

A. NO. 351274

APPROXIMATE LOCATION AND ALIGNMENT
OF THE DIABLO 1-9 CLAIM GROUP
SANTA CRUZ CO., ARIZONA

RECEIVED
B.L.M. AZ STATE OFFICE
PHOENIX, ARIZONA
FEB - 3 A 11: 10

RECEIVED
B.L.M. AZ STATE OFFICE
PHOENIX, ARIZONA
FEB - 4 A 11: 46

When recorded, mail to:

Name: Jack L. Davis, President
Manhattan Resources, Inc.
Address: 1256 W. Chandler Blvd. Suite 29
Chandler, Az. 85224

City/State/Zip Code: _____



INSTRUMENT #9901053
OFFICIAL RECORDS OF
SANTA CRUZ COUNTY
SUZANNE BAINZ
COUNTY RECORDER
REQUEST OF :
DAVIS, JACK L.
DATE: 02/02/99 TIME: 9.30
FEE: 8.00
DOCK 785 PAGE 50 PAGES: 1

Space above this line for Recorder's use

NOTICE OF MINING CLAIM

DOCK 785 PAGE 50

1. TYPE OF NOTICE: Location Amendment Relocation
2. TYPE OF CLAIM: Placer Lode Millsite Tunnel/site
3. The name and address of the Locator is
Name: Manhattan Resources, Inc.
Address: 1256 W. Chandler Blvd., Suite 29
City/State/Zip Code: Chandler, Az. 85283
4. The name of the claim is Diablo No. 2
5. The date of the location is January 26, 1999
6. The claim is 1500 feet long and 600 feet wide. The distance from the location monument to each end of the claim is 1490 feet in a N. E. direction and 10 feet in a S. W. direction.
7. The general course of the claim is from the S. W. to the N. E.
8. The location of the claim is in Section 5 + 6, Township 21 S, Range 12 E, Gila & Salt River Base and Meridian, Tumacacori Mining District, Santa Cruz County, State of Arizona.
9. If amending or relocating, the previous claim name was _____ recorded in Docket(Book) _____ page(s) _____ Mining District, _____ County, State of _____.
10. The location of the claim with reference to a natural object or permanent monument is (See Map of Approximate location & alignment of the Diablo 1 - 9 Claim Group.)

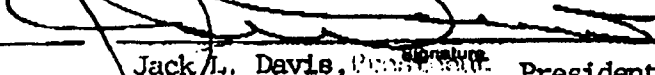
Dated: February 2, 1999

Jack L. Davis, President
1256 W. Chandler Blvd., Suite 29
Chandler, Az. 85224

RECEIVED
 B.L.M. AZ STATE OFFICE
 PHOENIX ARIZONA
 1999 FEB -3 AM 11:11

A MC 351225

RECEIVED
 B.L.M. AZ STATE OFFICE
 PHOENIX ARIZONA
 1999 FEB -3 AM 11:11

T. 20 S.

RECEIVED
B.L.M. AZ STATE OFFICE
1999 FEB -3 A 11:16
PHOENIX, ARIZONA

SEC. 31

SEC. 32

SEC. 6

SEC. 5

A HC 1351225

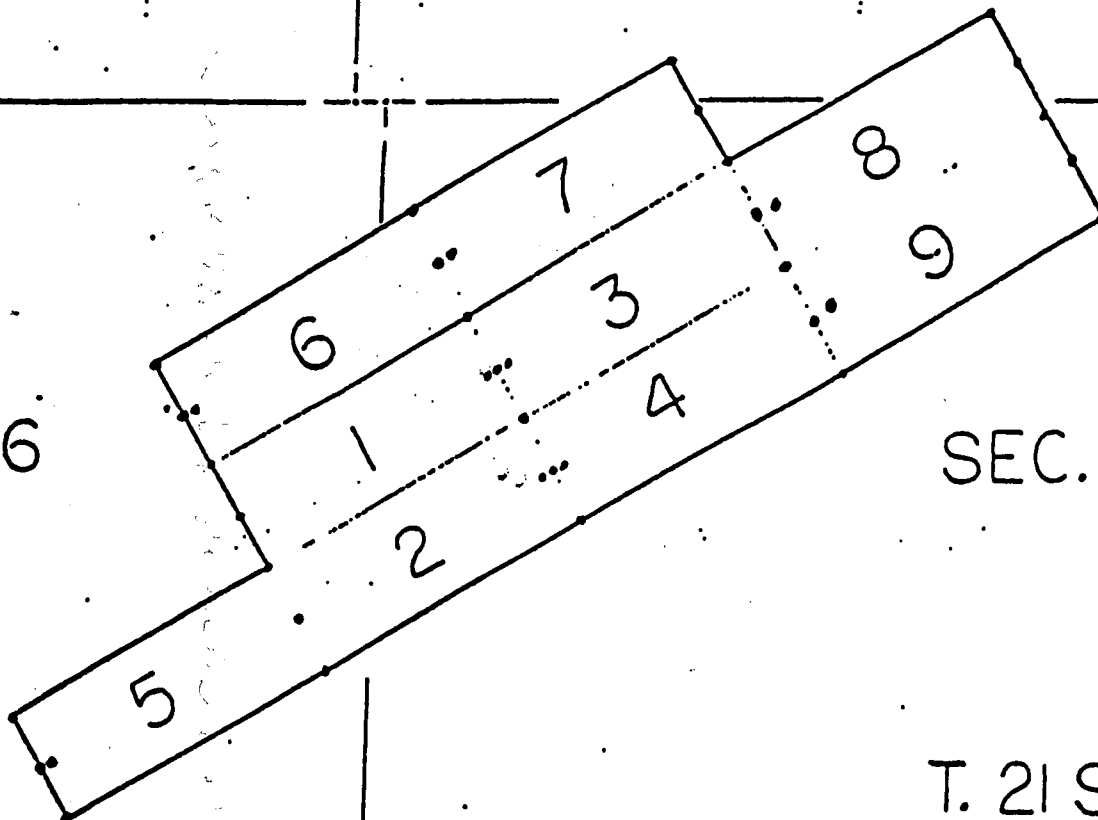

T. 21 S.

~~RECEIVED
B.L.M. AZ STATE OFFICE
1999 FEB -3 A 11:47
PHOENIX, ARIZONA~~

R. 12 E.

APPROXIMATE LOCATION AND ALIGNMENT
OF THE DIABLO 1-9 CLAIM GROUP.
SANTA CRUZ CO., ARIZONA

When recorded, mail to:

Name: Jack L. Davis
Address: 1256 W/ Chandler Blvd., Suite 29
Chandler, Az. 85224

City/State/Zip Code: _____



INSTRUMENT #9901054
OFFICIAL RECORDS OF
SANTA CRUZ COUNTY
BUZANNE SAINZ
COUNTY RECORDER
REQUEST OF :
DAVIS, JACK L.
DATE: 02/02/99 TIME: 9.30
FEE: 8.00
DOCK 785 PAGE 51 PAGES: 1

Space above this line for Recorder's use

NOTICE OF MINING CLAIM

DOCK 785 PAGE 51

1. TYPE OF NOTICE: Location Amendment Relocation
2. TYPE OF CLAIM: Placer Lode Millsite Tunnel site
3. The name and address of the Locator is
Name: Manhattan Resources, Inc.
Address: 1256 W. Chandler Blvd., Suite 29
City/State/Zip Code: Chandler, Az. 85283
4. The name of the claim is Diablo No. 3
5. The date of the location is January 26, 1999
6. The claim is 1500 feet long and 600 feet wide. The distance from the location monument to each end of the claim is 1490 feet in a 10 feet in a S. W. direction and 10 feet in a S. W. direction.
7. The general course of the claim is from the S. W. to the N. E.
8. The location of the claim is in Section 5, Township 21 S Range 12 E
Gila & Salt River Base and Meridian,
Tumacacori Mining District, Santa Cruz County,
State of Arizona.
9. If amending or relocating, the previous claim name was _____
recorded in Docket(Book) _____ page(s) _____
Mining District, _____ County,
State of _____
10. The location of the claim with reference to a natural object or permanent monument is (See Map of Approximate location & alignment of the Diablo 1 - 9 Claim Group.)

RECEIVED
BLM. AZ STATE OFFICE
1999 FEB -3
PHOENIX ARIZONA
N. E. A
I B

A MC 551228

Dated: February 2, 1999

Jack L. Davis, President

1256 W. Chandler Blvd., Suite 29

Chandler, Az. 85224

RECEIVED
BLM. AZ STATE OFFICE
1999 FEB -4
PHOENIX ARIZONA

T. 20 S.

SEC. 31

SEC. 32

PHOENIX, ARIZONA

1999 FEB -3 A 11: 16

RECEIVED
B.L.M. AZ STATE OFFICE

A MC 351226

SEC. 6

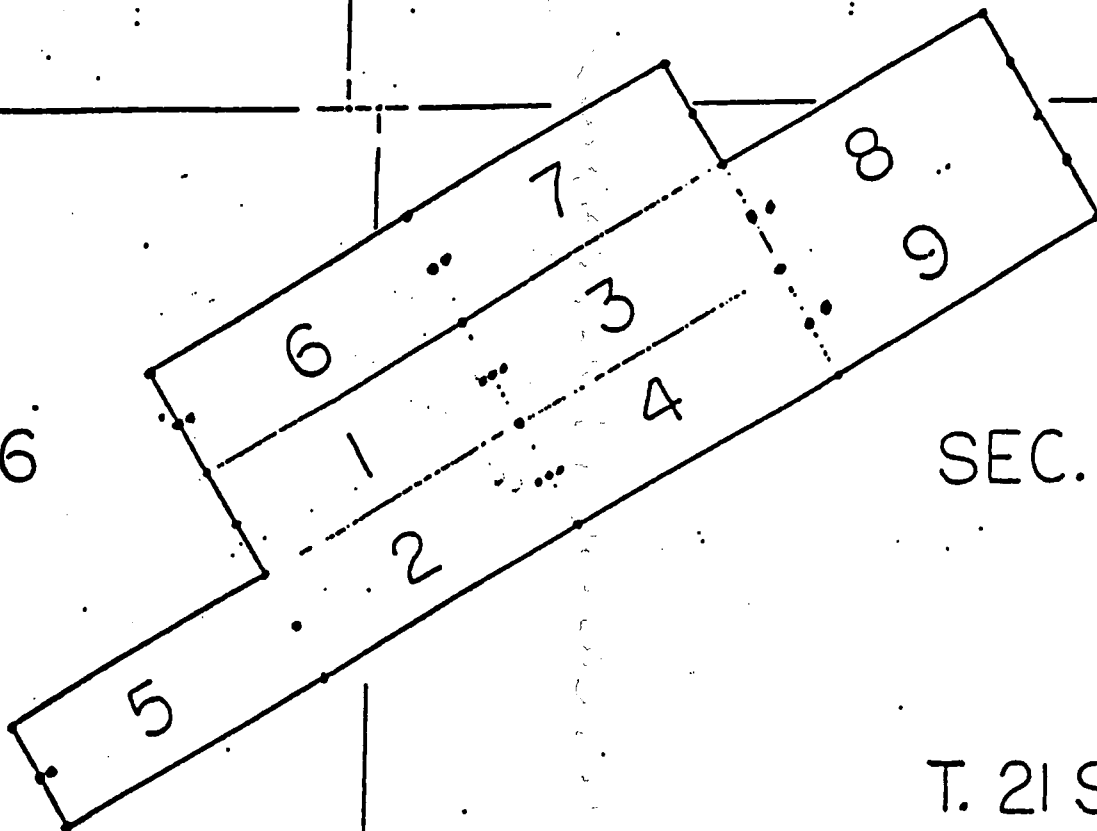

SEC. 5

T. 21 S.

PHOENIX, ARIZONA

1999 FEB -4 A 11: 47

RECEIVED
B.L.M. AZ STATE OFFICE

R. 12 E.

APPROXIMATE LOCATION AND ALIGNMENT
OF THE DIABLO 1-9 CLAIM GROUP.
SANTA CRUZ CO., ARIZONA

When recorded, mail to:

Name: Jack L. Davis
Address: 1256 W/ Chandler Blvd., Suite 29
Chandler, Az. 85224
City/State/Zip Code: _____



INSTRUMENT #9901055
OFFICIAL RECORDS OF
SANTA CRUZ COUNTY
SUZANNE BAINZ
COUNTY RECORDER
REQUEST OF :

DAVIS, JACK L.
DATE: 02/02/99 TIME: 9.30
FEE: 8.00
DOCK 785 PAGE 52 PAGEB: 1

Space above this line for Recorder's use

NOTICE OF MINING CLAIM

DOCK 785 PAGE 52

1. TYPE OF NOTICE: Location Amendment Relocation
2. TYPE OF CLAIM: Placer Lode Millsite Tunnelite
3. The name and address of the Locator is
Name: Manhattan Resources, Inc.
Address: 1256 W. Chandler Blvd., Suite 29
City/State/Zip Code: Chandler, Az. 85283
4. The name of the claim is Diablo No. 4
5. The date of the location is January 26, 1999
6. The claim is 1500 feet long and 600 feet wide. The distance from the location monument to each end of the claim is 1490 feet in a N. E. direction and 10 feet in a S. W. direction.
7. The general course of the claim is from the S. W. to the N. E.
8. The location of the claim is in Section 5, Township 21 S Range 12 E
Gila & Salt River Base and Meridian,
Tumacacori Mining District, Santa Cruz County,
State of Arizona.
9. If amending or relocating, the previous claim name was _____ recorded in Docket(Book) _____ page(s) _____ Mining District, _____ County, State of _____.
10. The location of the claim with reference to a natural object or permanent monument is (See Map of Approximate location & alignment of the Diablo 1 - 9 Claim Group, _____)

RECEIVED
BLM. AZ STATE OFFICE
1999 FEB - 3
PHOENIX ARIZONA

7 AC 351227

Dated: February 2, 1999

1999 FEB - 4 - 11:47

RECEIVED
BLM. AZ STATE OFFICE

Jack L. Davis, President

1256 W. Chandler Blvd., Suite 29

Chandler, Az. 85224

T. 20 S.

SEC. 31

SEC. 32

PHOENIX, ARIZONA

1999 FEB -3 A 11: 17

RECEIVED
B.L.M. AZ STATE OFFICE

A MC 351227

SEC. 6

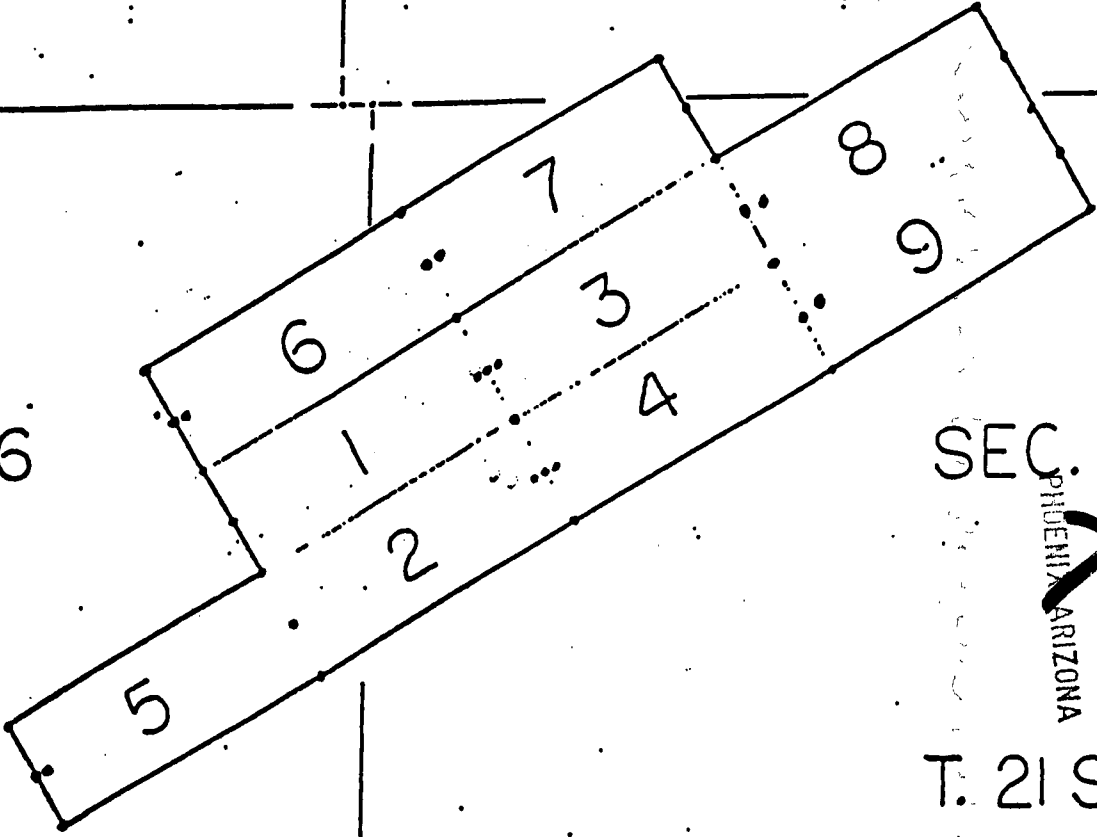

SEC

PHOENIX, ARIZONA

~~1999 FEB -4 A 11: 47~~

~~RECEIVED
B.L.M. AZ STATE OFFICE~~

T. 21 S.

R. 12 E.

APPROXIMATE LOCATION AND ALIGNMENT
OF THE DIABLO 1-9 CLAIM GROUP.
SANTA CRUZ CO., ARIZONA

When recorded, mail to:

Name: Jack L. Davis

Address: 1256 W/ Chandler Blvd., Suite 29
Chandler, Az. 85224

City/State/Zip Code: _____



INSTRUMENT #9901056
OFFICIAL RECORDS OF
SANTA CRUZ COUNTY
SUZANNE SAINZ
COUNTY RECORDER
REQUEST OF :

DAVIS, JACK L.
DATE: 02/02/99 TIME: 9.30
FEE: 8.00
DOCK 785 PAGE 53 PAGES: 1

Space above this line for Recorder's use

NOTICE OF MINING CLAIM

DOCK 785 PAGE 53

- 1. TYPE OF NOTICE: Location Amendment Relocation
- 2. TYPE OF CLAIM: Placer Lode Millsite Tunnelsite

3. The name and address of the Locator is

Name: Manhattan Resources, Inc.

Address: 1256 W. Chandler Blvd., Suite 29

City/State/Zip Code: Chandler, Az. 85283

4. The name of the claim is Diablo No. 5

5. The date of the location is January 26, 1999

6. The claim is 1500 feet long and 600 feet wide. The distance from the location monument to each end of the claim is 1490 feet in a N. E. direction and 10 feet in a S. W. direction.

7. The general course of the claim is from the S. W. to the N. E.

8. The location of the claim is in Section 5 + 6, Township 21 S

Range 12 E

Gila & Salt River

Base and Meridian,

Tumacacori

Mining District, Santa Cruz

County,

State of Arizona.

9. If amending or relocating, the previous claim name was _____

recorded in Docket(Book) _____ page(s) _____

Mining District, _____

State of _____

10. The location of the claim with reference to a natural object or permanent monument is (See Map of _____)
Approximate location & alignment of the Diablo 1 - 9 Claim Group.

Dated: February 2, 1999

1999 FEB 4 11:47

RECEIVED B.L.M. AZ STATE OFFICE

Jack L. Davis, President

1256 W. Chandler Blvd., Suite 29

City/State/Zip
Chandler, Az. 85224

RECEIVED B.L.M. AZ STATE OFFICE
1999 FEB 3 11 17
PHOENIX, ARIZONA

T. 20 S.

SEC. 31

SEC. 32

RECEIVED
B.L.M. AZ STATE OFFICE,
1999 FEB - 3 A 11: 17
PHOENIX, ARIZONA

RECEIVED
B.L.M. AZ STATE OFFICE,
1999 FEB - 0 A 11: 47
PHOENIX, ARIZONA

SEC. 6

SEC. 5

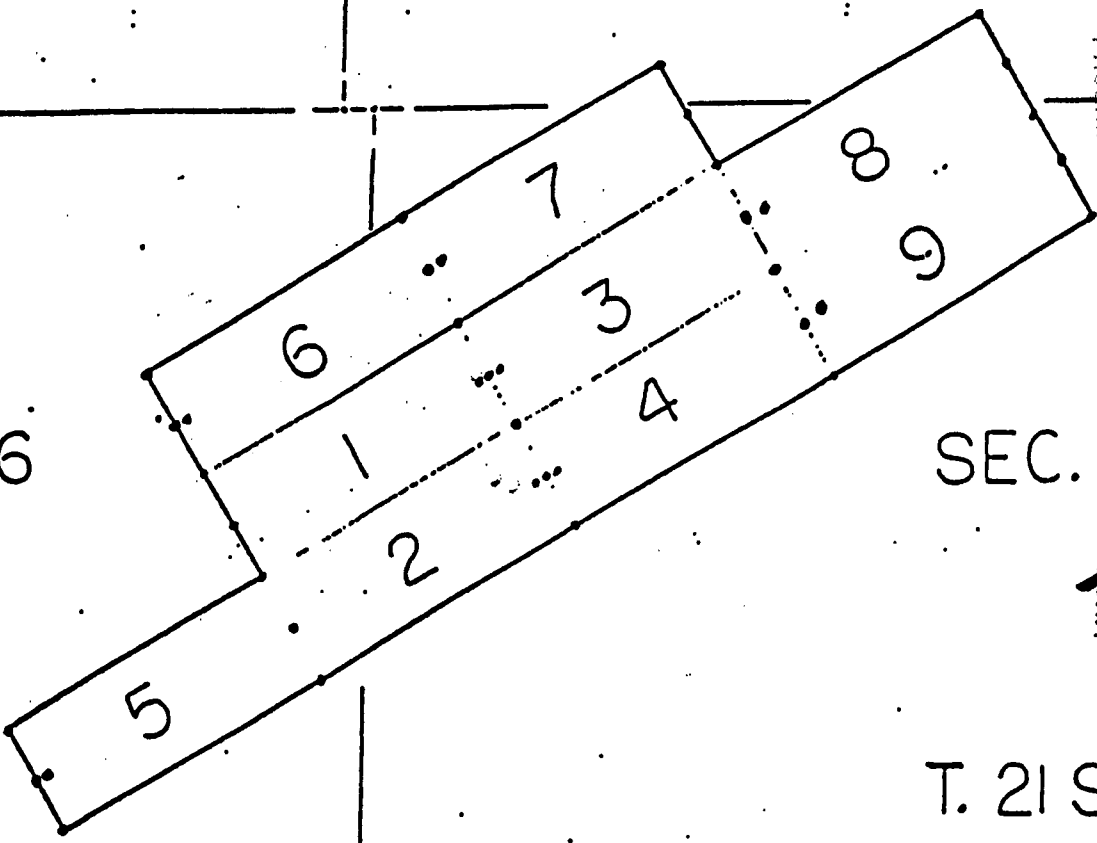

T. 21 S.

R. 12 E.

APPROXIMATE LOCATION AND ALIGNMENT
OF THE DIABLO 1-9 CLAIM GROUP.
SANTA CRUZ CO., ARIZONA

001229

When recorded, mail to:

Name: Jack L. Davis
Address: 1256 W/ Chandler Blvd., Suite 29
Chandler, Az. 85224
City/State/Zip Code: _____



INSTRUMENT #9901057
OFFICIAL RECORDS OF
SANTA CRUZ COUNTY
BUZANNE SAINZ
COUNTY RECORDER
REQUEST OF :
DAVIS, JACK L.
DATE: 02/02/99 TIME: 9.30
FEE: 8.00
DOCK 785 PAGE 54 PAGES: 1

Space above this line for Recorder's use

NOTICE OF MINING CLAIM

DOCK 785 PAGE 54

1. TYPE OF NOTICE: Location Amendment Relocation
2. TYPE OF CLAIM: Placer Lode Millsite Tunnelite
3. The name and address of the Locator is
Name: Manhattan Resources, Inc.
Address: 1256 W. Chandler Blvd., Suite 29
City/State/Zip Code: Chandler, Az. 85283
4. The name of the claim is Diablo No.6
5. The date of the location is January 26, 1999
6. The claim is 1500 feet long and 600 feet wide. The distance from the location monument to each end of the claim is 1490 feet in a N. E. direction and 10 feet in a S. W. direction.
7. The general course of the claim is from the S. W. to the N. E.
8. The location of the claim is in Section 5 + 6, Township 21 S, Range 12 E, Gila & Salt River Base and Meridian, Tumacacori Mining District, Santa Cruz County, State of Arizona.
9. If amending or relocating, the previous claim name was _____ recorded in Docket(Book) _____ page(s) _____ Mining District, _____ County, State of _____.
10. The location of the claim with reference to a natural object or permanent monument is (See Map of Approximate location & alignment of the Diablo 1 - 9 Claim Group.)

Dated: February 2, 1999

PHOENIX, ARIZONA

Jack L. Davis, President

1256 W. Chandler Blvd., Suite 29

Chandler, Az. 85224

B.L.M. AZ STATE OFFICE

B.L.M. AZ STATE OFFICE

FORM 111a

Page 1

T. 20 S.

SEC. 31

SEC. 32

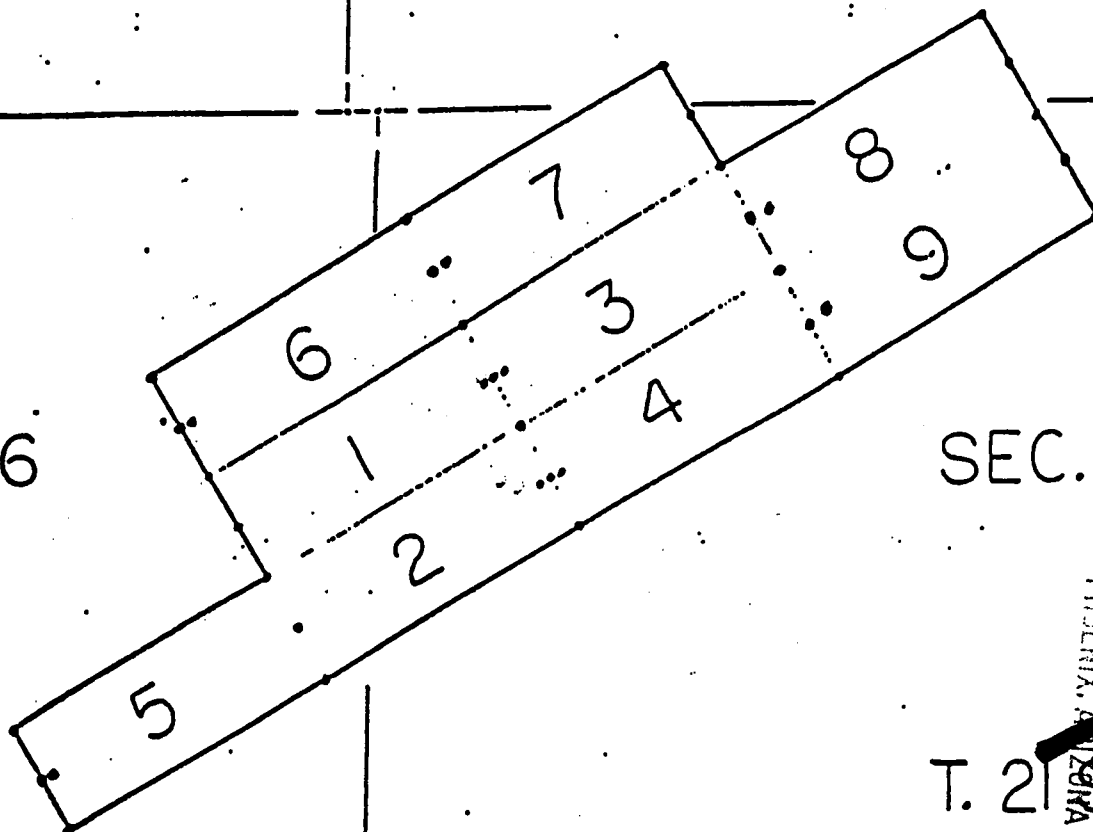

SEC. 6

SEC.

T. 20 S.

R. 12 E.

PHOENIX, ARIZONA

~~PHOENIX, ARIZONA~~

RECEIVED
B.L.M. AZ STATE OFFICE

1999 FEB -3 A 11: 17

~~RECEIVED
B.L.M. AZ STATE OFFICE~~

~~1999 FEB~~

~~A 11: 47~~

A MC 351229

APPROXIMATE LOCATION AND ALIGNMENT
OF THE DIABLO 1-9 CLAIM GROUP.
SANTA CRUZ CO., ARIZONA

When recorded, mail to:

Name: Jack L. Davis

Address: 1256 W! Chandler Blvd., Suite 29
Chandler, Az. 85224

City/State/Zip Code: _____



INSTRUMENT #990105B
 OFFICIAL RECORDS OF
 SANTA CRUZ COUNTY
 SUZANNE SAINZ
 COUNTY RECORDER
 REQUEST OF :
 DAVIS, JACK L.
 DATE: 02/02/99 TIME: 9.30
 FEE: 8.00
 DOCK 785 PAGE 55 PAGES: 1

Space above this line for Recorder's use

NOTICE OF MINING CLAIM

DOCK 785 PAGE 55

1. TYPE OF NOTICE: Location Amendment Relocation
2. TYPE OF CLAIM: Placer Lode Millsite Tunnelite
3. The name and address of the Locator is
 Name: Manhattan Resources, Inc.
 Address: 1256 W. Chandler Blvd., Suite 29
 City/State/Zip Code: Chandler, Az. 85283
4. The name of the claim is Diablo No. 7
5. The date of the location is January 26, 1999
6. The claim is 1500 feet long and 600 feet wide. The distance from the location monument to each end of the claim is 1490 feet in a N. E. direction and 10 feet in a S. W. direction.
7. The general course of the claim is from the S. W. to the N. E.
8. The location of the claim is in Section 5 Township 21 S + 20 S Range 12 E
Gila & Salt River Base and Meridian,
Tumacacori Mining District, Santa Cruz County,
 State of Arizona.
9. If amending or relocating, the previous claim name was _____
 recorded in Docket(Book) _____ page(s) _____
 Mining District, _____ County,
 State of _____
10. The location of the claim with reference to a natural object or permanent monument is (See Map of Approximate location & alignment of the Diablo 1 - 9 Claim Group.)

Dated: February 2, 1999 PHOENIX, ARIZONA

Jack L. Davis, President

1256 W. Chandler Blvd., Suite 29

Chandler, Az. 85224 City/State/Zip

RECEIVED B.L.M. AZ STATE OFFICE
 FEB 11 1999
 11:48 AM

T. 20 S.

SEC. 31

SEC. 32

PHOENIX, ARIZONA

1999 FEB - 3 A 11: 17

RECEIVED
B.L.M. AZ STATE OFFICE

SEC. 6

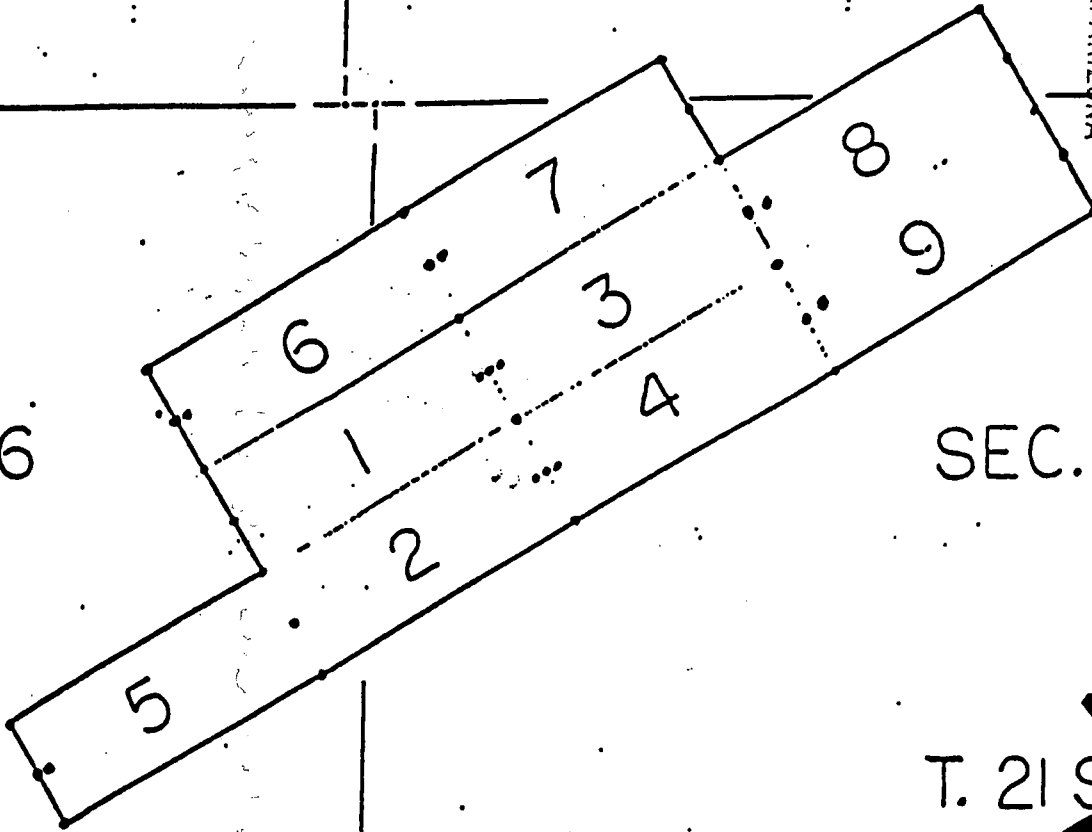

SEC. 5

T. 21 S.

R. 12 E.

PHOENIX, ARIZONA

1999 FEB - 11 A 11: 48

RECEIVED
B.L.M. AZ STATE OFFICE

A HC 351230

APPROXIMATE LOCATION AND ALIGNMENT
OF THE DIABLO 1-9 CLAIM GROUP.
SANTA CRUZ CO., ARIZONA

When recorded, mail to:

Name: Jack L. Davis

Address: 1256 W/ Chandler Blvd., Suite 29
Chandler, Az. 85224

City/State/Zip Code: _____



INSTRUMENT #9901059
OFFICIAL RECORDS OF
SANTA CRUZ COUNTY
SUZANNE BAINZ
COUNTY RECORDER
REQUEST OF :
DAVIS, JACK L.
DATE: 02/02/99 TIME: 9.30
FEE: 8.00
DOCK 785 PAGE 56 PAGES: 1

Space above this line for Recorder's use

NOTICE OF MINING CLAIM

DOCK 785 PAGE 56

1. TYPE OF NOTICE: Location Amendment Relocation
2. TYPE OF CLAIM: Placer Lode Millsite Tunnel-site
3. The name and address of the Locator is
 Name: Manhattan Resources, Inc.
 Address: 1256 W. Chandler Blvd., Suite 29
 City/State/Zip Code: Chandler, Az. 85283
4. The name of the claim is Diablo No. 8
5. The date of the location is January 26, 1999
6. The claim is 1500 feet long and 600 feet wide. The distance from the location monument to each end of the claim is 1490 feet in a N. E. direction and 10 feet in a S. W. direction.
7. The general course of the claim is from the S. W. to the N. E.
8. The location of the claim is in Section 5, Township S-32, Range 21 S + 20 S,
12 E,
Gila & Salt River Base and Meridian,
Tumacacori Mining District, Santa Cruz County,
 State of Arizona.
9. If amending or relocating, the previous claim name was _____
 recorded in Docket(Book) _____ page(s) _____
 Mining District, _____ County,
 State of _____.
10. The location of the claim with reference to a natural object or permanent monument is (See Map of _____)
 Approximate location & alignment of the Diablo 1 - 9 Claim Group.

Dated: February 2, 1999



Jack L. Davis, President

1256 W. Chandler Blvd., Suite 29

Chandler, Az. 85224

RECEIVED
 B.L.M. AZ STATE OFFICE
 FEB - 3 11:48 AM '99
 PHOENIX, ARIZONA 6661
 RECEIVED
 B.L.M. AZ STATE OFFICE

T. 20 S.

SEC. 31

SEC. 32

PHOENIX, ARIZONA

1999 FEB - 3 A 11:17

RECEIVED
B.L.M. AZ STATE OFFICE

SEC. 6

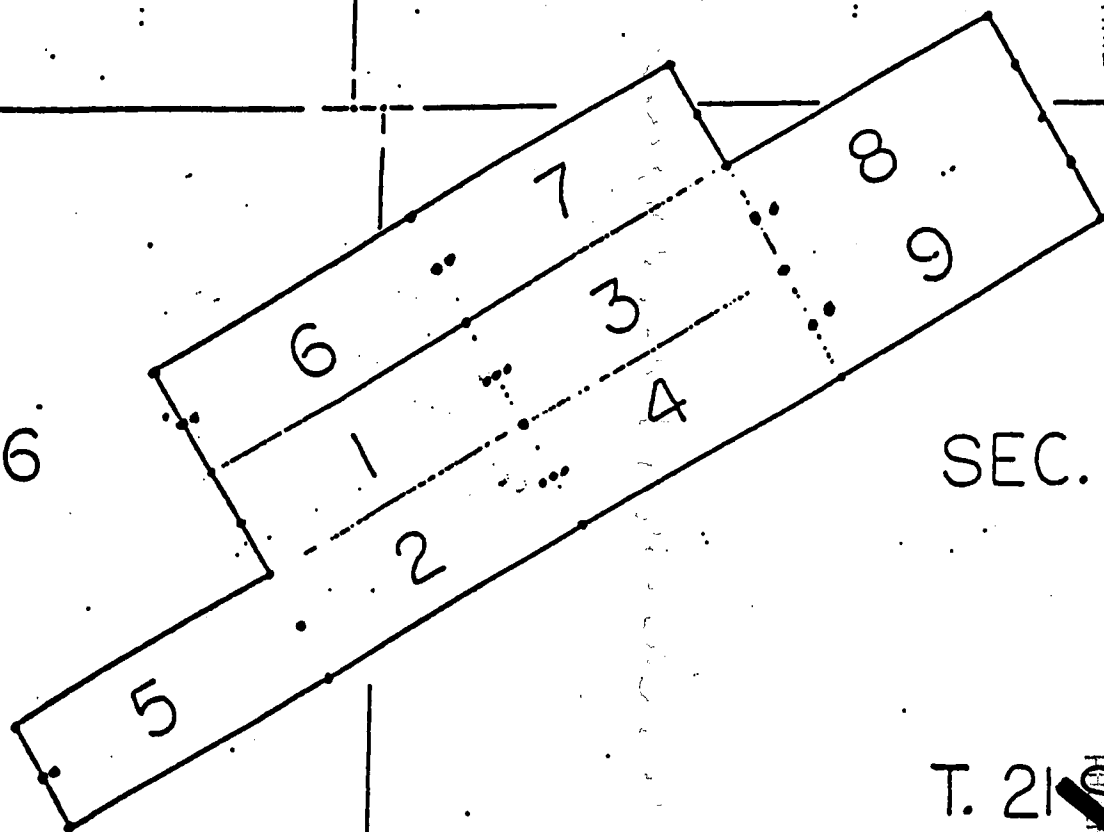

SEC. 5

T. 21 S.

PHOENIX, ARIZONA

1999 FEB - 11 A 11:48

RECEIVED
B.L.M. AZ STATE OFFICE

R. 12

APPROXIMATE LOCATION AND ALIGNMENT
OF THE DIABLO 1-9 CLAIM GROUP.
SANTA CRUZ CO., ARIZONA

A MC 351291

MANHATTAN RESOURCES, INC.
1256 W. Chandler Blvd., Suite 29
Chandler, Arizona 85224

February 23, 1999

Attn: MS. Courtney Davidson
Bureau of Land Management
222 N. Central Avenue
Phoenix, Arizona 85004

Re: Notice of Mining Claim: Diablo Claim #9, Dock 785 Page 5

Dear Ms. Davidson:

The information you requested regarding the Diablo Mining Claim held by Manhattan Resources, Inc., i.e. Diablo Claim #9, received at your office on February 4, 1999, is included herein.

If additional information is requested, please let me know.

Sincerely yours,

MANHATTAN RESOURCES, INC.

Louis E. McMahan
Secretary/Treasurer

ARIZONA
STATE OFFICE
PHOENIX, ARIZONA

FEB 24 9 58 PM 1999

RECEIVED
BUREAU OF
LAND MANAGEMENT

When recorded, mail to:

Name: Jack L. Davis
Address: 1256 W/ Chandler Blvd., Suite 29
Chandler, Az. 85224
City/State/Zip Code: _____

INSTRUMENT #7901060
OFFICIAL RECORDS OF
SANTA CRUZ COUNTY
SUZANNE BAINZ
COUNTY RECORDER
REQUEST OF :
DAVIS, JACK L.
DATE: 02/02/99 TIME: 9.30
FEE: 8.00
DOCK 785 PAGE 57 PAGES: 1

Space above this line for Recorder's use

NOTICE OF MINING CLAIM

DOCK 785 PAGE 57

1. TYPE OF NOTICE: Location Amendment Relocation
2. TYPE OF CLAIM: Placer Lode Millalite Tunnelalite
3. The name and address of the Locator is
Name: Manhattan Resources, Inc.
Address: 1256 W. Chandler Blvd., Suite 29
City/State/Zip Code: Chandler, Az. 85283
4. The name of the claim is Diablo No. 9
5. The date of the location is January 26, 1999
6. The claim is 1500 feet long and 600 feet wide. The distance from the location monument to each end of the claim is 1490 feet in a N. E. direction and 10 feet in a S. W. direction.
7. The general course of the claim is from the S. W. to the N. E.
8. The location of the claim is in Section 5, Township 21 S, Range 12 E, Gila & Salt River Base and Meridian, Tumacacori Mining District, Santa Cruz County, State of Arizona.
9. If amending or relocating, the previous claim name was _____ recorded in Docket(Book) _____ page(s) _____ Mining District, _____ County, State of _____.
10. The location of the claim with reference to a natural object or permanent monument is (See Map of _____)
Approximate location & alignment of the Diablo 1 - 9 Claim Group.

RECEIVED
 BUREAU OF
 LAND MANAGEMENT
 FEB 24 9 58 AM '99
 ARIZONA
 STATE DEPT OF
 MINES & RECLAMATION
 PHOENIX, ARIZONA

Dated: February 2, 1999
Jack L. Davis, President
1256 W. Chandler Blvd., Suite 29
Chandler, Az. 85224

A MC 351232

RECEIVED
BUREAU OF
LAND MANAGEMENT

FEB 24 9 58 PM '99

ARIZONA
STATE OFFICE
PHOENIX, ARIZONA

T. 20 S.

SEC. 31

SEC. 32

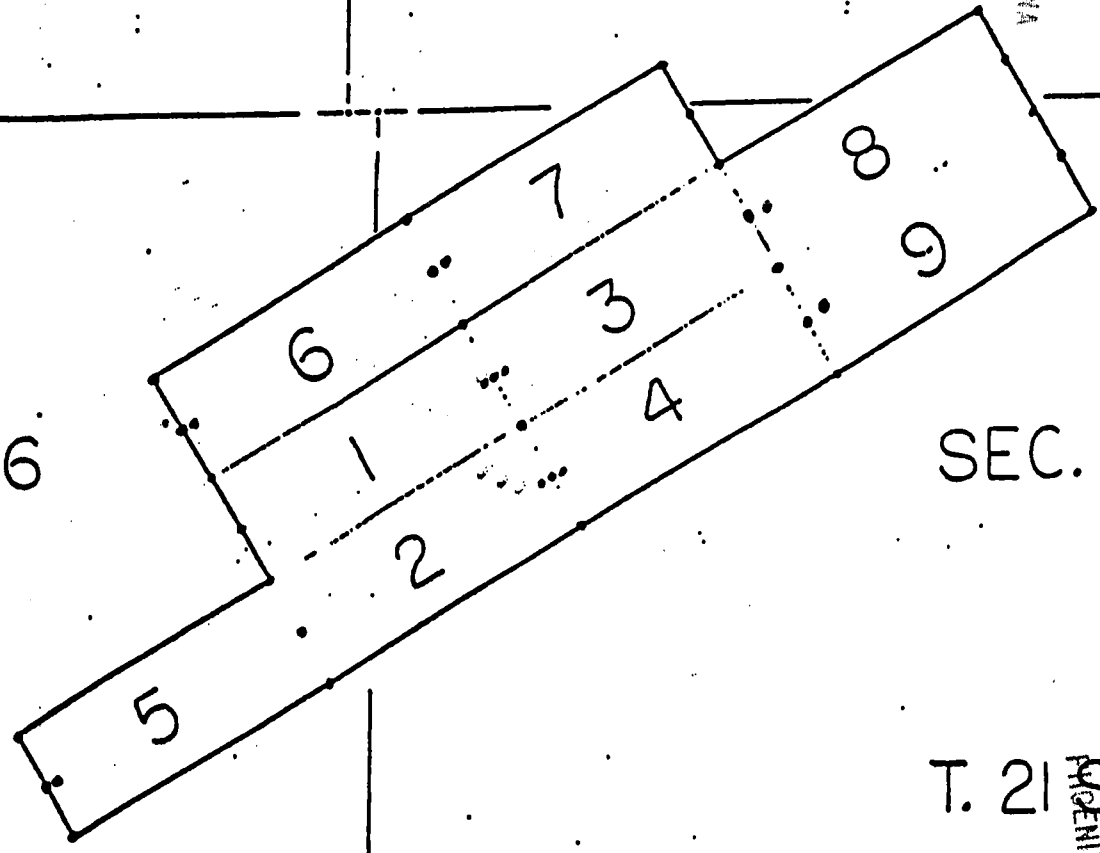

SEC. 6

SEC. 5

T. 21 S.

R. 12

ARIZONA
PHOENIX, ARIZONA

1999 FEB -4 A 11:48

RECEIVED
B.L.M. AZ STATE OFFICE

APPROXIMATE LOCATION AND ALIGNMENT
OF THE DIABLO 1-9 CLAIM GROUP.
SANTA CRUZ CO., ARIZONA

T. 20 S.

SEC. 31

SEC. 32

A MC 351232

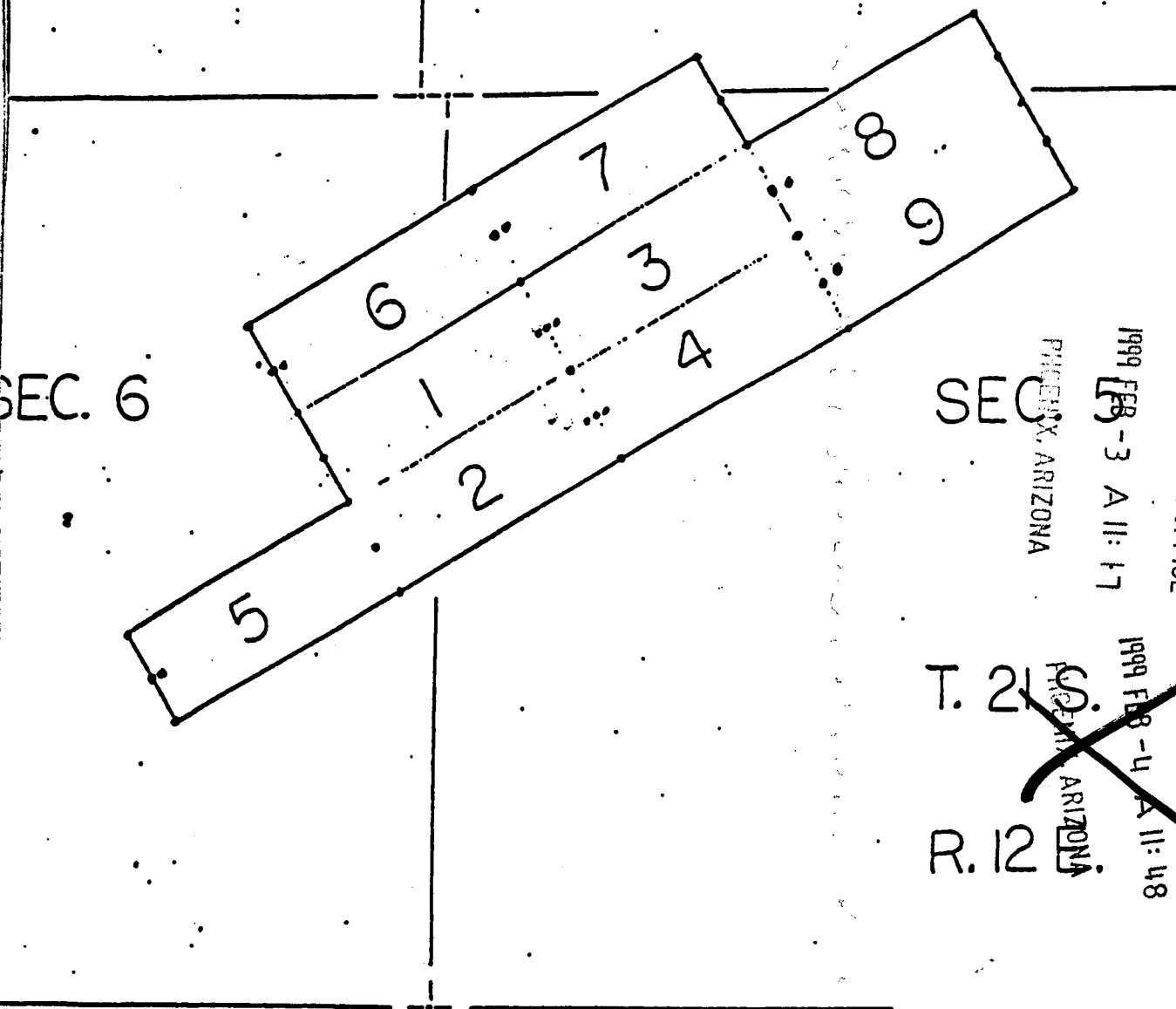

SEC. 6
PHOENIX, ARIZONA

RECEIVED
B.L.M. AZ STATE OFFICE
1999 FEB -3 A 11: 17

~~T. 21 S.
PHOENIX, ARIZONA~~

~~RECEIVED
B.L.M. AZ STATE OFFICE
1999 FEB -4 A 11: 48~~

R. 12

APPROXIMATE LOCATION AND ALIGNMENT
OF THE DIABLO 1-9 CLAIM GROUP.
SANTA CRUZ CO., ARIZONA



United States Department of the Interior

BUREAU OF LAND MANAGEMENT

Arizona State Office
222 North Central Avenue
Phoenix, AZ 85004-2203

In reply refer to:

AMC 351224 et al

February 11, 1999

Mr. Jack Davis
Manhattan Resources, Inc.
1256 West Chandler Boulevard
Suite 29
Chandler, Arizona 85283

Dear Mr. Davis:

Enclosed are corrected copies of your claims. They were erroneously date stamped February 4, 1999. The correct date of receipt was February 3, 1999.

I apologize for any inconvenience this may have caused.

Sincerely,

Courtney Davidson
Accounting Technician

Enclosures

KC

GEOGRAPHIC STATE: ARIZONA MERIDIAN: 14 TOWNSHIP: 21-05 RANGE: 12-0E

SEC	SUBDIVISION	MTR X-REFERENCE	NUMBER/TYPER/DISPOSITION/ACRES	PROPRIETOR/INTEREST/RELATIONSHIP
23	ALL		CASE: AZA 015626 TYPE: 311111 O&G LSE NONCOMP PUB DISP: CLOSED 03/01/85 ACRS: 00640.000	DRYX ENERGY CO 100.00000% LESSEE
6	S2NE, SENW, E2SW, SE		CASE: AZA 015692 TYPE: 311111 O&G LSE NONCOMP PUB DISP: CLOSED 04/23/91 ACRS: 02712.700	MGF OIL CORP 100.00000% LESSEE
6	LOT 1-8			
8	ALL			
10	ALL			
18	E2, E2W2			
18	LOT 1-4			
*03	S2N2, S2			
*03	LOT 1-4			
*04	S2N2, S2			
*04	LOT 1-4			
*05	S2N2, S2			
*05	LOT 1-4			
*06	ALL			
*07	E2, E2W2			
*07	LOT 1-4			
*09	ALL			
*15	ALL			
*16	ALL			
*17	ALL			
*19	E2, E2W2			
*19	LOT 1-4			
20	ALL		CASE: AZA 015693 TYPE: 311111 O&G LSE NONCOMP PUB DISP: CLOSED 04/23/91 ACRS: 02622.960	MGF OIL CORP 100.00000% LESSEE
31	E2, E2W2			
31	LOT 1-4			
33	ALL			
35	ALL			
*21	ALL			
*22	ALL			
*26	ALL			
*27	ALL			
*28	ALL			
*29	ALL			
*30	E2, E2W2			
*30	LOT 1-4			
*32	ALL			
*34	ALL			
1	SWNE, S2NW, SW, W2SE		CASE: AZA 018064 TYPE: 311211 O&G LSE SIMO PUBLIC DISP: CLOSED 01/06/83 ACRS: 04311.850	HARVEY M J JR 100.00000% APPLICANT
1	LOT 1,2,3,5,6,7			
11	ALL			
12	W2E2, W2			
12	LOT 1-4			
13	W2E2, W2			

* = REJECTED/SEGREGATED/ASSIGNED-OUT

GEOGRAPHIC STATE: ARIZONA MERIDIAN: 14 TOWNSHIP: 21-09 RANGE: 12-0E

SEC	SUBDIVISION	MTR X-REFERENCE	NUMBER/TYPE/DISPOSITION/ACRES	PROPRIETOR/INTEREST/RELATIONSHIP
13	LOT 1-4			
14	ALL			
24	W2E2, W2			
24	LOT 1-4			
25	W2, SE			
24	POR LOT 1		CASE: AZA 025510	WDC PARTNERSHIP 100.00000% PATENTEE
24	W2NE, NW		TYPE: 272011 SALE-SEC 209 MIN FL	
24	LOT 2		DISP: AUTHORIZED 12/07/93	
*24	POR LOT 1		ACRS: 00308.860	
24	NE		CASE: AZA 025511	WATER DEV CORP 100.00000% APPLICANT
			TYPE: 272011 SALE-SEC 209 MIN FL	
			DISP: CLOSED 03/24/92	
			ACRS: 00010.000	
23	E2NESW, NWNWNESE, N2NENWSE		CASE: AZA 028448	CLAPPER CAROL 100.00000% APPLICANT
23	W2NWSE		TYPE: 272011 SALE-SEC 209 MIN FL	
			DISP: CLOSED 05/20/94	
			ACRS: 00022.150	

* = REJECTED/SEGREGATED/ASSIGNED-OUT

GEOGRAPHIC STATE: ARIZONA MERIDIAN: 14 TOWNSHIP: 20-05 RANGE: 12-0E

SEC	SUBDIVISION	MTR	X-REFERENCE	NUMBER/TYPER/DISPOSITION/ACRES	PROPRIETOR/INTEREST/RELATIONSHIP
4	NESW, SWSE	14	19-05 12-0E	CASE: AZA 016941	DRYX ENERGY CO 100.00000% LESSEE
8	SWNW	14	20-05 11-0E	TYPE: 311111 O&G LSE NONCOMP PUB DISP: CLOSED 07/01/85 ACRS: 00240.000	
13	E2W2, SWSW	14	19-05 12-0E	CASE: AZA 018061	HARVEY M J JR 100.00000% APPLICANT
23	N2NE, SENE, NENW			TYPE: 311211 O&G LSE SIMO PUBLIC DISP: CLOSED 01/06/83 ACRS: 02670.050	
24	W2W2				
8	NE, E2NW, NWSW			CASE: AZA 018063	HARVEY M J JR 100.00000% APPLICANT
9	W2NE, SE			TYPE: 311211 O&G LSE SIMO PUBLIC DISP: CLOSED 02/08/83 ACRS: 01577.890	
18	E2SW, W2SE, NESE				
18	LOT 2,3,4				
25	NWNW				
28	S2SW, W2SE				
28	LOT 6,7				
33	W2NE				
33	LOT 1-4				

AZ-1274-4
(June 1987)

DEPARTMENT OF THE INTERIOR
BUREAU OF LAND MANAGEMENT
ARIZONA STATE OFFICE

EXAMINATION OF CASE FILE

A SEPARATE FORM MUST BE COMPLETED FOR EACH LEAD SERIAL NUMBER:

SERIAL NUMBER	TYPE OF CASE
351224	MINING CLAIM

I John C. Buethe HAVE READ AND UNDERSTOOD THE WARNINGS RELATIVE TO TITLE 18 U.S.C. 1001 AND 2071 PRINTED ON THIS FORM AND REQUEST TO EXAMINE THE CASE RECORD BEARING THE ABOVE SERIAL NUMBER OR NAME. I AGREE NOT TO REMOVE OR ALTER THE CONTENTS OF THIS FILE IN ANY MANNER WHATSOEVER AND NOT TO REMOVE THE FILE FROM THE ROOM DESIGNATED FOR PUBLIC EXAMINATION OF SUCH RECORDS.

NAME: <u>John Buethe</u>	DATE: <u>9/16/99</u>
ADDRESS: <u>550 W. Fug, Tucson 85704</u>	

(PLEASE PRINT INCLUDING ZIP CODE)

- WARNING -

Title 18 U.S. Code 1001. Statements or entries generally

Whoever, in any manner within the jurisdiction of any department or agency of the United States knowingly and willfully falsifies, conceals or covers up by any trick, scheme, or a device a material fact, or makes any false, fictitious or fraudulent statements or representations, or makes or uses any false writing or document knowing the same to contain any false, fictitious or fraudulent statement or entry, shall be fined not more than \$10,000 or imprisoned not more than five years, or both.

- Warning -

Title 18 U.S. Code 2071. Concealment, removal or mutilation generally

Whoever, willfully and unlawfully conceals, removes, mutilates, obliterates, or destroys, or attempts to do so, or, with intent to do so takes and carries away any record, proceeding, map book, paper, document, or other thing, filed or deposited with any clerk or officer of any court of the United States, or in any public office, or with any judicial or public officer of the United States, shall be fined not more than \$2,000 or imprisoned not more than three years.